

Info

A compact luminaire based sensor that utilises a passive infra-red detector (PIR), a photocell and an infra-red receiver for use with the infra-red handset

- Regulating photocell ensures minimum maintained light level taking into account the contribution from adjacent luminaires and daylight
- Presence detection
- Programmable using separate programming handset; see COM8HP
- Maximum mounting height 16 metres, see table below
- Typical applications include low and high bay installations
- On site commissioning is required, consult Whitecroft Controls desk, or refer to mode table on COM8HP datasheet

Order Codes

COM8 DALI addressable PIR luminaire-integrated detector is supplied within a luminaire and not individually. To specify this product within a luminaire please consult our Technical Desk.



Aerial LED Twin with COM8

Dimensions

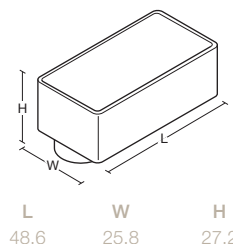

Movement sensor

The detection area for the movement sensor can be roughly divided into three parts:

- Minor movement (person \leq moving 0.9m/s)
Ø 3.0m at 10m height
- Major movement (person \leq moving 0.9m/s)
Ø 14.0m at 13m height
- Extra large movement (forklift and alike)
Ø 16.0m at 15m height

h	r1	α	r2	α	r3	α
5	2.5	25	3	30	3	30
7	3.5	27	4	30	4	30
10	1.5	8	6	30	6	30
13	x	x	7	27	7	27
15	x	x	x	x	8	27

Accessories (see Whitecroft website)

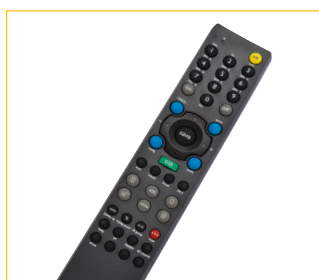

COM8HP Programming Handset

