

CKPED Pedestal Mount CONVERSION KIT

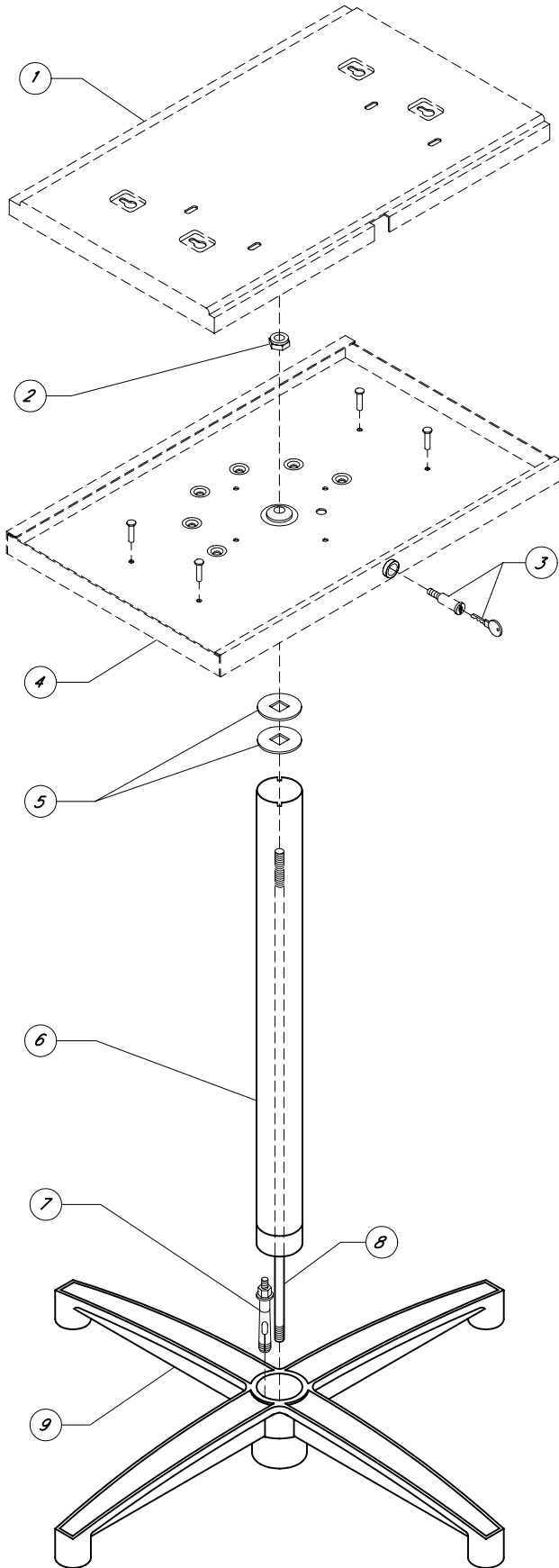

1. Determine location for installation of pedestal mount. Verify sufficient clearance from walls and other furniture to permit mounting plate and monitor to swivel when installed.
2. Use off-center hole in pedestal base (#9) to mark location for drilling into floor.
3. If installation is into concrete floor, drill 1/2" x 2-1/2" deep hole into floor. Insert anchor bolt (#7) into hole and tighten nut to secure anchor bolt in place. Remove nut from anchor bolt. Place pedestal base over protruding thread of anchor bolt, slipping bolt through off-center hole in pedestal base. Replace nut on anchor bolt and securely tighten.
4. If installation is into wood floor, drill pilot hole for provided lag bolt (not shown). Place two washers on lag bolt and insert bolt through off-center hole in pedestal base. Screw lag bolt into floor.
5. Screw 1/2" diameter rod (#8) into threaded hole in pedestal base.
6. Place 2" diameter tube (#6) over threaded rod and into pedestal base. If necessary, place a piece of wood over top of tubing and tap wood firmly with a hammer to force bottom of tube into pedestal base.
7. Place two 2-1/8" washers (#5) over threaded rod. Seat washers evenly on recessed ring in top of tube. Verify that a minimum of 7/8" of threaded rod is protruding through the washers.
8. Place lower plate (#4) on pedestal tube (#6), slipping threaded rod through hole in center of plate. Rotate plate until nodules on swivel plate on underside of lower plate slip into notches in top of tube. Place 1/2-13 nylon lock nut (#2) on threaded rod and securely tighten.
9. Invert monitor. Position inverted upper plate (#1) on underside of monitor with lock slot facing front of monitor. Attach monitor to upper plate with fasteners appropriate to the underside of the monitor.
10. Turn monitor right side up. Place upper plate on lower plate, guiding rear of upper plate beneath lip at back of lower plate. Slip upper plate into lower plate and pull forward until front of upper plate meets front of lower plate.
11. Place key in lock (#3) and insert lock into lock retainer. Turn key clockwise to screw lock into plate. Remove key.