



**PHTM200 - Phantom 200** Wafer Thin Profile Wall Mount  
for Flat Screens up to 50lbs  
with 200mm VESA<sup>®</sup> Mounting Patterns

The **PHTM200** wall mount attaches to 20"-65" flat screens up to 50lbs with 200mm mounting patterns. The wafer thin profile of the **Phantom 200** mount projects from the wall less than 5/8". Security for the flat screen is provided with a discrete proprietary locking mechanism. Wood lag screws & toggle bolts are provided for quick and easy installation.

**Features:**

Gloss black baked on powder coat finish

Fits 20"-65" flat screens with 200mm x 200mm & 200mm x 100mm VESA<sup>®</sup> mounting patterns

Security screw provided to join wall plate to the screen mounting plate for discrete flat screen security.

Open wall plate allows for electrical and A/V junction boxes behind the monitor.

Gap between plates and plastic edge protector allow for very clean looking wiring in the wall.

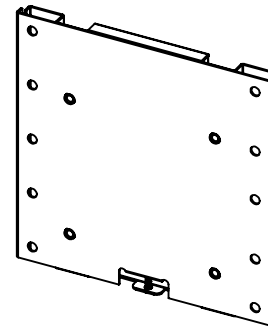
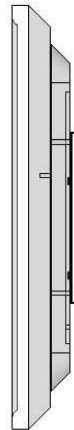
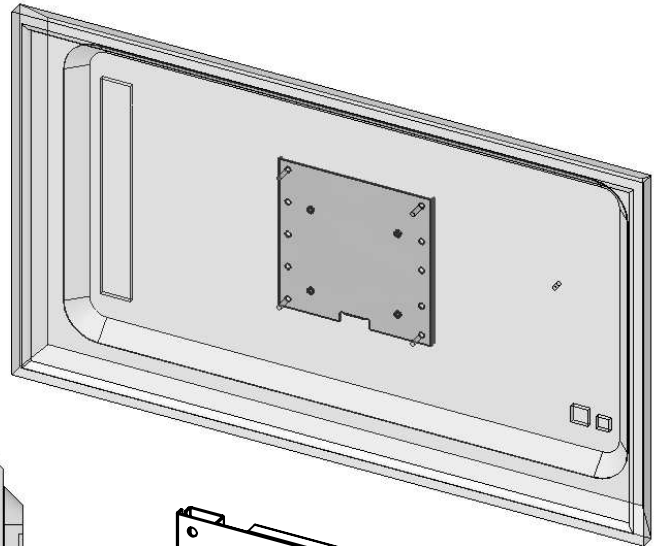

PHTM200 QR Code  
Link to Web Page

**Optional Accessories:**

- WMATB2** - Metal Stud Toggle Bolt Kit
- WMAAB4** - Concrete Anchor Bolt Kit

**Maximum Load Limit:**

50lbs (22.7kg)

**Product Weight:**

3.0lbs (1.4kg)

**Shipping Weight:**

3.5lbs (1.6kg) or 10 Pack- 35lbs (15.9kg)

**Carton Dimensions:**

12.5"L x 9.5"W x 1.5"H (16"H for 10 Pack)

Architectural Specification: The Wafer Thin Profile Wall Mount shall be Lucasey model **PHTM200** and shall be located where indicated on the plans. It shall feature monitor attaching plates included compatible with VESA 200mm x 200mm, & 200mm x 100mm. Assembly and installation shall be done according to instructions provided by the manufacturer.



**Front View**

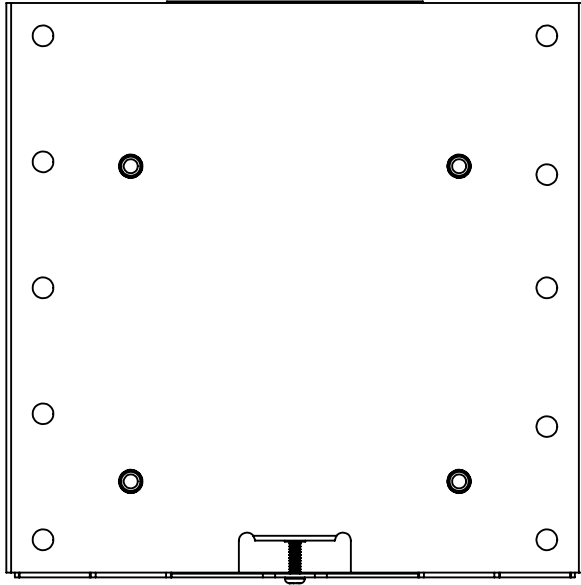

**Wall Plate**

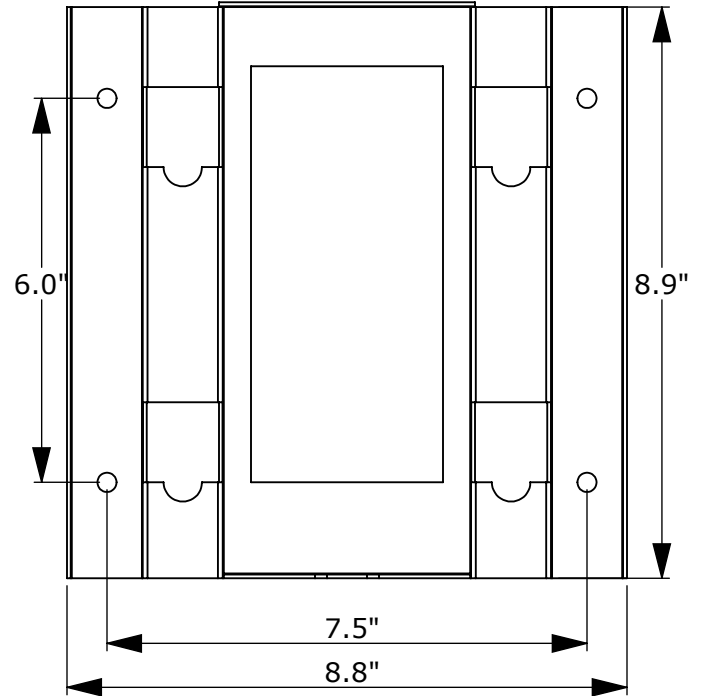

**VESA Mounting Plate**

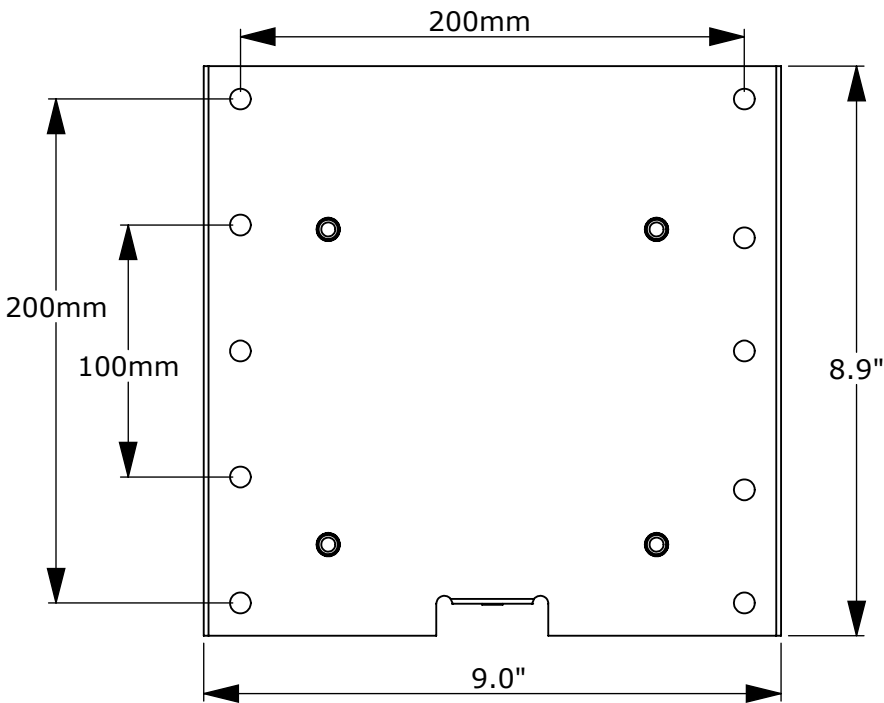

**Side View**

