



LC200CFA Furniture & Ceiling Mount with Articulation for Flat Screens up to 35lbs with 100mm or 200mm Mounting Patterns

The LC200CFA furniture & ceiling mount with articulation, pivot and tilt fits monitors that weigh less than 35lbs and uses a 100mm x 100mm, 200mm x 100mm or 200mm x 200mm VESA[®] mounting pattern. Mounts to wood or concrete using the provided round flange. Wood lag screws are provided and concrete anchors can be ordered separately. The articulation provides a useful mounting solution for alcoves where the flat screen needs to be mounted with the flange inside the alcove, the screen attached outside the alcove and then pushed back into the best viewing position. The mount also works well on counter tops when the user wants to pull the screen closer for viewing and then push back into a home position.

Features:

Gloss black finish

Fits from flat screens up to 35lbs

Universal mounting pattern fits 75mm, 100mm & 200mm VESA compatible monitors

Multiple holes every 12.5mm for 100mm or 200mm height adjustability.

4mm, 5mm & 6mm monitor attaching hardware screws and studs are included

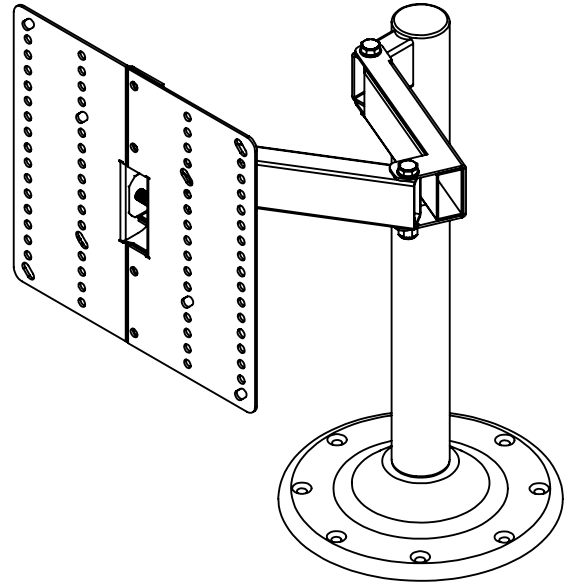

Maximum Load Limit:

35.0lbs (15.9kg)

Product Weight:

12.5lbs (5.7kg)

Shipping Weight:

14lbs (6.4kg)

Carton Dimensions:

18"L x 14"W x 8"H

Optional Accessories:

LCAPDVD - Adapter for hanging DVDs, DVRs and other equipment below the flat screen

Architectural Specification: The Furniture or Ceiling Mount shall be Lucasey model LC200CFA and shall be located where indicated on the plans. It shall feature monitor attaching plates included compatible with VESA 100mm and 200mm mounting patterns. Assembly and installation shall be done according to instructions provided by the manufacturer.



Round Flange

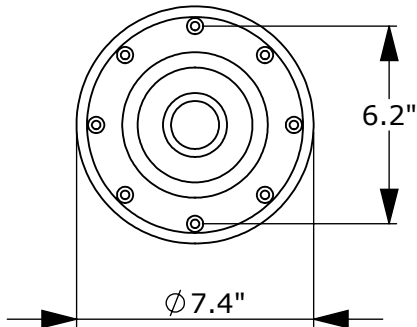

Top Views

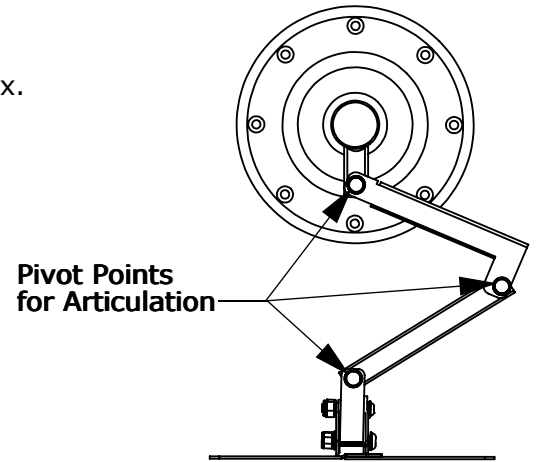
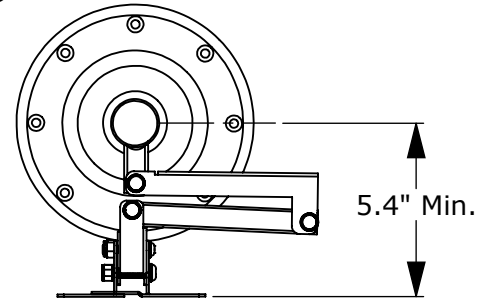
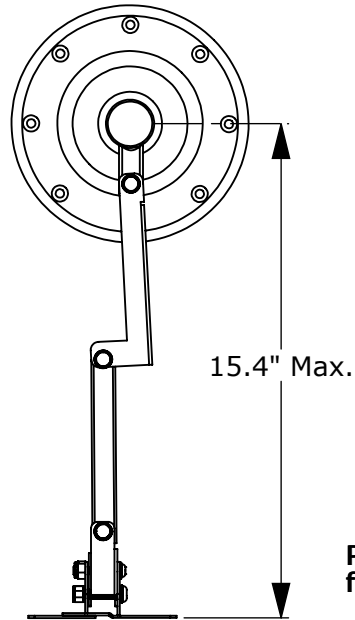

Front View

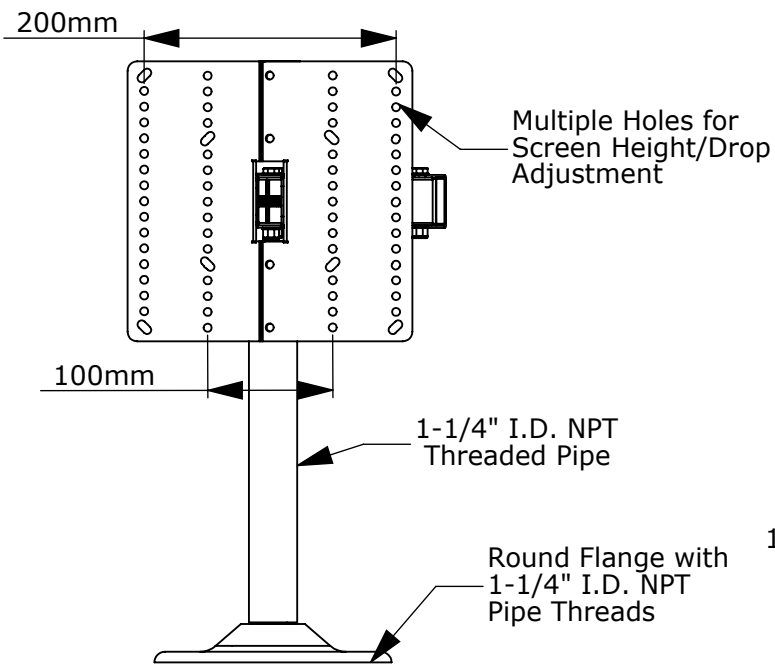

Side View

