



CleanBlast™ System—Portable

Advanced Fiber Optic Connector End-Face Cleaning System

CleanBlast System

The patented JDSU CleanBlast fiber end-face cleaning systems provide a fast, effective, and cost-efficient solution for removing dirt and debris from connectors in most common applications. CleanBlast is a non-contact system that uses a highly filtered stream of pressurized gas with a vacuum circuit to create a high-flow-rate jet across the fiber's surface. A 30- μ l cleaning solvent is injected into the airflow, and the contamination from the end face along with the solvent are then removed through the retrieval circuit. The precise, highly efficient non-contact *air-solvent-air* stream blasts and removes contamination with nearly 100-percent effectiveness.

Non-Contact Cleaning Illustration

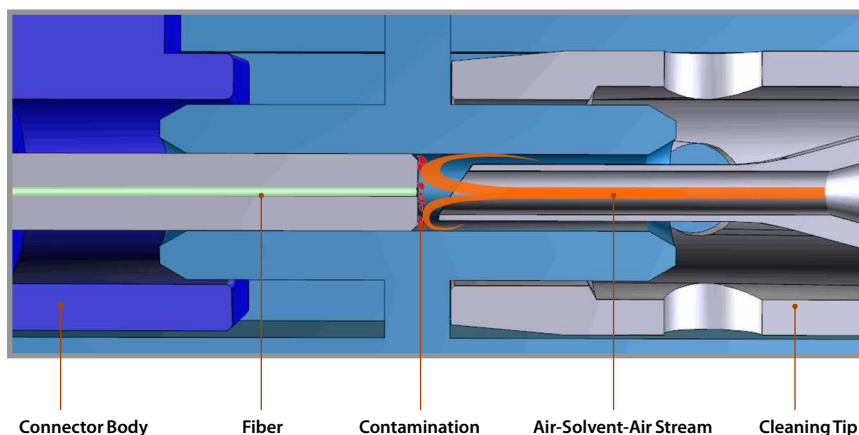

Key Benefits

- Fast, repeatable, more effective, and more cost-efficient per clean than other cleaning methods
- Eliminates user sensitivity and error
- Removes, rather than spreading or smearing, loose debris from fiber end faces at the push of a button
- Input for optional FBP probe microscope and LCD enable fiber inspection capability

Key Features

- Provides rapid, controlled, and repeatable cleaning and removal of contamination from fiber end faces
- Uses a precise non-contact air-solvent-air mixture/sequence to blast and remove contamination particles
- Cleans faster, more effectively, and more economically per clean than conventional methods
- Offers a comprehensive selection of precision cleaning tips and adapters
- Input for optional FBP probe microscope and 6.4-inch LCD display for fiber inspection capability

Applications

- Clean various types of both male (patch cord) and female (bulkhead) connector ends, including SC, FC, LC, ST, E2000, MPO, MTP®, MPX, MT, and SMA
- Quickly and easily remove contamination, dust, lint, oil, and other forms of debris from fiber optic end faces
- Clean multiple configurations and connector types with interchangeable precision cleaning tips and adapters

Overview

JDSU portable CleanBlast systems include a mobile base unit (built-in compressor) housed in a durable, rugged Pelican™ transport case with a handset connected to a 5-ft umbilical for optimal reach. Precision cleaning tips are available for both male (patch cord) and female (bulkhead) connectors for various connector types, including SC, LC, FC, ST, E2000, MPO, MPX, MT, and SMA. All models include an input port for a separate probe microscope for fiber inspection capabilities, and a video output for connecting to an external monitor or to a mounted liquid crystal display (LCD).

The system's cleaning solvent reservoir holds enough solution for at least 8,000 cleaning cycles. The solvent refill process is simple and spill-resistant. A built-in safety feature prevents the handset from accidentally triggering the system. It also monitors solvent levels and the safety switch, and it features a series of light-emitting diodes (LEDs) to indicate system status.

FCLT Cleaning Tips

JDSU offers a complete selection of precision cleaning tips and adapters for every connector and application, including SC, FC, ST, LC, MU, E2000, and MPO/MTP connectors.

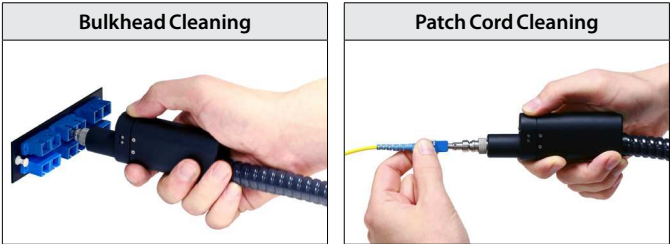

CleanBlast vs. Traditional Swab/Stick

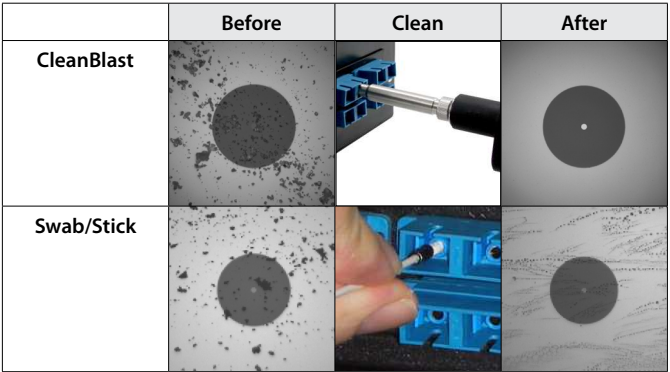

Components and Functions



CleanBlast System—portable with FBP probe and LCD



Specifications

Parameter	Description
CleanBlast—Portable	
Dimensions	16 x 13 x 7 in (40 x 33 x 18 cm)
Weight	21 lb (9.5 kg)
Power requirements	100–240 V AC, 2 A
Air source	Internal compressor, regulated output 40 psi.
Solvent consumption	At least 8,000 cleaning cycles per refill
Maintenance	50,000 cycles per air filter change, requires 2 x 0.01 µ air filters (included and installed)
Video output	BNC or DIN connector to optional LCD
Cleaning cycle time	5 s

Ordering Information

Description	Part Number
CleanBlast Systems	
CleanBlast portable kit with dual-magnification (200/400X) FBP probe microscope, TFT LCD, 8 FBPT inspection tips (SC, SC-APC, FC, ST, LC bulkhead tips, and universal 2.5 mm UPC, 2.5 mm APC, 1.25 mm UPC patch cord tips), and 4 cleaning tips and adapters (universal 2.5 mm, 1.25 mm and 2.5 mm bulkhead tips, and 1.25 mm patch cord mating adapters)	FCL-P1005
CleanBlast portable kit with EU power supply, dual-magnification (200/400X) FBP probe microscope, 6.4-in TFT LCD, with 8 FBPT inspection tips (SC, SC-APC, FC, ST, LC bulkhead tips and universal 2.5 mm and 1.25 mm UPC, and 2.5 mm APC patch cord tips), 4 cleaning tips and adapters (universal 2.5 mm, 1.25 mm and 2.5 mm bulkhead tips, and 1.25 mm patch cord mating adapters)	FCL-P1005-EU
CleanBlast—portable with 5-ft umbilical bulkhead handset with universal 2.5 mm cleaning tip	FCL-P1000
CleanBlast—portable with 5-ft umbilical bulkhead handset with universal 2.5 mm cleaning tip and EU power supply	FCL-P1000-EU
CleanBlast—portable with 5-ft umbilical and 90 degree bulkhead handset with universal 2.5 mm cleaning tip	FCL-P2000
CleanBlast—portable with 5-ft umbilical and backplane handset with universal 2.5 mm cleaning tip	FCL-P6000

Description		Part Number
Inspection Parts*		
Bulkhead inspection tips	SC bulkhead (for FBP probe)	FBPT-SC
	SC-APC bulkhead (for FBP probe)	FBPT-SC-APC
	LC bulkhead (for FBP probe)	FBPT-LC
	LC long-reach bulkhead (for FBP probe)	FBPT-LC-L
	LC-APC bulkhead (for FBP probe)	FBPT-LC-APC
	FC bulkhead (for FBP probe)	FBPT-FC
	FC-APC bulkhead (for FBP probe)	FBPT-FC-APC
	ST bulkhead (for FBP probe)	FBPT-ST
	MTP bulkhead long reach (for FBP probe)	FBPT-MTP-L
MTP-APC polish bulkhead long reach (for FBP probe)	FBPT-MTPA-L	
Patch cord inspection tips	Universal 2.5 mm (for FBP probe)	FBPT-U25MA
	Universal 1.25 mm (APC polish slip fit) (for FBP probe)	FBPT-U12MA-SF
Cleaning tips	Universal 2.5 mm bulkhead (for CleanBlast)	FCLT-U25
	Universal 2.5 mm patch cord mating adapter	FCLT-U25MA
	Universal 1.25 mm bulkhead (for CleanBlast)	FCLT-U12
	Universal 1.25 mm patch cord mating adapter	FCLT-U12MA
	MTP/MPO bulkhead (for CleanBlast)	FCLT-MTP
	MTP patch cord mating adapter	FCLT-MTP-MA
Replacement parts	Internal air filter; 0.01 U 0.125 inch NPTF	FCLP-FA-F1
	Bottle cap refill assembly	FCLP-RCA-1
	Solvent refill; 3M HFE-72DA; 8 oz, 225 ml	FCLP-SOL1
	Solvent refill 6-pack; 3M HFE-72DA; 8 oz, 225 ml	FCLP-SOL6
	LCD video display with mounting bracket and base	VM-LCD-6

*JDSU has over 300 tips, patch cords, and adapters available for inspecting and cleaning different fiber optic connectors for a variety of different applications. This is not an all-inclusive list, but solutions for the most common connectors and applications. Please contact JDSU for more information.



North America
Latin America
Asia Pacific
EMEA

Toll Free: 1 855 ASK-JDSU
Tel: +1 954 688 5660
Tel: +852 2892 0990
Tel: +49 7121 86 2222

(1 855 275-5378)
Fax: +1 954 345 4668
Fax: +852 2892 0770
Fax: +49 7121 86 1222