

1

2

3

4

5

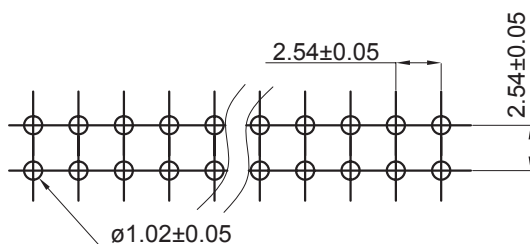
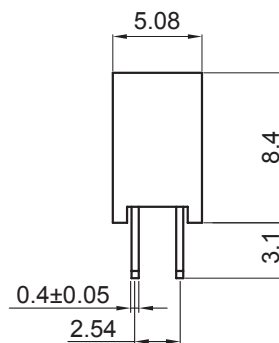
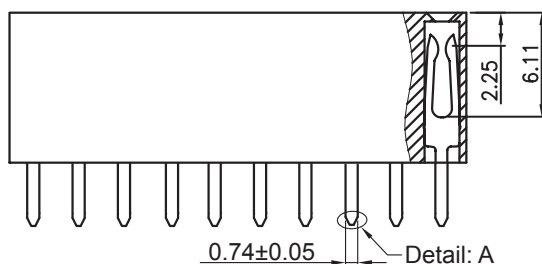
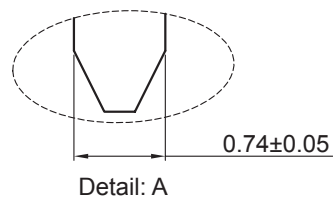
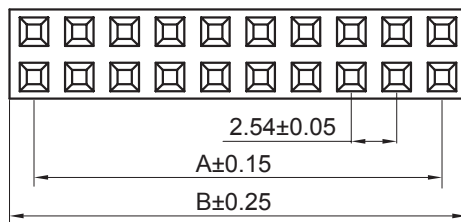

PCB LAYOUT - COMPONENT VIEW

TECHNICAL CHARACTERISTICS

MATERIAL

INSULATOR: PBT
 COLOR: BLACK
 CONTACT MATERIAL: COPPER ALLOY
 CONTACT TYPE: STAMPED
 CONTACT PLATING: GOLD
 QUALITY CLASS: 3 AS PER CECC 75 301-802
 PITCH: 2.54MM

ENVIRONMENTAL

OPERATING TEMPERATURE: -40 UP TO 125°C
 FLAMABILITY RATING: UL94-V0
 COMPLIANCE: LEAD FREE AND ROHS

ELECTRICAL

CURRENT RATING: 3A
 WORKING VOLTAGE: 250V AC
 INSULATOR RESISTANCE: >1000 mOHM
 DIELECTRIC WITHSTANDING VOLTAGE: 500V AC/MN
 CONTACT RESISTANCE: 20 mOHM MAX

STANDARD

Ⓢ CERTIFIED: E323964 / MODEL N° 613-218

SOLDERING

WAVE PROCESS ONLY

PACKAGING

TRAY

DIMENSION

A= 2.54 x (NB. PIN / 2-1)
 B= 2.54 x (NB. PIN / 2) + 0.5

RoHS Compliant

PROJECTION:

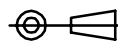

GENERAL TOLERANCE

.X = +/- 0.2

.XX = +/- 0.15



APPROVAL: RJ

UNIT: MM

DESCRIPTION: 2.54MM DUAL SOCKET HEADER

SIZE

SCALE:

WERI PART NO: 613 0xx 218 21

A4

SHEET: 1/2

DRAW: PEARL

| | | | |
|-----|-----------|-----------|----|
| REV | DATE | FILE | BY |
| I | 28-AUG-14 | DIMENSION | AS |
| H | 08-APR-13 | DIMENSION | AR |