

# Thank You from NeuTab

Congratulations! Your NeuTab tablet is here in your hand. This guide is provided to help you get started quickly with your tablet; please read it carefully and save it for future reference.

Need detailed instructions, up-to-date information, and helpful tips? You can find those and much more interesting information at [www.neutab.us](http://www.neutab.us)

## Features

### **Web browsing**

Visit your favorite websites

### **E-mailing**

Set-up your email

### **Video watching**

YouTube application pre-installed

### **Book reading**

Download thousands of books with the included Google reader, Google books

### **Google Play Store**

Games, applications, and more with the installed marketplace

### **Wireless internet**

High-speed Wi-Fi 802.11 b/g/n networking

### **Entertainment all the way**

Portable powerhouse plays popular music, video, and photo formats

### **Expand your tablet capacity**

Micro-SD card slot supports up to 32GB card.

### **Built-in camera**

Designed for video chatting

## Package Contents

This package includes your tablet and basic accessories. Please contact us at [contactus@neutab.us](mailto:contactus@neutab.us) if you find one or more items missing.

NeuTab Tablet

USB cable

Power adapter

Tips: This manual is available for download from the NeuTab website as a PDF file.

Warning: This package may contain plastic bags or other materials that pose a hazard to children. Be sure to safely dispose of all packing materials after opening.

## Getting to know your tablet

(The location of different buttons and other components are subject to change, please refer to the icon or text for identification)

Power button

Camera

Volume +/-

Micro SD card slot

Speaker

Power jack

Headphone jack

Micro USB port

Reset/Restart key

HDMI Output

Tips: Please refer to the **icon** on tablet to find those buttons/ports)

## About the Touchscreen

Your tablet comes equipped with an easy-to-use touchscreen. Our capacitive multi-touchscreen requires gentle fingertip touch on the glass screen to activate tablet's functions. Multiple fingers may be used to perform gestures (e.g. 2-finger picture zoom).

Please note: Your fingertips must not be covered. A stylus may be used. Make sure it is designed for capacitive touchscreens.

Tips: To avoid damaging the screen, do not touch it with excessive force or with any object other than your finger. For best response, make sure your hands are clean before using the touchscreen controls.

### ***Protective Film***

A thin film has been applied to the touchscreen to protect it during shipping. The protective film should be removed before use. To remove it, simply take a corner of the film and peel it away from the screen.

## Charging the Tablet

Your NeuTab tablet comes with a built-in rechargeable lithium polymer battery.

**Before 1<sup>st</sup> time using the tablet, the battery should be charged fully to extend future battery life.**

To charge the battery:

1. Plug one end of the included power adapter into an AC 100-240V outlet.
2. Plug the other end of the included power adapter into the Power jack on the tablet.
3. Disconnect the power adapter when the tablet is fully charged.

Warning: The battery used in this device may present a fire or chemical burn if mistreated. Do not disassemble, incinerate, or heat the device. Do not leave the device in a place subject to direct sunlight, or in a car with its windows closed. Do not connect the device to a power source other than that which is indicated here or on the label as this may result in the risk of fire or

electric shock.

## Resetting/Restarting the Tablet

Reset the tablet if it should freeze and not respond or otherwise malfunction.

1. Disconnect your tablet if it is connected to a computer.
2. Press and hold the **POWER** key for about 10 seconds to turn off the tablet, and then press and hold the **POWER** key until you see NeuTab logo.

# Getting Started

## Turning the Tablet on and off

To turn the tablet on:

- Press and hold the **Power** key until the LCD screen turns on and you see NeuTab Logo, then wait until you see the Unlock screen.

To turn the tablet off:

1. Press and hold the **Power** key until the “turn tablet off” message appears.
2. Touch **OK** to turn off the tablet.

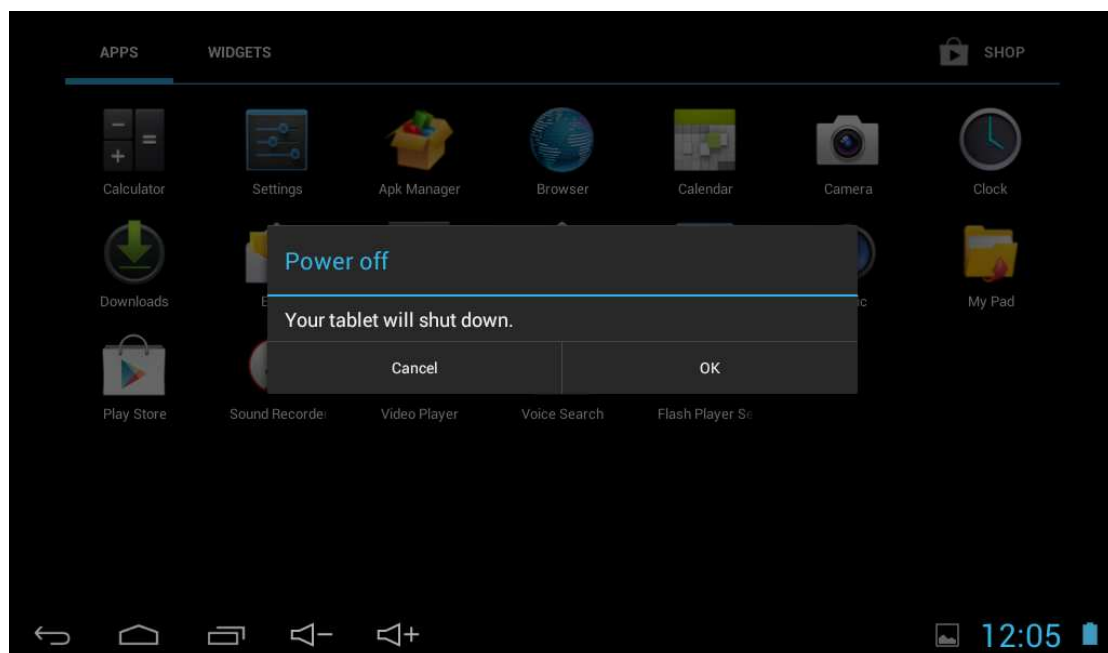

## Turning the Screen On and Off (Standby)

When the tablet is on, you can turn off the screen to conserve battery power. Simply press the **Power** key once to turn the screen off. Press the **Power** key again to turn the screen back on.

Tips: To conserve battery power, the screen can be set to turn off automatically when the tablet is

not in use (between 15 seconds and 30 minutes). This Sleep option can be found in the Display menu.

### *Unlocking the Screen*

When the screen turns off, you will have to unlock the screen when you turn it back on.  
To unlock the screen, touch and drag the **lock** icon to the edge of the circle that appears.

If a password has been set, enter the password to finish unlocking the screen. The Screen Unlock password can be set in the Security settings menu.

WARNING: Please write down your password lock pattern/PIN/Password. Misplacing or forgetting this method will lock the user out. Recovering the unit will reset the device back to factory defaults. **ALL YOUR DATA & PROGRAMSWILL BE LOST.**

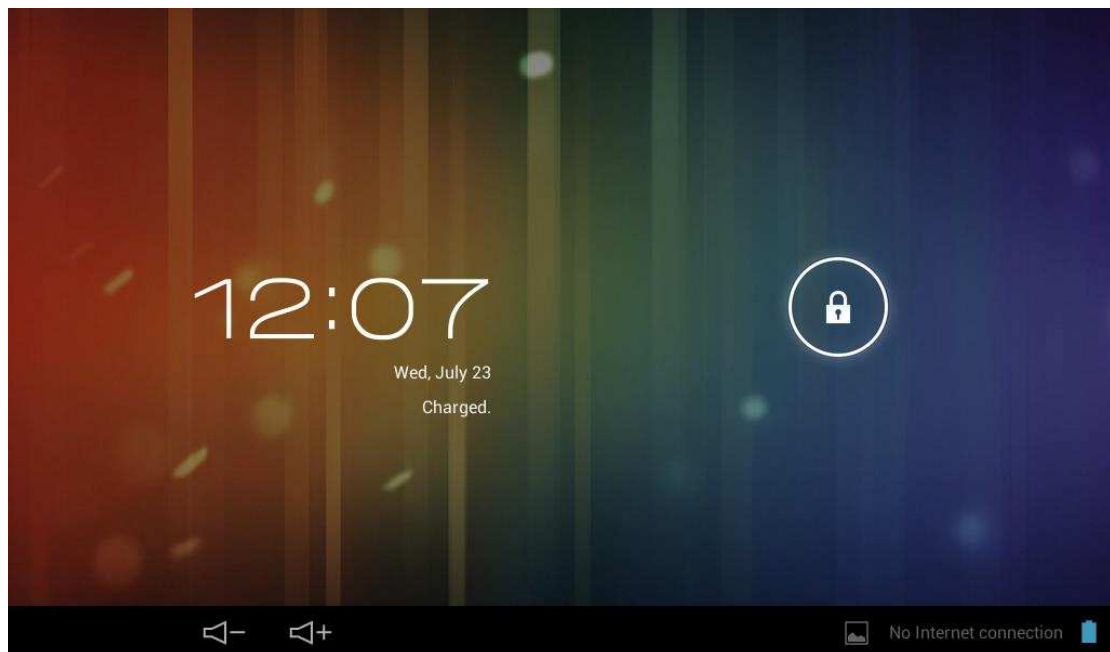

## Your Tablet Home Screen

The home screen is the starting point for all of the features of your tablet.



图片Screenshot\_2014-07-11-02-30-57

#### 1 Google Search

Touch to search with Google Search Engine.

#### 2 VOICE Search

Search by voice input.

#### 3 Home icon

Touch to back to the central Home Screen.

#### 4 Back icon

Touch to go back to the previous screen.

#### 5 Recent Apps

Touch to display the list of thumbnails of apps you have worked recently. Touch a thumbnail to open it.

#### 6 Applications Tab

Open the Application Launcher to view the list of all Applications and Widgets installed on the tablet. Touch the applications tab to open the Launcher.

#### 7 Icons

Touch an icon to open an application or application folder.

#### 8 Notification bar

Shows notification icons and time, battery level, plus the network signal strength; touch the bar to open the full Notifications panel. Touch a Notification icon to display more detail.

## Default Applications

To open an application, touch the application icon on the home screen or in the applications menu.

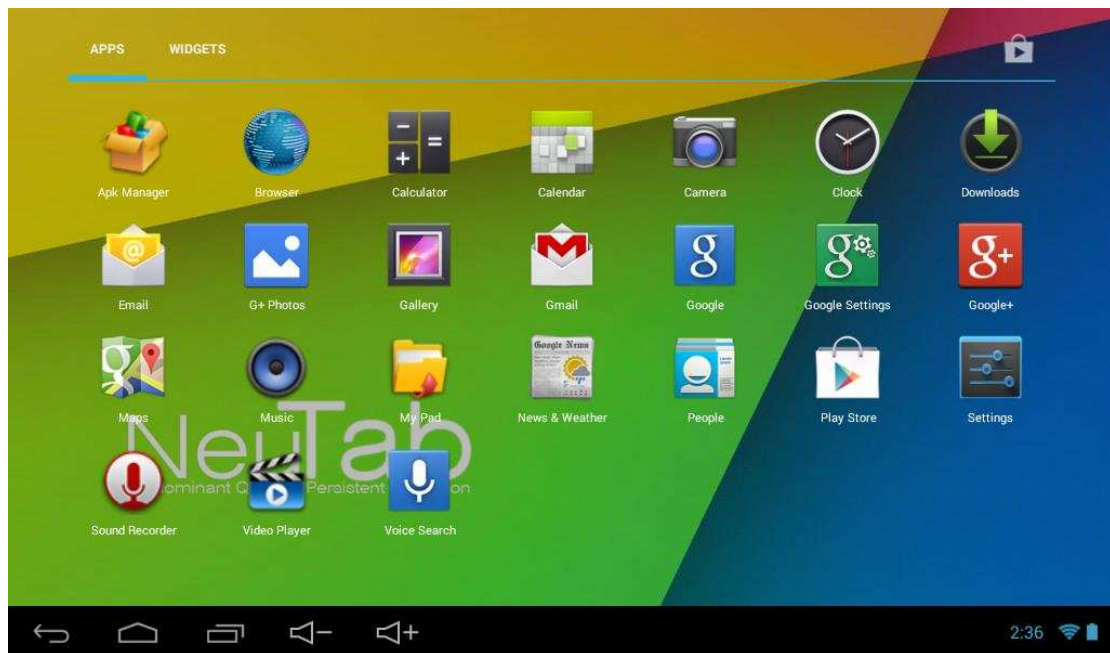

(The screenshot shown above is for demonstration purposes only. NeuTab reserves the right to modify and improve the final default applications available on different tablet models.)

Applications will be sorted by name. The default apps are:

APK Manager: Browse and install APK application packages.

Browser: Default internet browser.

Calculator: Default science calculator.

Calendar: Setup reminders on dates.

Camera: Access front and back camera to take pictures.

Clock: World clock, timer, and alarm setup.

Downloads: Manage downloaded materials from internet.

Email: setup your email account to access email.

Gallery: Browse saved pictures.

Google/Google settings/Google+: Browse Google account features

Maps: Browse Google maps.

Music: Play music stored in you tablet.

My Pad: Manage files and folders on your tablet.

News & Weather: Get latest news and weather updates in your area.

People: Manage contacts and friends in Google+.

Play Store: Download/purchase applications, music, movie and more from Google market.

Settings: Manage your tablet settings.

Sound Recorder: Record microphone input.

Video Player: Play videos in different formats stored in your tablet.

## Connecting to the Internet

This tablet can utilize Wi-Fi data networks to connect to the Internet.

Wireless Wi-Fi technology can provide Internet access at distances of over 300 feet; however, this distance can be affected by your surrounding environment and Wi-Fi router. In general, being

closer to Wi-Fi router improve performance.

## Requirements

In order to connect to the Internet, you will need either of the following:

### **A wireless router or access point with a broadband Internet connection**

The tablet can receive 802.11 b/g/n Wi-Fi radio. The tablet will also work with wireless routers that only support 802.11 b/g.

You will need to know **the name of your network (SSID)**, as well as the **password** or other credentials if your network is secured. These settings can usually be found on the administration webpage of your wireless router.

**Tips:** You may encounter open Wi-Fi networks, or “hotspots”. These networks are usually configured so that you can simply connect to them without needing to know its settings; the tablet will obtain all the information it needs from the router automatically.

**Warning:** Open Wi-Fi networks operates under the risk of information surveillance, your account information, especially password and other credentials might be audited by third parties. Please use caution when connected to open hotspots.

## Connect to a Wi-Fi network

The Notification bar displays icons that indicate your tablet's Wi-Fi status.



Connected to a Wi-Fi network (waves indicate connection strength).

[no icon] There are no Wi-Fi networks in range, or the Wi-Fi radio is off.

### **1. Turn on the Wi-Fi radio if it is not already on. To turn on Wi-Fi:**

a. Go to the Home screen:

Touch the **Home** icon.

b. Open the Launcher screen:

Touch the **Launcher Tab**, then touch **Settings**.

c. Open the Wireless & networks menu:

Touch **WIRELESS & NETWORKS**.

d. Open the Wi-Fi settings menu:

Touch **WiFi**.

e. Make sure that the Wi-Fi option box is set to ON: Touch and slide the block right to enable the **Wi-Fi** connection.

When Wi-Fi is on, the tablet will look for and display a list of available Wi-Fi networks.

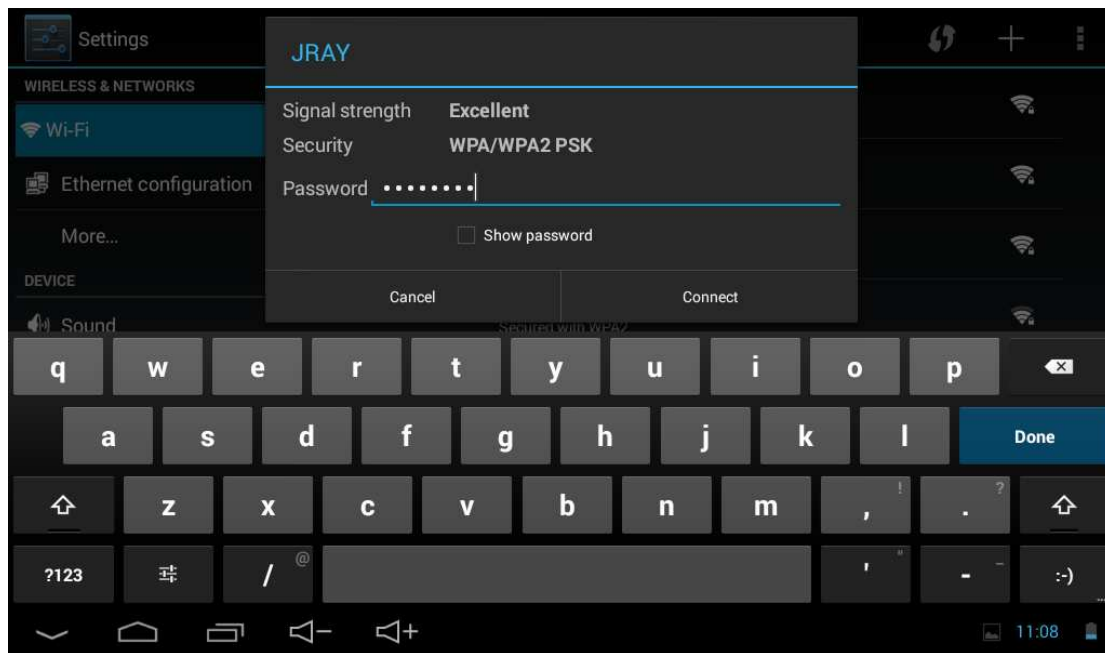

## 2. Select an available Wi-Fi network to connect to:

In the same Wi-Fi settings menu above, touch a network in the list.

If the network is open, the tablet will prompt you to confirm connection to the network. Touch **Connect** to confirm.

If the network is secured (as indicated by a Lock icon), the tablet will prompt you to enter a password or other credentials. Touch the Wireless password box to show the on-screen keyboard and then use it to enter the password. Touch **Connect** to confirm.

When you have successfully connected to a Wi-Fi network, the Notifications bar at the bottom of the screen will show a Wi-Fi signal indicator.

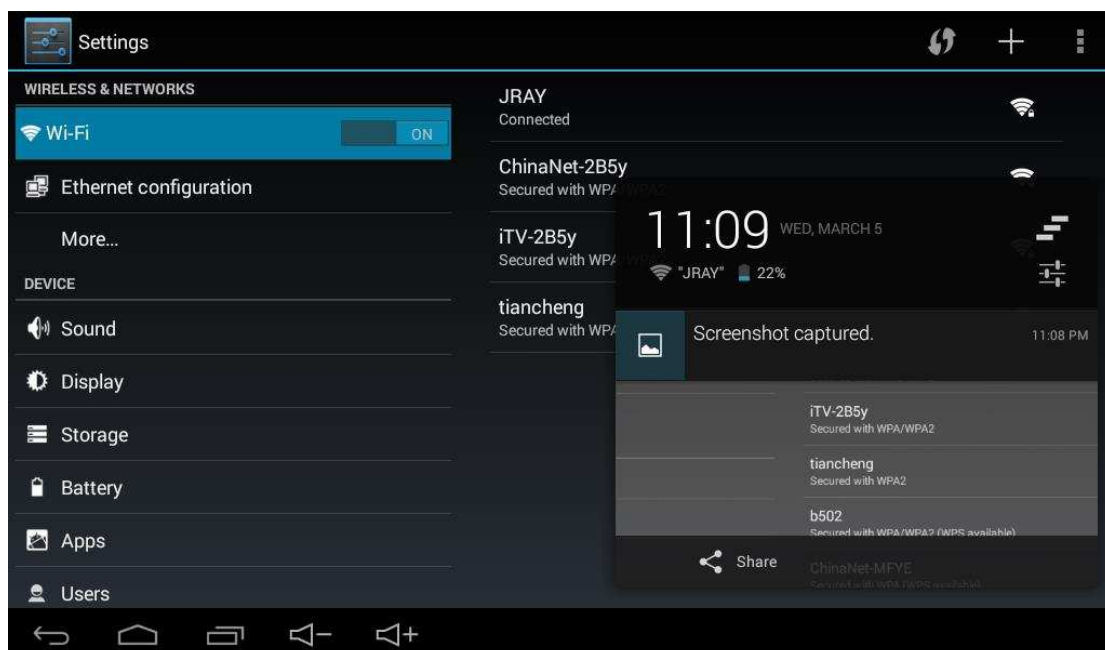



# Download Applications

This tablet is Google certified and has Google Play Store pre-installed. When connected to WiFi network, you can browse apps in Play Store and download/install them.

## The Play Store

Google Play Store can be found in the applications menu, you can always tap-hold-drag it to the main screen to make it easier to access.

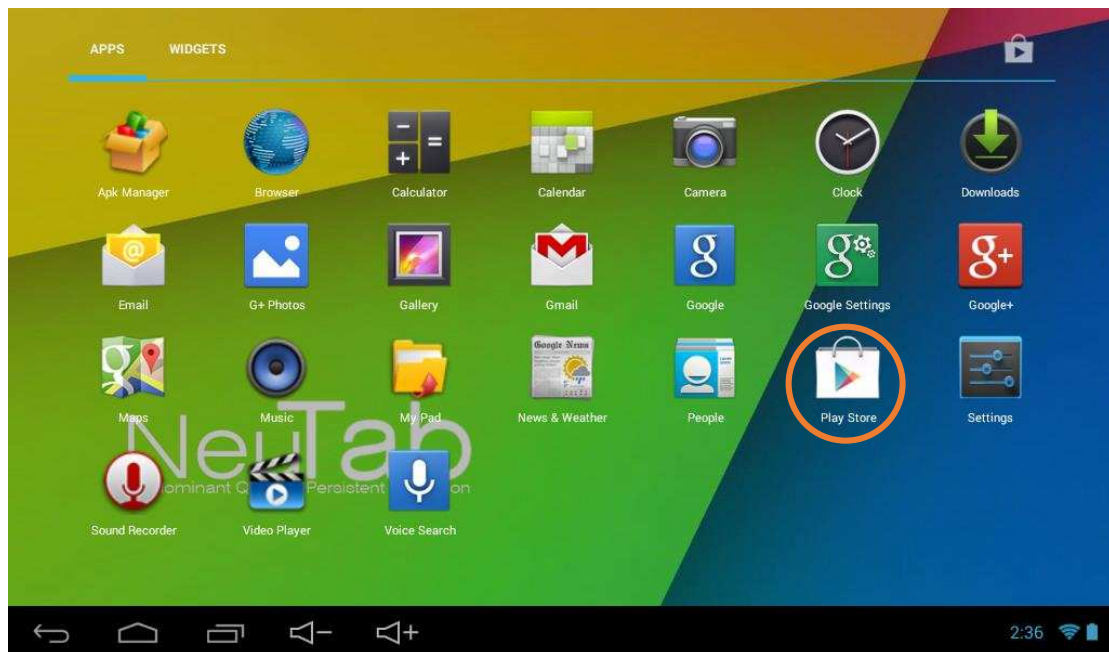

Play store requires a Google Account (a Gmail Account is good enough) to lunch and to help you stay updated with the applications you installed. If you do not have a Google Account, just tap "Create New" and let this tablet help you with a new account.

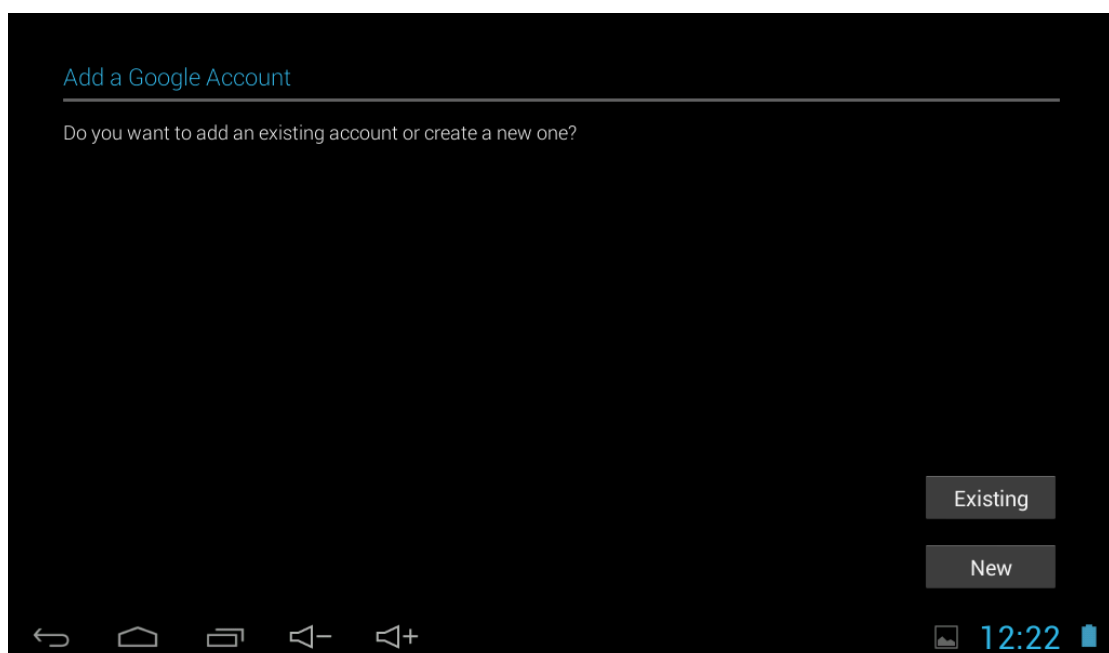

When logged-in, you can browse apps under different categories and featured/popular apps. Tap on the app icon and you have to choice to install/purchase this app. You can also search for an exact app or search an app by keyword by tapping the magnifying glass on the upper right corner.

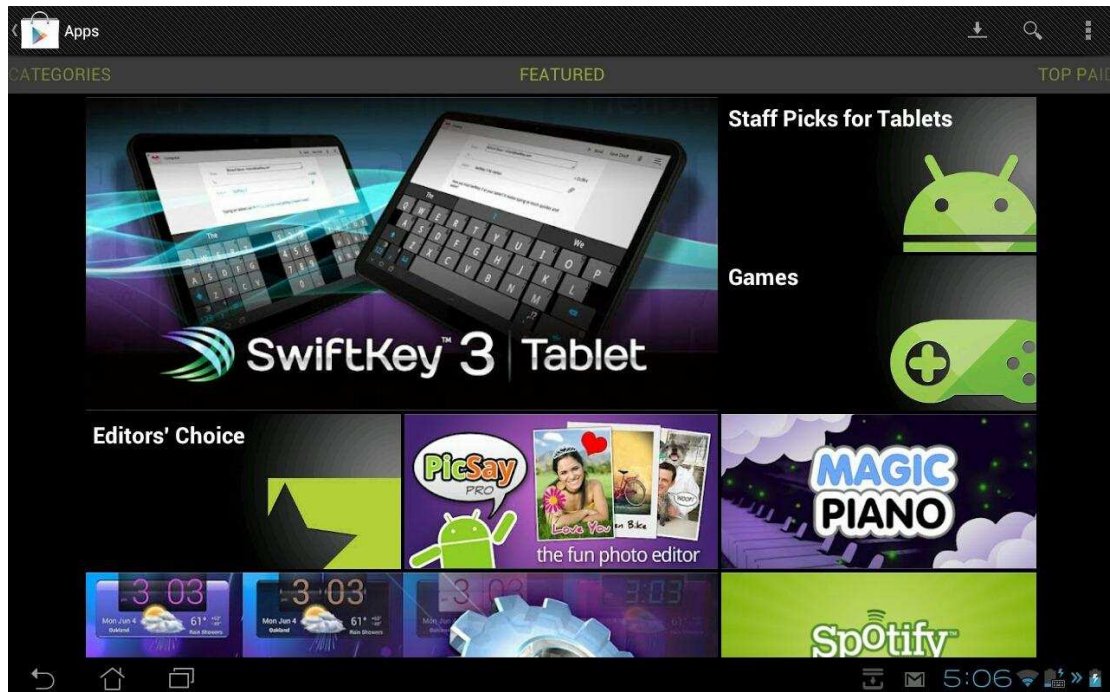

# Support

If you have a problem with this device, please check our website at [www.neutab.us](http://www.neutab.us) for Frequently Asked Questions (FAQ) and product updates. If these resources do not resolve the problem, please contact Technical Support.

## Important Safety Instructions

1. Read Instructions: All the safety and operating instructions should be read before the product is operated.
2. Retain Instructions: The safety and operating instructions should be retained for future reference.
3. Heed Warnings: All warnings on the product and in the operating instructions should be adhered to.
4. Follow Instructions: All operating and usage instructions should be followed.
5. Cleaning: Unplug this product from the wall outlet before cleaning. Do not use liquid cleaners or aerosol cleaners. Use a damp cloth for cleaning.
6. Attachments: Use only attachments recommended by the manufacturer. Use of other attachments may be hazardous.

7. **Water and Moisture:** Do not use this product near water (e.g., near a bath tub, washbowl, kitchen sink, laundry tub, in wet basements, or near a swimming pool and the like).
8. **Ventilation:** Slots and openings in the cabinet are provided for ventilation to ensure reliable operation of the product and to protect it from overheating. These openings should never be blocked by placing the product on a bed, sofa, rug, or other similar surface.  
This product should not be placed in a built-in installation such as a bookcase or rack unless proper ventilation is provided or the manufacturer instructions have been adhered to. Do not charge the device in a closed or non-air circulated environment. Even If the device does not have ventilation slots make sure to charge and use is in non-closed well air circulated environment.
9. **Power Sources:** This product should be operated only from the type of power source indicated on the rating label. If you are not sure of the type of power supply to your home, consult your product dealer or local power company. For products intended to operate from battery power or other sources, refer to the operating instructions.
10. **Overloading:** Do not overload wall outlets, extension cords, or integral convenience receptacles as this can result in a risk of fire or electric shock.
11. **Object and Liquid Entry:** Never push objects of any kind into this product through openings as they may touch dangerous voltage points or short-out parts that could result in a fire or electric shock. Never spill liquid of any kind on the product.
12. **Servicing:** Do not attempt to service this product yourself as opening or removing covers may expose you to dangerous voltage or other hazards. Refer all servicing to qualified service personnel.
13. **Damage Requiring Service:** Unplug this product from the wall outlet and refer servicing to qualified service personnel under the following conditions: a) when the power-supply or plug is damaged; b) if liquid has been spilled or if objects have fallen into the product; c) if the product has been exposed to rain or water; d) if the product does not operate normally by following the operating instructions. Adjust only those controls that are covered by the operating instructions as improper adjustment of other controls may result in damage and will often require extensive work by a qualified technician to restore the product to its normal operation; e) if the product has been dropped or damaged in any way; f) when the product exhibits a distinct change in performance—this indicates a need for service.
14. **Replacement Parts:** When replacement parts are required, be sure that your service technician has used replacement parts specified by the manufacturer or have the same characteristics as the original part. Unauthorized substitutions may result in fire, electric shock, or other hazards.
15. **Safety Check:** Upon completion of any service or repairs to this product, ask the service technician to perform safety checks to ensure that the product is in proper operating condition.
16. **Heat:** The product should be situated away from heat sources such as radiators, heat registers, stoves, or other products (including amplifiers) that produce heat.
17. **Lithium-ion battery caution:** This product is equipped with a Lithium-Ion battery. Do not pierce, open, disassemble it, or use it in a humid and/or corrosive environment. Do not put, store or leave your product in or near sources of heat, in direct strong sunlight, in a high temperature location, in a pressurized container or in a microwave oven. Do not expose it to

temperatures over 60 °C (140 °F). If the battery leaks and you come into contact with the leaks fluids, rinse thoroughly with water and seek medical attention immediately. Failure to follow these instructions could cause the Lithium Ion battery to leak acid, become hot, explode or ignite and cause injury and/or damage.

18. Operate battery in right way: Do not charge the device in a closed or non-air circulated environment. Make sure to charge the battery in non-closed well air circulated environment. Do not leave your battery charging for more than one week. Doing so runs the risk of overcharging the battery and shortening its total life span. If the device is not used for an extended period of time, the battery will slowly discharge and the device will need to be recharged before using again. Unplug the charger from the wall when it is not being used.

### **Legal and Trademark Notices (版权声明)**

No portion of this package, including shape, graphics, and design, may be reproduced or transmitted in any form or by any means, electronic or mechanical, including by photocopying, recording or use of any information storage and retrieval system without express written permission from Grand Electronics INC. Unauthorized reproduction or distribution of this package, design, or any portion of it will be prosecuted to the maximum extent possible under law.