

REV.	DATE	ECR NO.	DESCRIPTION
NC	07/07/04	-	INITIAL RELEASE
A	07/31/04	-	UPDATE RESISTOR WATTAGE
B	12/03/08	-	ADD 6.80mm DIMENSION

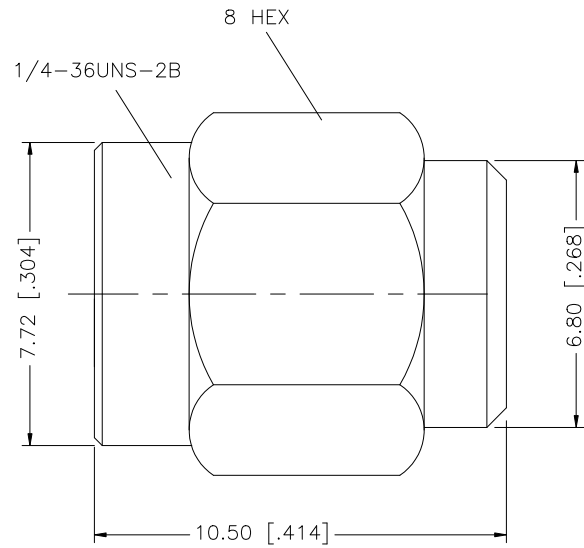

				UNLESS OTHERWISE SPECIFIED DIMENSIONS ARE IN MILLIMETERS. DIMENSIONS IN [ ] ARE IN INCHES AND FOR CUSTOMER REFERENCE ONLY.	APPROVALS	DATE	<h1>Amphenol Connex</h1>				
8					DRAWN	GRS					12/03/08
7					CHECKED			PART NO. <b>132360RP</b>			
6					ISSUED						
5					SHEET	1 OF 1		REV. B    SIZE A    SCALE NA			
4	RESISTOR	100R	1 WATT - 1%	2	UNLESS OTHERWISE SPECIFIED TOLERANCES FOR MILLIMETERS ARE: 0.5 - 8mm ± 0.20mm 8 - 30mm ± 0.40mm 30 - 120mm ± 0.50mm  UNLESS OTHERWISE SPECIFIED TOLERANCES FOR INCHES ARE: .020 - .315 = ± 0.007" .315 - 1.180 = ± 0.015" 1.180 - 4.724 = ± 0.020"						
3	CONTACT PIN	BER. COPPER	GOLD	1				CAD FILE C:/132/132360RP.DWG			
2	INSULATOR	PTFE	NATURAL	1	C:/132/132360RP.DWG						
1	BODY	BRASS	GOLD	1				C:/132/132360RP.DWG			
	DESCRIPTION	MATERIAL	FINISH	QTY	C:/132/132360RP.DWG						
								C:/132/132360RP.DWG			