

FRONT VIEW

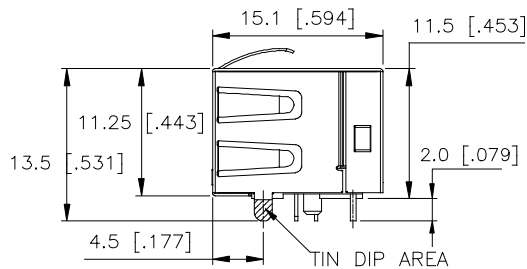

SIDE VIEW

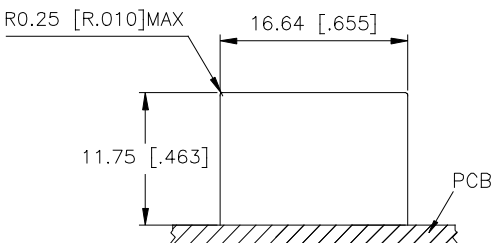

RECOMMENDED CUTOUT

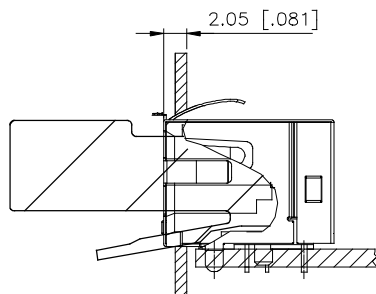

SHOWING CONNECTOR ON PCB

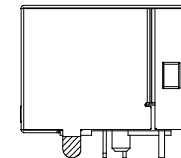
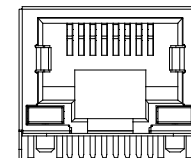

SHOWING FOR RJE73-188-00XXX  
(WITHOUT SHIELD TABS)

REVISIONS				
SYM	ZONE	ECN, ERN NO.	DATE	APPRD.
A		PROPOSAL	FEB24/2012	L.CHAN
B		PROPOSAL	MAR05/2012	L.CHAN
C		CORRECT PCB LAYOUT	SEP12/2012	L.CHAN
D		ADD LED OPTIONS	MAY08/2013	L.CHAN
E		UPDATE THE PANEL CUTOUT	OCT31/2013	L.CHAN

1. MATERIALS:

PLASTIC HOUSING: HIGH TEMPERATURE THERMOPLASTIC  
FLAMMABILITY RATING UL 94V-0  
COLOUR: BLACK

CONTACTS:

PHOSPHOR BRONZE  
PLATING: SELECTIVE GOLD PLATING ON MATING SURFACES SEE AMPHENOL PART NUMBER FOR DETAIL.  
50 μ" [1.27 MICRONS] MIN. NICKEL UNDERPLATE  
100 μ" [2.54 MICRONS] MIN. TIN ON CONTACT TAILS.

SHIELD:

STAINLESS STEEL WITH TIN DIP ON SOLDER TAIL

2. UNLESS OTHERWISE SPECIFIED DIMENSIONS ARE IN MILLIMETERS TOLERANCES ARE: 0.30MM.

MATES WITH MODULAR PLUG CONFORMING TO FCC PART 68, SUBPART F. RECOMMENDED SOLDER PROCESS: REFLOW SOLDER, PEAK TEMPERATURE 245° FOR 8~10 SECOND.

AMPHENOL PART NUMBER: RJE73-188-00XXX

GOLD PLATING OPTION  
1=6u" GOLD PLATING  
2=15u" GOLD PLATING  
3=30u" GOLD PLATING  
4=50u" GOLD PLATING

GROUND TABS OPTION  
0=WITHOUT TAB  
1=WITH SIDE AND TOP TABS  
REFER TO LED OPTIONS DRAWING FOR ORDERING CODES

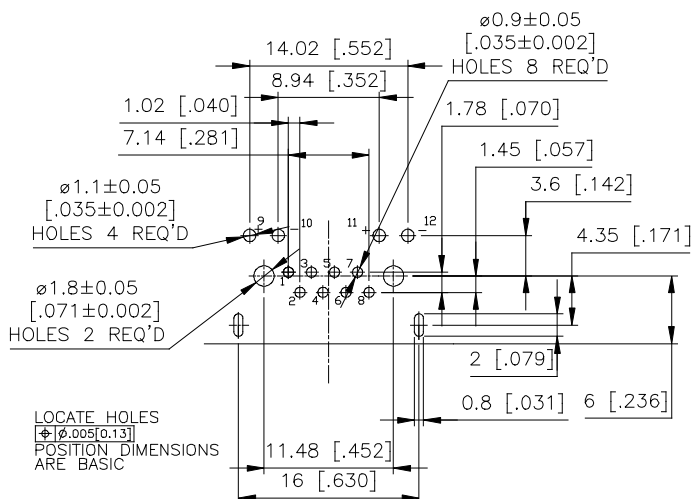

RECOMMENDED P.C.B LAYOUT  
(COMPONENT SIDE OF BOARD  
TOLERANCES: +/- 0.05[.002])

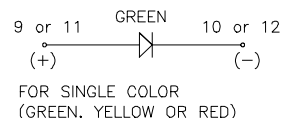

FOR SINGLE COLOR  
(GREEN, YELLOW OR RED)

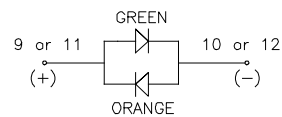

FOR BI-COLOR  
(GREEN/ORANGE, GREEN/YELLOW AND GREEN/RED)

LED SCHEMATIC

DRAWN	Edwin.Qu	DATE	FEB24/2012
DESIGNED			
CHECKED	L.Chan	DATE	FEB24/2012
I. E. APPRD.			
Q. A. APPRD.			
DWG. APPRD.	Adrian	DATE	FEB24/2012
ENG. REL. NO.			
REF.			
DIMENSIONS ARE IN	mm [INCHES]	CODE ID. NO.	03554

Amphenol Canada Corp.

TITLE  
MODULAR JACK, 8 POSITIONS, 8 CONTACTS, SHIELDED, WITH LEDS, WITH TAPE & REEL PACKAGING - RoHS COMPLIANT

DWG	DRAWING NO.	REV.
	P-RJE73-188-00XXX	E
SCALE	WT. -----	SURF. -----
		SHEET 1 OF 1

THIS DOCUMENT CONTAINS PROPRIETARY INFORMATION AND SUCH INFORMATION MAY NOT BE DISCLOSED TO OTHERS FOR ANY PURPOSE OR USED FOR MANUFACTURING PURPOSES WITHOUT WRITTEN PERMISSION FROM AMPHENOL CANADA CORP.

REVISIONS				
SYM	ZONE	ECN, ERN NO.	DATE	APPRD.
A		PROPOSAL	MAR14/2012	L.CHAN

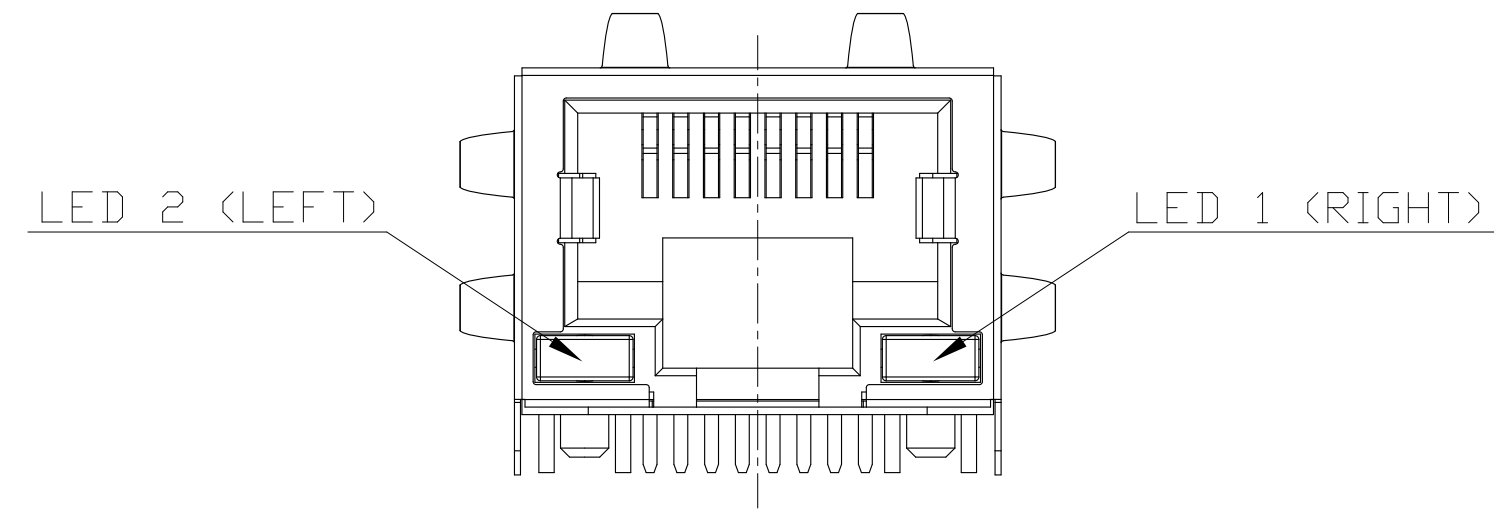

TYPICAL FOR SINGLE

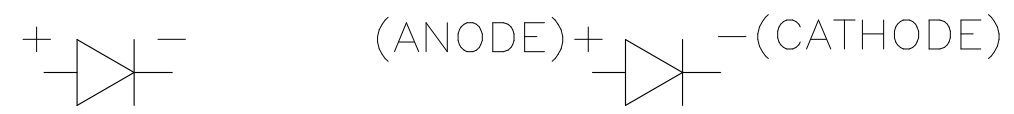

**LED SPECIFICATIONS:**  
 FORWARD VOLTAGE: 2.1 VOLTS TYP.  
 REVERSE VOLTAGE: 5.0 VOLTS MIN.  
 LUMINOUS INTENSITY: 0.5 mCd MIN.  
 (AT If=2mA)  
 STORAGE TEMPERATURE: -40° TO 85° C  
 LEAD SOLDERING TEMPERATURE: 260° C  
 (5 SEC, 1/16" FROM CASE)  
 PLATING ON TAILS: TIN OR TIN/COPPER ALLOY OVER SILVER

**EXAMPLE:**  
 PART NUMBER: RJE73-188-00XXX  
 LED COLOR CODE



PRIMARY COLOR FOR BI-COLOR  
 LEDS IN STANDARD ANODE/  
 CATHODE CONFIGURATION IS:  
 RED-GREEN= RED  
 RED-YELLOW= RED  
 GREEN-YELLOW= GREEN  
 GREEN-ORANGE= GREEN

CODE	LED 2 (LEFT)	LED 1 (RIGHT)	CODE	LED 2 (LEFT)	LED 1 (RIGHT)	CODE	LED 2 (LEFT)	LED 1 (RIGHT)
0	BLOCKED	BLOCKED	9	GREEN	BLOCKED	J	BiC RD/GR	YELLOW
1	YELLOW	GREEN	A	BiC GR/YE	BiC GR/YE	K	YELLOW	BiC GR/OR
2	BLOCKED	GREEN	B	BiC RD/GR	BiC RD/GR	L	BiC GR/YE	RED
3	YELLOW	BLOCKED	C	BiC RD/GR	BiC GR/YE	M	RED	YELLOW
4	GREEN	YELLOW	D	GREEN	BiC GR/YE	N	BiC GR/RD	BiC GR/YE
5	GREEN	GREEN	E	YELLOW	BiC GR/YE	P	GREEN	BiC RD/GR
6	YELLOW	YELLOW	F	BiC GR/YE	YELLOW	R	BiC GR/OR	GREEN
7	RED	GREEN	G	BiC GR/OR	BiC GR/OR	T	RED	RED
8	GREEN	RED	H	BiC GR/YE	GREEN	V	BiC RD/GR	GREEN

**LEGEND**  
 BiC=BI-COLOR LED  
 LOWC=LOW CURRENT LED  
 YE=YELLOW  
 GR=GREEN  
 RD=RED  
 OR=ORANGE

**NOTE:**  
 THE TWO DIGITS PRECEDING THE  
 ADDITIONAL LED CODE MUST BE  
 USED IN THE PART NUMBER, WHEN  
 ORDERING ANY OF THE ADDITIONAL  
 LED OPTIONS.

DRAWN	Edwin.Qu	DATE	MAR14/2012
DESIGNED			
CHECKED	L.Chan	DATE	MAR14/2012
I. E. APPRD.			
Q. A. APPRD.			
DWG. APPRD.	Adrian	DATE	MAR14/2012
ENG. REL. NO.			
REF.			
DIMENSIONS ARE IN	CODE ID. NO.		
mm[INCHES]	03554		

**Amphenol Canada Corp.**

TITLE  
LED OPTIONS FOR RJE73

DWG	DRAWING NO.	REV.
	P-RJE73-LEDs	A

SCALE: \_\_\_\_\_ WT. \_\_\_\_\_ SURF. \_\_\_\_\_ SHEET 1 OF 1

THIS DOCUMENT CONTAINS PROPRIETARY INFORMATION AND SUCH INFORMATION MAY NOT BE DISCLOSED TO OTHERS FOR ANY PURPOSE OR USED FOR MANUFACTURING PURPOSES WITHOUT WRITTEN PERMISSION FROM AMPHENOL CANADA CORP.