

USB 2.0 to SATA II 150 Cable

User Manual

Ver. 1.00

**All brand names and trademarks are properties of their
Respective owners.**

Features & Specifications

- Fully compliant with USB 2.0 & USB 1.1
- Transfer Rate: High-Speed up to 480 Mbps data transfer rate
- Access any 2.5" or 3.5" SATA drive through USB 2.0 port
- Compliant with Serial ATA 1.0 specification
- Compliance with Gen1i/m of SATA II electrical specification 2.5
- Supports LBA48 addressing mode
- Plug-and-play without installing the driver
- LED indicate for power status and drive activity
- One Touch Backup file or data
- Support Windows® 2000 / XP / Vista

System Requirements

- Windows® 2000/XP/Vista
- USB 1.1 or higher port

Package Contents

- 1 x USB 2.0 to SATA II 150 Cable
- 1 x User Manual
- 1 x Utility CD

Optional Accessories

- 1 x 5V/12V Power adapter

Note: Contents may vary depending on country/market

Hardware Description

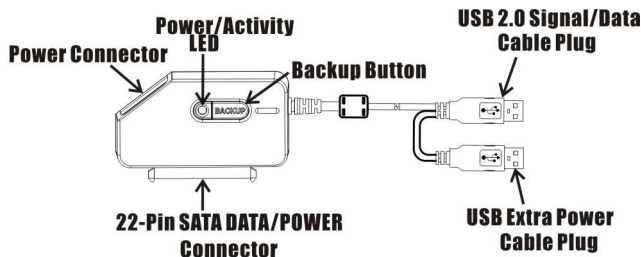

Power/Activity LED: The LED remains lit to show that the drive is on, and blinks to indicate drive activity.

Backup Button: Press the Backup Button to launch the PC Clone EX application

Hardware Installation

Using a 2.5" SATA Drive

1. Connect SATA connector to 2.5" SATA drive.

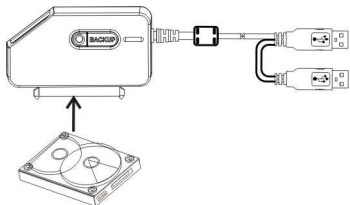

2. If power is insufficient, please plug in the USB Extra Power cable into a free USB port to get more power for the 2.5" hard disk.
3. Plug the USB 2.0 to SATA II 150 Cable into the USB port of your PC.

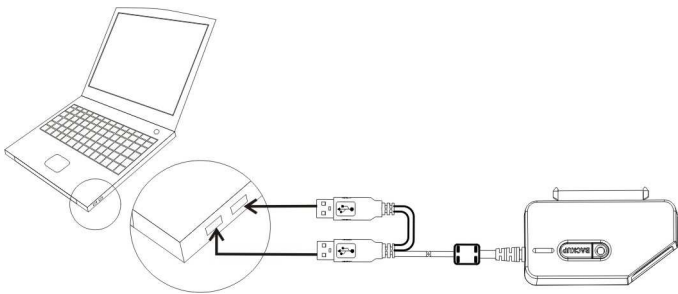

Using a 3.5" SATA Drive

1. Connect SATA connector to 3.5" SATA drive.

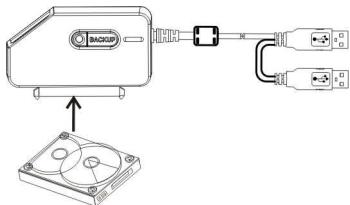

2. Please connect the power adapter to the USB 2.0 to SATA II 150 Cable.

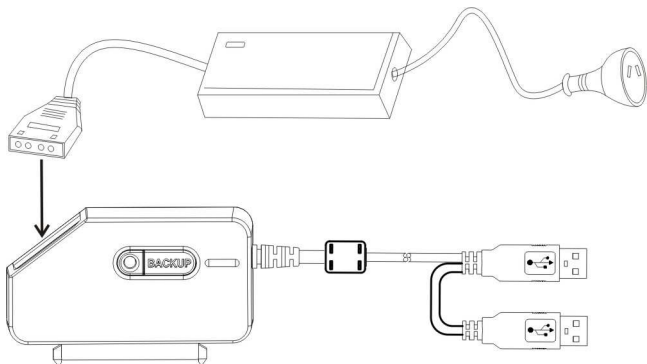

3. Plug the USB 2.0 to SATA II 150 Cable into the USB port of your PC.
(Note: DO NOT connect the USB Extra Power cable plug to any USB ports!)

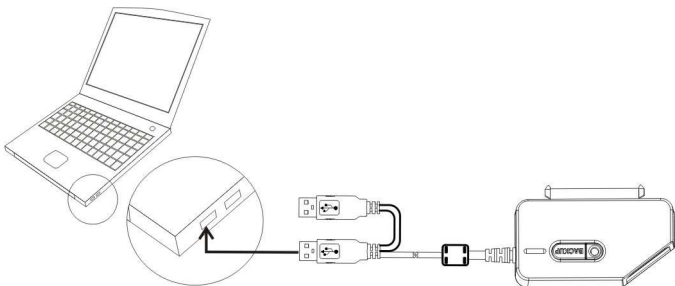

Warning

If extra power is needed, the USB Extra Power cable plug must be connected to the same host as the USB 2.0 Signal/Data cable plug. If they are connected to different host, it may cause hardware damage to your computer. Simply speaking, the USB ports in a computer have the same host. The USB ports in a hub have the same host. But the USB ports in a computer and the USB ports in a hub connected to the computer have different hosts.

Utility Installation

1. To install the PC Clone EX utility, please locate the installation CD folder “X:\JM20329” and then double click the **setup.exe** file.

2. Follow the on-screen installation to complete the installation.
3. “PC Clone EX” icon will displays in the notification area after setup, you can double click the icon or press the right key of the mouse to execute PC Clone EX.



For more information about the PC Clone EX utility, please follow the steps on below:

Right click “PC Clone EX” icon in the notification area, then select “Help” option in the pop-up menu.