



TCXO GPS STO-2016A

Applications

- GPS

Features

- Small ceramic package / Dimensions (2.0×1.6×0.8)
- High stability ±0.5ppm / -30°C ~ +85°C
- Low current consumption
- Low phase noise
- Clipped sine output (DC coupled)

Specifications



Model		STO-2016A
Nominal frequency (MHz)		16.368, 16.369, 19.2, 26, 27.456, 33.6 MHz
Frequency stability	Tolerance at 25°C	±2.0×10 ⁻⁶ (Sixty minutes after reflow)
	Temperature (+25°C basis)	±0.5×10 ⁻⁶ / -30~+85°C
	Supply voltage change	±0.2×10 ⁻⁶ / Vdd ±5%
	Load change	±0.2×10 ⁻⁶ / ZL ±10%
Aging		±1.0×10 ⁻⁶ / First year
Storage temperature range		-40~+85°C
Power supply voltage (Vcc)		+1.8V, +2.8V, +3.0V, +3.3V DC ±5%
Current consumption		2.0 mA max.
Output	Load (ZL)	10kΩ//10pF
	Voltage	0.8V p-p min.
	Waveform	Clipped Sine Wave (DC-coupled output)

*Reference / Idd Spec

Frequency stability[MHz]	Offset	at 10Hz	at 100Hz	at 1kHz	at 10kHz	Unit
		16.368, 16.369	-90(typ.)	-115(typ.)	-135(typ.)	
26.000	-70(typ.)	-105(typ.)	-130(typ.)	-145(typ.)	dBc/Hz	

Package quantity: 1,000pcs max./Reel.

Outline and Dimensions [unit:mm]

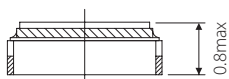
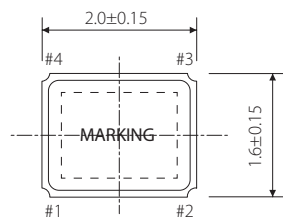

Note: A capacitor of value 0.01μF between Vdd and GND is recommended.

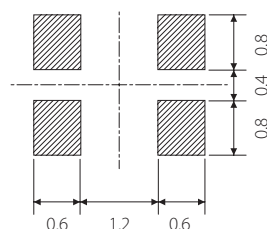
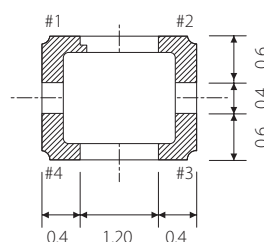

Terminal	Connection
#1	GND
#2	GND
#3	OUTPUT
#4	Vdd