

CRYSTAL OSCILLATOR

OSC71



Applications

- PC Main board / VGA card / DVD / DVC / DSC / Printer / Scanner / Game Console

Features

- Ceramic package / Dimensions (5.0×3.2×0.9)
- Operating Temperature -40°C ~ +85°C
- CMOS / TTL output / with Tri-state function

Specifications



Model	OSC71	
Frequency range	0.500~156.250 MHz	0.500~110.000 MHz
Storage temperature range	-55~ +125°C	
Operating temperature range	0~+70°C, -40~+85°C	
Frequency stability	±25×10 ⁻⁶ , ±50×10 ⁻⁶ , ±100×10 ⁻⁶	
Power supply voltage (Vdd)	+3.3V DC ±10%	+5.0V DC ±10%
Current consumption	10(※10) mA max: 0.5~14.9MHz 15(※15) mA max: 15~29.9MHz 20(※25) mA max: 30~39.9MHz 25(※30) mA max: 40~49.9MHz 30 mA max: 50~59.9MHz 40 mA max: 60~79.9MHz 50 mA max: 80~125MHz 55 mA max: 125.1~156.25MHz	10(※15) mA max: 0.5~14.9MHz 15(※20) mA max: 15~29.9MHz 20(※30) mA max: 30~39.9MHz 25(※40) mA max: 40~49.9MHz 30 mA max: 50~59.9MHz 40 mA max: 60~79.9MHz 50 mA max: 80~110MHz
Output level	TTL-CMOS (See Table A)	
Tri-state Function	#1: Floating or "H"→Output enable / #1: "L"→Output disable (Hi-Z)	

Tabla A

Output level	CMOS	TTL (+5.0V only)
Load	15pF (※ 30pF)	2TTL, 5TTL, 10TTL
Level	V _{OL} :10%V _{DD} max. / V _{OH} :90%V _{DD} min.	V _{OL} :+0.4 max. / V _{OH} :2.4V min.
Rise & Fall time	10ns max : F ≤ 40MHz, 7ns max : F > 40MHz, 2ns max : F > 125MHz	
	0.1V _{DD} - 0.9V _{DD}	+0.4V DC - +2.4V DC
Duty cycle	40% ~ 60% at 1/2V _{DD}	40% ~ 60% at +1.4V

Package quantity: 1,000pcs max./Reel.

Outline and Dimensions [unit:mm]

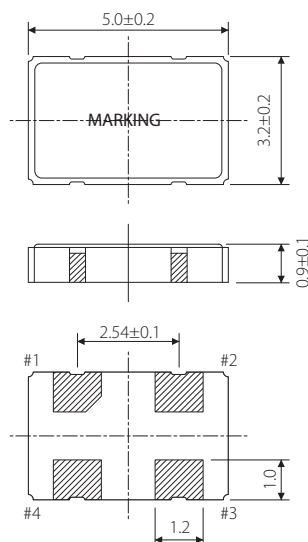

Example of a Terminal Land Pattern

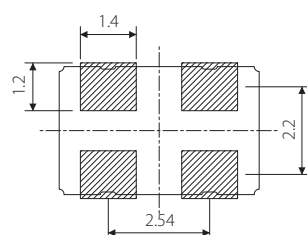

Terminal	Connection
#1	Tri-state
#2	GND
#3	OUTPUT
#4	Vdd

Tri-state Function

Tri-state Pin	Output
High or Floating	Active
Low	Hi-impedance