



# CRYSTAL OSCILLATOR

## SCO-2520

### Applications

- Cellular / PC Mainboard / VGA Card / DVD / Scanner / Game Console / DSC

### Features

- Ultra thin / Dimensions (2.5×2.0×0.8)
- Wide range operating temperature (-40~85°C)
- Low power consumption

### Specifications



Model	SCO-2520			
Frequency range	0.750~60.000 MHz			
Storage temperature range	-55~+100°C			
Operating temperature range	-20~+70°C, -40~+85°C			
Frequency stability	±30×10 <sup>-6</sup> (-20~70°C), ±50×10 <sup>-6</sup> , ±100×10 <sup>-6</sup>			
Power supply voltage (Vdd)	+3.3V DC ±5%	+3.0V DC ±5%	+2.5V DC ±5%	+1.8V DC ±5%
Current consumption	6 mA max: ~19MHz 7 mA max: ~39.9MHz 8 mA max: ~50MHz	5.5 mA max: 19.9MHz 6.5 mA max: ~39.9MHz 7.5 mA max: ~50MHz	4.5 mA max: ~19.9MHz 5.5 mA max: ~39.9MHz 6.5 mA max: ~50MHz	2.5 mA max: ~29.9MHz 3.0 mA max: ~39.9MHz 3.5 mA max: ~50MHz
Output level	C-MOS			
Load	15pF max.			
Output voltage level	V <sub>OL</sub> : 10%V <sub>dd</sub> max. / V <sub>OH</sub> : 90%V <sub>dd</sub> min.			
Rise & Fall time	10ns max. / 0.1V <sub>dd</sub> - 0.9V <sub>dd</sub>			
Duty cycle	45%~55% at 1/2V <sub>dd</sub>	40%~60% at 1/2V <sub>dd</sub>	45%~55% at 1/2V <sub>dd</sub>	
Tri-state Function	#1: Floating or "H"→Output enable / #1: "L"→Output disable(Hi-Z)			

Package quantity: 3,000pcs max./Reel.

### Outline and Dimensions [unit:mm]

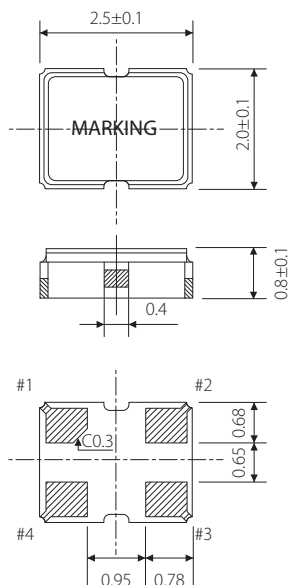

Example of a Terminal Land Pattern

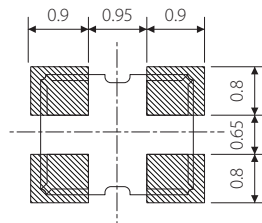

Terminal	Connection
#1	Tri-state
#2	GND
#3	OUTPUT
#4	Vdd

Tri-state Function

Tri-state Pin	Output
High or Floating	Active
Low	Hi-impedance