



5.08mm Wire To Board Header Straight (R/A) Type

■ MATERIAL

Insulator : Polyester
Contact Pin : Brass

■ SPECIFICATION

Current Rate : 7 AMP
Insulation Resistance : 1000MΩ MIN.
Contact Resistance : 20mΩMax.
Operation Temperature : -25°C to +85°C



■ Detail Dimensions

759-73-xxTW06

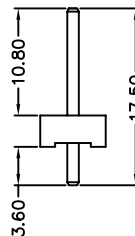
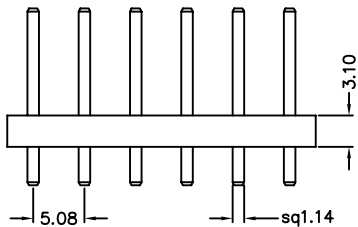
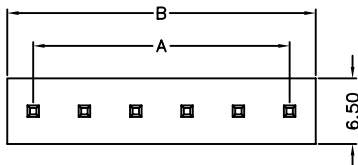

759-74-xxTW06

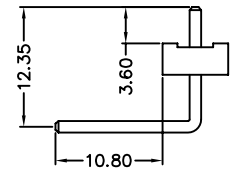
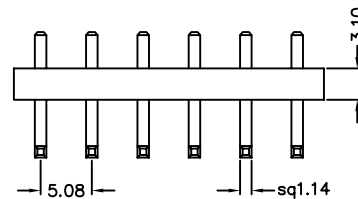
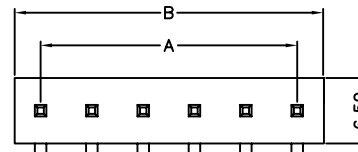

■ Recommended P.C.B Layout

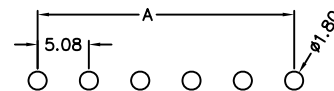
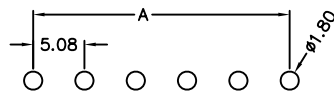

■ Order Information

759-7 x - xx T W xx
1 2 3 4 5

Standard Parts	Type
759-73-xxTW06	Straight
759-74-xxTW06	Right Angle

- 1. 3: Straight Type
- 4: Right Angle Type
- 2. No. of contacts
- 3. T: Tin Plating
- 4. W: White Insulator
- 5. Pinrex internal code

■ Number Of Contacts

Unit: mm

Poles	DIM A	DIM B	Poles	DIM A	DIM B	Poles	DIM A	DIM B						
2	5.08	9.91	9	40.64	45.47	16	76.20	81.03						
3	10.16	14.99	10	45.72	50.55	17	81.28	86.11						
4	15.24	20.07	11	50.80	55.63	18	86.36	91.19						
5	20.32	25.15	12	55.88	60.71	19	91.44	96.27						
6	25.40	30.23	13	60.96	65.79	20	96.52	101.35						
7	30.48	35.31	14	66.04	70.87									
8	35.56	40.39	15	71.12	75.95									