



2.5mm Board-In Header Straight (R/A) Type

MATERIAL

Insulator : Polyester
Contact Pin : Copper Alloy

SPECIFICATION

Current Rate : 2 AMP
Insulation Resistance : 1000MΩ MIN.
Contact Resistance : 20mΩMax.
Operation Temperature : -25°C to +85°C



Detail Dimensions

705-75-xxW008 (Housing)

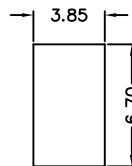
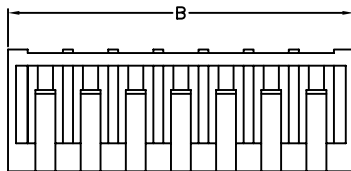
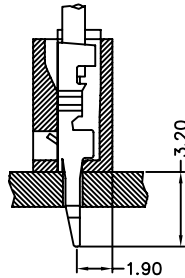
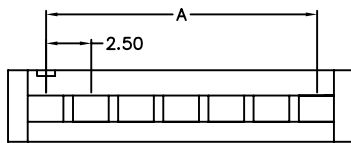

705-76-xxW008 (Housing)

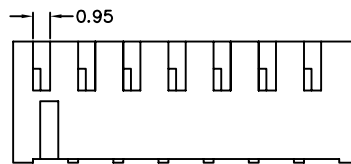
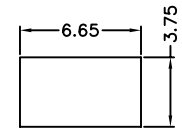
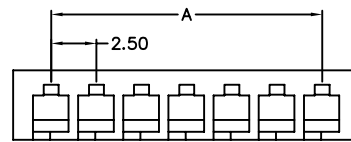
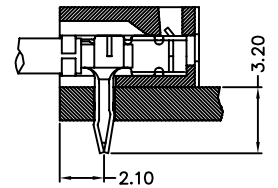
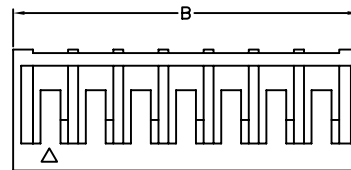

Recommended P.C.B Layout

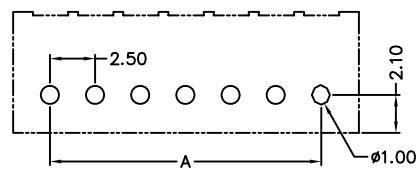
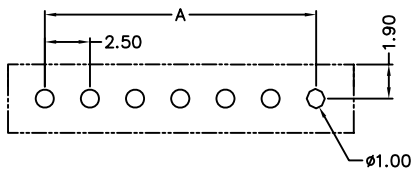

Order Information

705-7 x - xx W 008
1 2 3

705-70 - x x x 008
4 5 6

- 1. 5: HSG Straight Type
- 6: HSG Right Angle Type
- 2. No. of contacts
- 3. W: White Insulator

- 4. 1: TML Straight Type
- 2: TML Right Angle Type
- 5. T: Tin Plating
- 6. B: Brass
- P: Phosphor Bronze

Standard Parts	Type
705-75-xxW008	Housing Straight
705-76-xxW008	Housing R/A
705-70-1TB008	Terminal Straight
705-70-2TB008	Terminal R/A

Number Of Contacts

Unit: mm

Poles	DIM A	DIM B	Poles	DIM A	DIM B	Poles	DIM A	DIM B						
2	2.50	6.50	9	20.00	24.00	16	37.50	41.50						
3	5.00	9.00	10	22.50	26.50									
4	7.50	11.50	11	25.00	29.00									
5	10.00	14.00	12	27.50	31.50									
6	12.50	16.50	13	30.00	34.00									
7	15.00	19.00	14	32.50	36.50									
8	17.50	21.50	15	35.00	39.00									