



D-Sub Hood (101 & 102 Series)

MATERIAL

Hood: ABS UL 94HB
Screw: Steel with Nickel plated
Cable Clipper: Steel with Nicker plated



Detail Dimensions

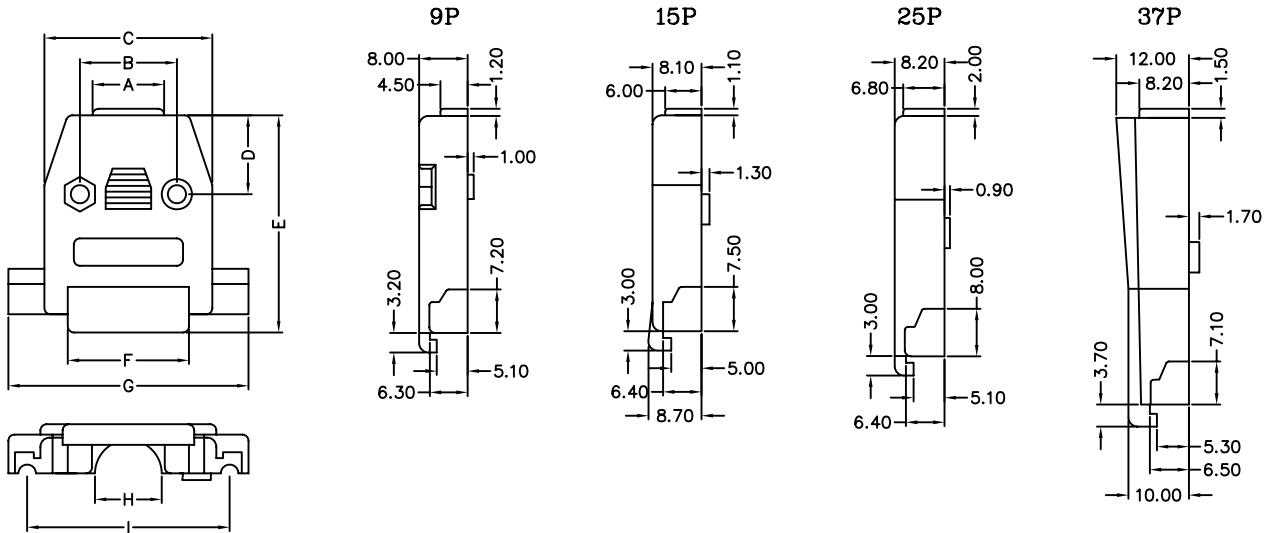

Accessories

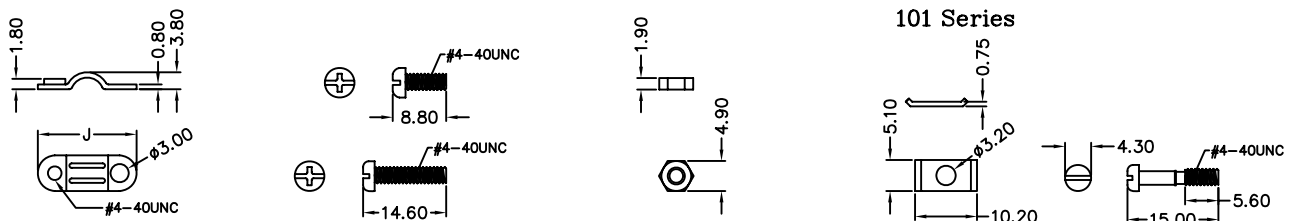

Order Information

993-6x-xx xx x 1
1 2 3 4

- 1: Bulk package
- 2: Bag package
2. 01: 101 Series
- 02: 102 Series
3. No. of contacts
4. 0: Black Insulator
- 1: Gray Insulator
- 2: Chrome-plated Insulator

Standard Parts	
993-61-01xx01	
993-61-01xx11	
993-61-02xx01	
993-61-02xx11	

102 Series

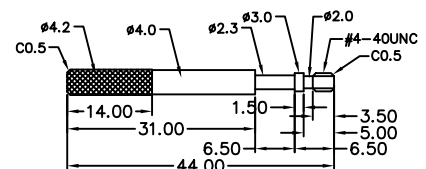

Number Of Contacts

Unit: mm

Poles	DIM A	DIM B	DIM C	DIM D	DIM E	DIM F	DIM G	DIM H	DIM I	DIM J				
9	ø9.00	12.80	20.50	11.70	40.20	12.10	31.00	ø7.0	24.99	16.20				
15	ø11.80	16.00	27.70	13.00	35.80	20.00	39.60	ø10.00	33.40	19.40				
25	ø13.00	30.00	40.80	18.50	42.00	30.00	54.20	ø11.00	46.50	26.50				
37	ø16.50	35.00	57.80	23.00	51.00	29.90	69.00	ø13.80	63.50	26.50				

* 23 & 50 ways are available, please ask for spec. sheet, thanks!

* There are many other hoods available, please contact our sales rep. for information, thanks!