



2.54mm Dip Plug (for 1.27mm Flat Cable)

MATERIAL

Insulator : Polyester
Contact Pin : Phosphor Bronze

SPECIFICATION

Current Rate : 1 AMP
Insulation Resistance : 1000MΩMin. at DC 500V
Contact Resistance : 10mΩMax. at DC 100mA
Operation Temperature : -55°C to +105°C



Detail Dimensions

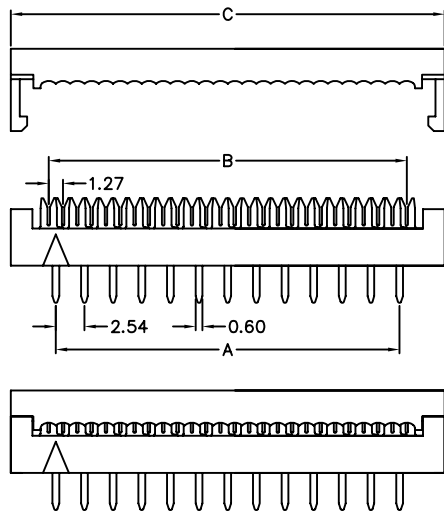

0.1"x0.1"

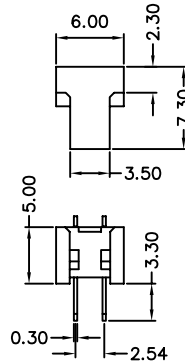

0.1"x0.3"

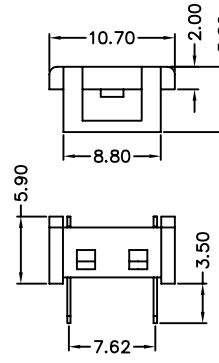

0.1"x0.6"

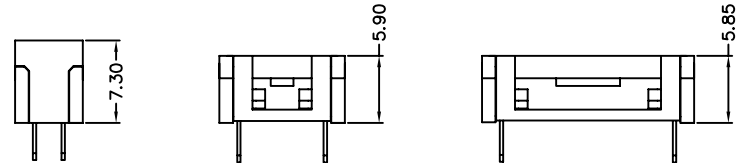
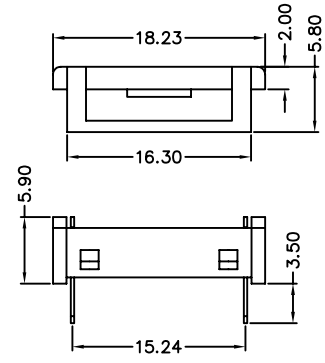

Recommended P.C.B Layout

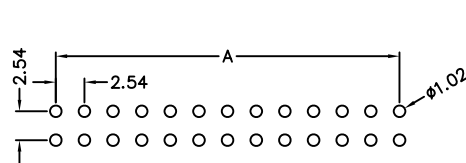

0.1"x0.1"

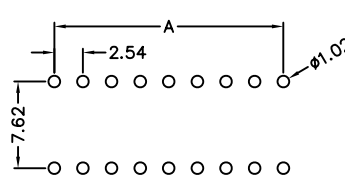

0.1"x0.3"

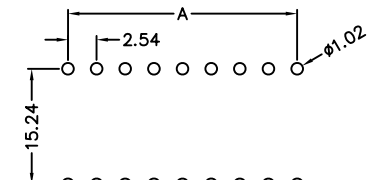

0.1"x0.6"

Order Information

978-11- x xx 1 x 2
1 2 3

1. 1: 0.1"x0.1"
- 3: 0.1"x0.3"
- 6: 0.1"x0.6"
2. No. of contacts
3. 0: Tin Plating
- 2: Selective Plating

Standard Parts
978-11-1xx102
978-11-3xx102
978-11-6xx102

Kink Type available
0.1"x0.1"

978-11-0xx402

Number Of Contacts

Unit: mm

Poles	DIM A	DIM B	DIM C	Poles	DIM A	DIM B	DIM C	Poles	DIM A	DIM B	DIM C	Poles	DIM A	DIM B	DIM C
106	5.08	6.35	13.07	120	22.86	24.13	30.85	150	60.96	62.23	68.95	340	48.26	49.53	56.12
108	7.62	8.89	15.61	124	27.94	29.21	35.93	160	73.66	74.93	81.65	624	27.94	29.21	35.80
110	10.16	11.43	18.15	126	30.48	31.75	38.47	164	78.74	80.01	86.73	628	33.02	34.29	40.88
112	12.70	13.97	20.69	130	35.56	36.83	43.55	324	27.94	29.21	35.80	632	38.10	39.37	45.96
114	15.24	16.51	23.23	134	40.64	41.91	48.63	328	33.02	34.29	40.88	636	43.18	44.45	51.04
116	17.78	19.05	25.77	136	43.18	44.45	51.17	332	38.10	39.37	45.96	640	48.26	49.53	56.12
118	20.32	21.59	28.31	140	48.26	49.53	56.25	336	43.18	44.45	51.04				