



2.0mm IDC Connector (for 1.0mm Flat Cable)

MATERIAL

Insulator : Polyester
Contact Pin : Copper Alloy

SPECIFICATION

Current Rate : 1 AMP
Insulation Resistance : 1000MΩMin. at DC 500V
Contact Resistance : 15mΩMax. at DC 100mA
Operation Temperature : -40°C to +105°C



Detail Dimensions

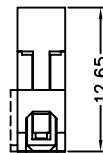
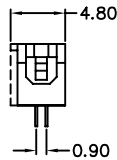
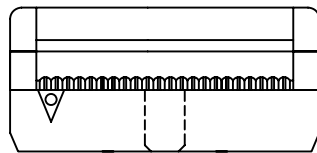
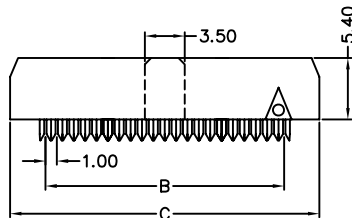
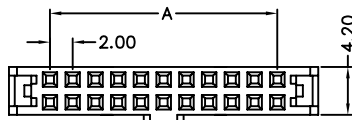

COVER

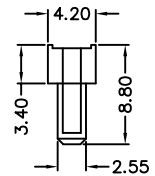
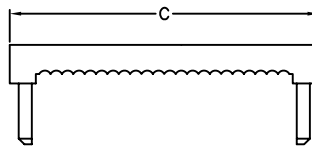

STRAIN RELIEF

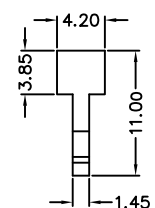
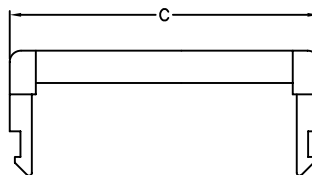

Order Information

977-21 - xx x x x 2
1 2 3 4

1. No. of contacts
2. 3: with Bump
4: without Bump
3. 2: without Strain Relief
3: with Strain Relief
4. 0: Selective Plating
2: Gold Flash

Standard Parts	Type
977-21-xx3202	with Bump ; w/o SR
977-21-xx3302	with Bump ; with SR
977-21-xx4202	w/o Bump ; w/o SR
977-21-xx4302	w/o Bump ; with SR

Number Of Contacts

Unit: mm

Poles	DIM A	DIM B	DIM C	Poles	DIM A	DIM B	DIM C	Poles	DIM A	DIM B	DIM C	Poles	DIM A	DIM B	DIM C
6	4.00	5.00	11.20	20	18.00	19.00	25.20	34	32.00	33.00	39.20	54	52.00	53.00	59.20
8	6.00	7.00	13.20	22	20.00	21.00	27.20	36	34.00	35.00	41.20	56	54.00	55.00	61.20
10	8.00	9.00	15.20	24	22.00	23.00	29.20	38	36.00	37.00	43.20	60	58.00	59.00	65.20
12	10.00	11.00	17.20	26	24.00	25.00	31.20	40	38.00	39.00	45.20	62	60.00	61.00	67.20
14	12.00	13.00	19.20	28	26.00	27.00	33.20	44	42.00	43.00	49.20	64	62.00	63.00	69.20
16	14.00	15.00	21.20	30	28.00	29.00	35.20	48	46.00	47.00	53.20	68	66.00	67.00	73.20
18	16.00	17.00	23.20	32	30.00	31.00	37.20	50	48.00	49.00	55.20	80	78.00	79.00	85.20