



2.54mm Pin Header SMT R/A Stack Type

MATERIAL

Insulator : High Temperature Polyester
Contact Pin : Brass

SPECIFICATION

Current Rate : 3 AMP
Insulation Resistance : 5000MΩMin. at DC 500V
Contact Resistance : 20mΩMax. at DC 100mA
Operation Temperature : -40°C to + 105°C



Detail Dimensions

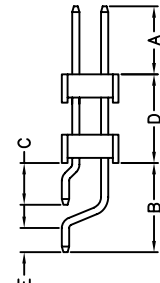
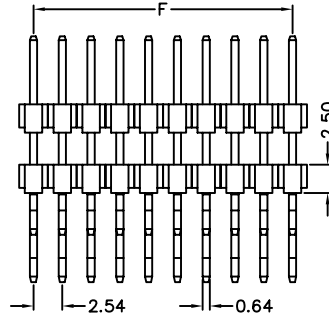
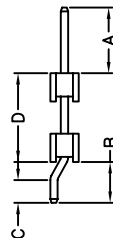
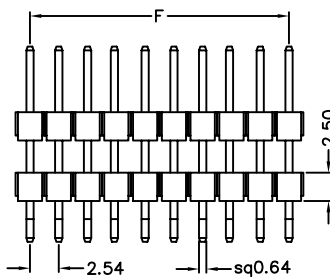
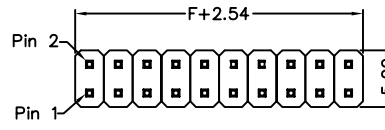
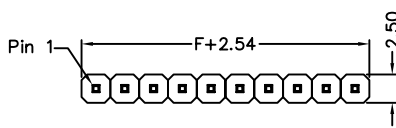

Recommended P.C.B Layout

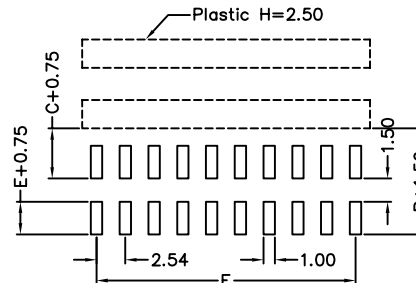
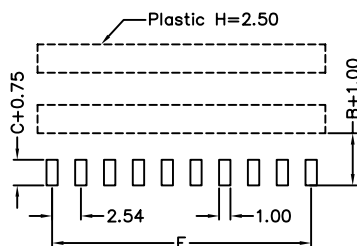

Order Information

21V-9 x - xx G B xx
1 2 3 4

1. 1: Single row Plastic Height=2.5mm
2: Dual rows Plastic Height=2.5mm
2. No. of contacts per row
3. G: Gold Flash
S: Selective Gold Plating
T: Tin Plating
4. Pinrex internal code

If you need other dimensions, please fill out DIM A/B/C/D/E and contact our sales representatives.

DIM A	DIM B	DIM C	DIM D	DIM E

Number Of Contacts

Unit: mm

Poles	DIM F	Poles	DIM F	Poles	DIM F	Poles	DIM F	Poles	DIM F	Poles	DIM F	Note
2	2.54	9	20.32	16	38.10	23	55.88	30	73.66	37	91.44	1) Single Row is available up to 1x50 ways, please contact us for information!
3	5.08	10	22.86	17	40.64	24	58.42	31	76.20	38	93.98	
4	7.62	11	25.40	18	43.18	25	60.96	32	78.74	39	96.52	
5	10.16	12	27.94	19	45.72	26	63.50	33	81.28	40	99.06	2) Plastic in Red, Yellow, Green, Blue, Pink, Purple and other colors are available, please provide Pantone color code and contact us for information!
6	12.70	13	30.48	20	48.26	27	66.04	34	83.82			
7	15.24	14	33.02	21	50.80	28	68.58	35	86.36			