

# M12/M18/M30 Sensor Brackets ST

**IMO**

Simple and multi-directional adjustable brackets for barrel-type sensors

- Axial and right-angle brackets with slotted holes for  $\pm 15^\circ$  adjustment in a single direction
- Swing-mount brackets with  $\pm 15^\circ$  adjustment in all directions
- All brackets can be locked in the required position
- For use with photoelectric, inductive and capacitive proximity switches



## Options and ordering codes

Axial bracket for M12 sensors	<b>ST12-A</b>
Right-angle bracket for M12 sensors	<b>ST12-C</b>
Axial bracket for M18 sensors	<b>ST18-A</b>
Right-angle bracket for M18 sensors	<b>ST18-C</b>
Axial bracket for M30 sensors	<b>ST30-A</b>
Right-angle bracket for M30 sensors	<b>ST30-C</b>
Swing-mount bracket, top fixing for M12 sensors	<b>ST04</b>
Swing-mount bracket, top fixing for M18 sensors	<b>ST02</b>
Swing-mount bracket, side or bottom fixing for M30 sensors	<b>ST13</b>
Swing-mount bracket, top fixing for M30 sensors	<b>ST14</b>

## Dimensions (mm)

**Axial mount bracket  $\phi 12\text{mm}$  ST12-A**

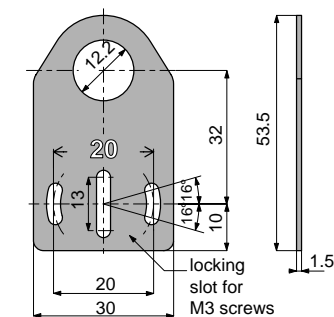

■ Material: Nickel-plated steel

**Right-angle mount bracket  $\phi 12\text{mm}$  ST12-C**

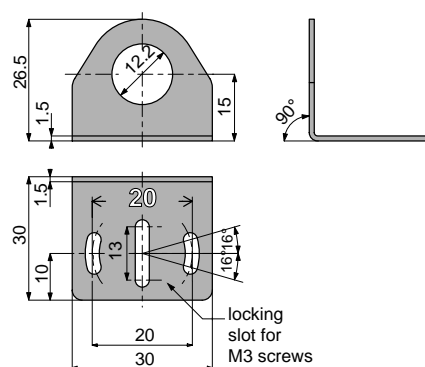

■ Material: Nickel-plated steel

# IMO

**Axial-mount bracket ø18mm  
ST18-A**



15°



**ST 13:** fastening from the bottom or the side

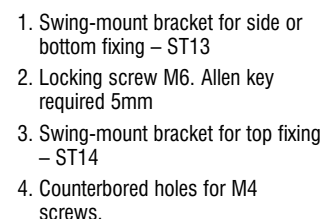
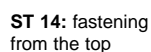

- Fasten the mount bracket and lightly tighten the locking screw (2.)
- Direct the photoelectric switch to find the optimum position. The accessory allows rotation in all directions at an angle of  $15^\circ$  max
- Tighten the locking screw (2.) in the desired position.

www.imopc.com