ENGLISH

Xbox 360 Chatpad

Thanks for choosing the Xbox 360® Chatpad. Chatpad attaches to the back of your Xbox 360 wired or wireless controller to enable in-game text messaging, instant messaging, and other text entry. The keypad is optimised for fast, thumbs-only typing.

To use Chatpad for messaging, you need an Xbox LIVE® membership. For information about Xbox LIVE, see your Xbox 360 Setup manual (Volume 1). You will also need either an Xbox 360 Controller or Xbox 360 Wireless Controller, both sold separately.

Chatpad offers:

- A dedicated Windows Live™ Messenger button for instant access to in-game text messaging and Windows Live Messenger instant messaging on Xbox 360.
- An audio jack for use with any headset that uses a standard 2.5-mm connector.
- Backlit keys.

- Tactile confirmation of each button press.

NOTE

Only controllers with the Created by Xbox stamp are compatible with Chatpad. Only products manufactured by Microsoft will bear this stamp.



WARNING

Before using this product, read this manual and the Xbox 360 console manuals for important safety and health information. Keep all manuals for future reference. For replacement manuals, go to www.xbox.com/support or call Xbox Customer Support (see "If You Need More Help").

The limited warranty covering this product is contained in the Xbox 360 Warranty manual (Volume 2) and is available online at www.xbox.com/support.

UPDATE YOUR CONSOLE

Before you connect Chatpad to your controller, make sure your Xbox 360 console is up to date by connecting to Xbox LIVE. For more information about connecting to Xbox LIVE, see your Xbox 360 Setup manual (Volume 1).

CONNECT CHATPAD TO A CONTROLLER

Once you've connected your console to Xbox LIVE and completed any system updates, you're ready to connect Chatpad to a controller.

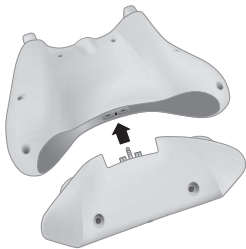

- 1 Turn over both your controller and your Chatpad so the bottoms face up.
- 2 Align the Chatpad connector plug with the controller's expansion port. Align the two posts on the Chatpad with the holes on the controller.
- 3 Gently but firmly push the Chatpad onto the controller with even pressure until they snap together.

NOTE

If your console is not connected to the Internet or if you are not a subscriber to Xbox LIVE, you can download the Chatpad update to your PC, burn it to a CD, and install it on your console. For more info, go to www.xbox.com/update.

You may need to use firm pressure to fully seat the Chatpad onto the controller. A fully-seated Chatpad will have no gaps between it and the edges of the controller.

Once Chatpad is connected to a powered controller, it is ready to use.

Connect a Headset

The 2.5-mm audio jack on Chatpad lets you connect headsets such as the revised Xbox 360 Headset with inline volume control or a mobile phone headset. Xbox 360 Chatpad does not work with the original Xbox 360 Headset with volume controls on the cable connector. For more information, see the instruction manual for your headset.



To connect a headset, plug the headset's connector into the 2.5-mm connector jack on Chatpad.

Hearing Loss

Extended exposure to high volumes when using a headset may result in temporary or permanent hearing loss. Some unapproved third-party headsets may produce higher sound levels than approved Xbox 360 Headsets.

USING CHATPAD

Keyboard

As with a standard PC keyboard, Chatpad characters are lower case by default and the SHIFT button is your access to capital letters.



English Keyboard



French Keyboard



German Keyboard

In addition to standard keys like those for numbers, space, and backspace, Chatpad provides two “modifier” keys other than SHIFT: AMBER and GREEN. These keys toggle between standard key values (white characters) and special characters (amber or green colored characters printed on the keys).

Also featured on the Chatpad is the Windows Live Messenger button. Press this button to access instant messaging. The Windows Live Messenger button also lights up whenever you receive an instant message.

For information about using Chatpad with a particular game, see your game manual.

Special Characters

When you press the SHIFT, AMBER, or GREEN key once, the subsequent key press will produce a character in your selected mode (upper-case or special). The second and following key presses will be in the normal (lower-case) mode.

To enter caps lock mode, press the AMBER key and then press the SHIFT (CAPS) key. Press this key combination again to return to normal mode.

The SHIFT, AMBER, and GREEN keys illuminate to signify that the keypad is in a particular mode.

To add a diacritic (accent mark) to a letter, press the key combination for the diacritic, then press the letter to apply the diacritical mark to. For example, to enter ü on an English chatpad, press the GREEN key, the G key (the umlaut character is printed in green on this key), and then the U key.

Backlight

Chatpad’s white backlight enables use in dark rooms. Pressing any key on the Chatpad will activate the backlight, which will stay on for several seconds after each press.

TROUBLESHOOTING

If you encounter problems, try the possible solutions provided below.

Keypad Uses Incorrect Language Set

The Chatpad keypad is pre-configured for a specific set of language characters. To determine the language set for your Chatpad, see the sticker on the underside of the device.

Keypad Doesn't Work

Make sure Chatpad is connected securely to your controller.

Voice Chat Doesn't Work

Make sure your headset connector is plugged in securely and that Chatpad is connected securely to your controller. Check the mute button on the headset control to make sure the microphone is on.

Make sure that the mute function in the Xbox 360 console is not activated. Confirm that you are properly signed into Xbox LIVE and that Family Settings or privacy settings are not preventing voice communication.

IF YOU NEED MORE HELP

Go to www.xbox.com/support or call Xbox Customer Support:

- Ireland: 1-800-509-186
- United Kingdom: 0800-587-1102
- South Africa: 0800-99-1550

Do not take your Xbox 360 console or its accessories to your retailer for repair or service unless instructed to do so by an Xbox Customer Support representative.

Do Not Attempt Repairs

Do not attempt to take apart, service, or modify the Xbox 360 console, power supply, or its accessories in any way. Doing so could present the risk of serious injury or death from electric shock or fire, and it will void your warranty.

DISPOSAL OF WASTE ELECTRICAL AND ELECTRONIC EQUIPMENT (WEEE) IN THE EUROPEAN UNION AND OTHER COUNTRIES WITH SEPARATE COLLECTION SYSTEMS

This symbol on the product or its packaging means that this product must not be disposed of with your household waste. Instead, it is your responsibility to hand this over to an applicable collection point for the recycling of electrical and electronic equipment. This separate collection and recycling will help to conserve natural resources and prevent

potential negative consequences for human health and the environment, which inappropriate disposal could cause due to the possible presence of hazardous substances in electrical and electronic equipment. For more information about where to drop off your electrical and electronic waste, please contact your local city/ municipality office, your household waste disposal service, or the shop



where you purchased this product. Contact weee@microsoft.com for additional information on WEEE.

COPYRIGHT

Information in this document, including URL and other Internet Web site references, is subject to change without notice. Complying with all applicable copyright laws is the responsibility of the user. Without limiting the rights under copyright, no part of this document may be reproduced, stored in or introduced into a retrieval system, or transmitted in any form or by any means (electronic, mechanical, photocopying, recording, or otherwise), or for any purpose, without the express written permission of Microsoft Corporation.

Microsoft may have patents, patent applications, trademarks, copyrights, or other intellectual property rights covering subject matter in this document. Except as expressly provided in any written licence agreement from Microsoft, the furnishing of this document does not give you any licence to these patents, trademarks, copyrights, or other intellectual property.

© 2008 Microsoft Corporation. All rights reserved.

Microsoft, Xbox, Xbox 360, Xbox LIVE, the Xbox logos, the Xbox LIVE logo, Windows, Windows Live, Windows Vista, and the Windows Live Messenger icon are trademarks of the Microsoft group of companies.