

## HPH Series



Due to accurate wire winding technology, these chip inductors are designed for filtering, impedance matching, resonance and choke circuits for RF designer. Both standard series custom designs are available.

### Features

- RoHS Compliant and Halogen Free
- Ceramic body and wire wound construction provide high Q and SRFs
- Higher Q and lower DCR than other inductors
- Exceptional current handling capability
- HPH series is for high power and high frequency application

### Applications

- Wireless embedded portable devices
- GPS receiver
- Base Station
- Repeater
- Set Top Box
- Cable / IP Modem
- Security system and other RF modules

### Product Identification

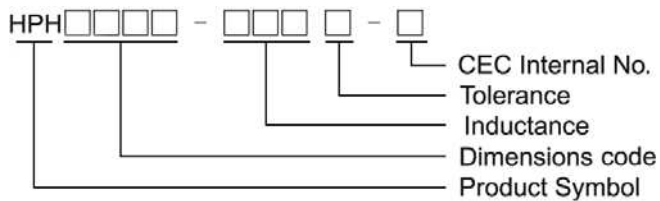

### Shape and Dimensions / Recommended Pattern

#### HPH0603

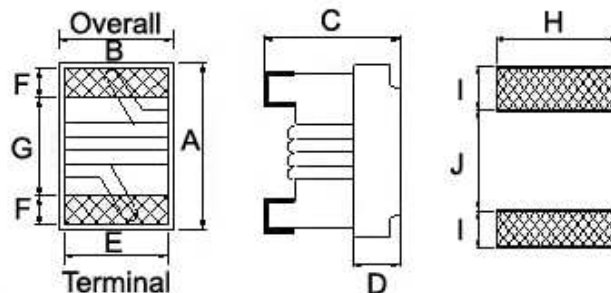

#### Dimensions

	A	B	C	D	E	F	G	H	I	J
<b>HPH0603</b>	1.6 <sup>+0.2</sup> <sub>-0.1</sub>	1.12 ± 0.1	0.82 <sup>+0.2</sup> <sub>-0.1</sub>	0.30	0.70	0.30	0.95	1.02	0.64	0.64

# SMD Wire Wound Ceramic Chip Inductors - HPH Series

## Electrical Characteristics

Part Number	Inductance (nH)	Test Frequency (MHz)	Tolerance (±%)	Q Typ	Test Frequency (MHz)	SRF (GHz) Typ	Rdc (Ω) Max	Irms (mA) Max
HPH0603-3N3□-N	3.3	250	5 / 3	36	250	9.6	0.034	1900
HPH0603-3N6□-N	3.6	250	5 / 3	28	250	9.7	0.040	1900
HPH0603-5N1□-N	5.1	250	5 / 3	38	250	8.9	0.042	1700
HPH0603-5N6□-N	5.6	250	5 / 3	35	250	6.6	0.042	1700
HPH0603-6N0□-N	6.0	250	5 / 3	49	250	6.0	0.042	1700
HPH0603-8N2□-N	8.2	250	5 / 3	40	250	5.9	0.054	1400
HPH0603-8N7□-N	8.7	250	5 / 3	46	250	5.5	0.054	1400
HPH0603-9N1□-N	9.1	250	5 / 3	40	250	5.1	0.052	1400
HPH0603-9N5□-N	9.5	250	5 / 3	42	250	4.9	0.054	1400
HPH0603-10N□-N	10	250	5 / 3	44	250	4.3	0.054	1400
HPH0603-12N□-N	12	250	5 / 3	40	250	4.1	0.088	1100
HPH0603-18N□-N	18	250	5 / 3	45	250	3.3	0.082	1200

- When ordering, please specify tolerance and packaging codes.
- Tolerance : H = ±3% , J = ±5%
- L , Q : Agilent E4991A + Agilent HP16197A
- SRF : Agilent/E5071C
- Rdc : Chroma16502
- I rms for a 15°C rise above 25°C ambient.
- Operating temperature range from -40°C to 125°C . (Including self - temperature rise)

Typical **L** vs. **F** Frequency

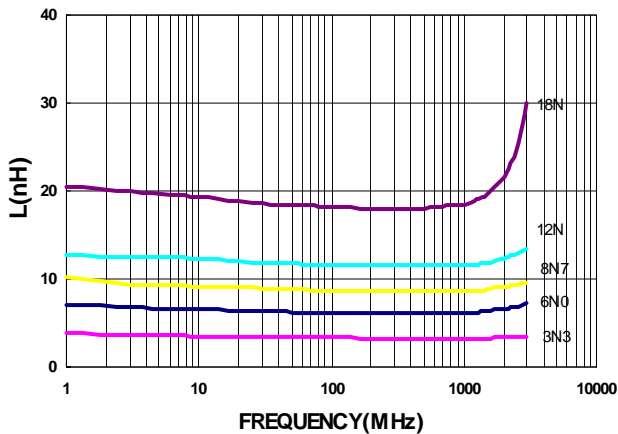

Typical **Q** vs. **F** Frequency

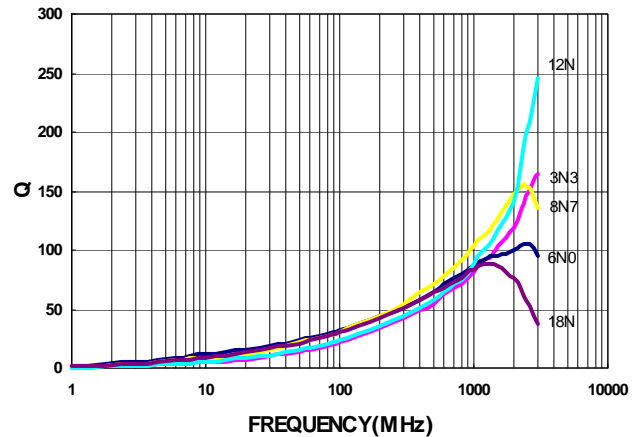

# SMD Wire Wound Ceramic Chip Inductors - HPH Series

## Packaging Specifications

Tape Dimensions

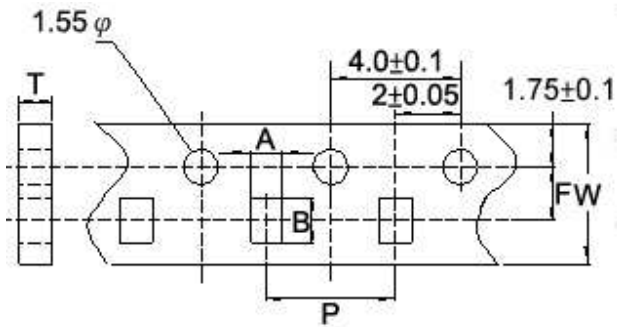

Tape Material

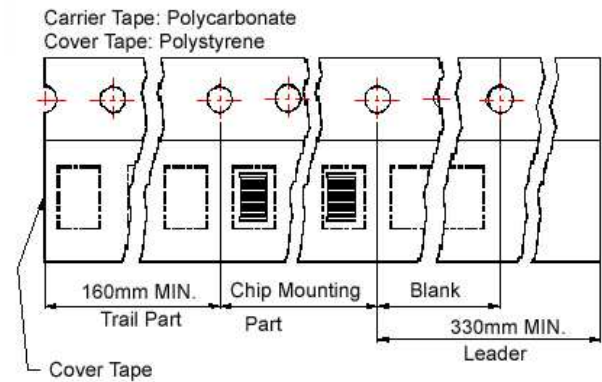

Reel Dimensions

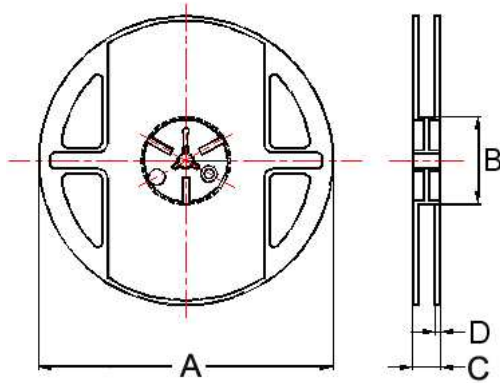

## Dimensions in mm

TYPE	Tape Dimensions						Reel Dimensions				Quantity PCS / Reel
	A	B	T	W	P	F	A	B	C	D	
HPH0603	1.23	1.90	0.97	8	4	3.5	178	60	12	1.5	4000