

# SOJ CHIP CARRIER SOCKET

## FEATURES

- For use with Small Outline JEDEC (SOJ) packages
- Socket profile allows ultra low packaging
- High temperature material resists distortion
- Leads are tin plated after stamping for high reliability
- Open frame allows solder joint inspection

## STANDARD PART DIMENSIONS

### INSULATOR BODY

### Surface Mount

<b>H</b>	HEIGHT	0.183" / 4,65mm
<b>S</b>	STANDOFF	0.020" / 0,51mm

SEE TABLE BELOW FOR OTHER DIMENSIONS

## MATERIALS

INSULATOR BODY	High Temperature Thermoplastic (UL94V-O)
CONTACT	Phosphor Bronze

See SPECIFICATIONS and PERFORMANCE DATA for more information.

## SURFACE MOUNT (28 to 42 Positions)

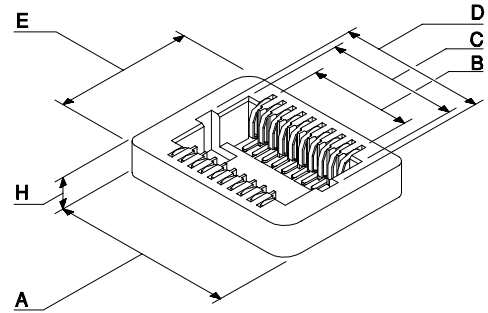

## PART DIMENSIONS CHART

CONTACTS	"A" DIM	"B" DIM	"C" DIM	"D" DIM	"E" DIM
28	0.990" / 25,2mm	0.650" / 16,5mm	0.760" / 19,4mm	0.880" / 22,4mm	0.660" / 16,7mm
32	1.090" / 27,7mm	0.750" / 19,0mm	0.860" / 21,9mm	0.980" / 25,0mm	0.660" / 16,7mm
40	1.290" / 32,8mm	0.950" / 24,1mm	1.060" / 27,0mm	1.120" / 30,1mm	0.660" / 16,7mm
42	1.340" / 34,1mm	1.000" / 25,4mm	1.115" / 28,3mm	1.230" / 31,3mm	0.660" / 16,7mm

NOTE: SOJ sockets are packaged in tubes. Please contact factory for other requirements.

**SAMPLE HOTLINE: 1-800-676-7644**

	HOW TO ORDER CRANE'S SOJ SERIES						
	STANDARD PART NUMBER						OPT.
				--			
<b>PRODUCT SERIES</b>	SOJ						
<b>ROW TO ROW SPACING</b>	0.400"	4					
Please reference table above for available sizes.							
<b>TOTAL NUMBER OF POSITIONS</b>	POSITIONS		28-42				
<b>PLATING (See Specifications At The Bottom Of The Page)</b>	TIN				T		
<b>TAIL CONFIGURATION</b>	SURFACE MOUNT					S	
<b>ALIGNMENT PIN (OPTION)</b>							A

## CRANE CONNECTORS - PLATING SPECIFICATIONS

PLATING OPTIONS		CONTACT AREA Inches (Millimeters)	PC TAIL Inches (Millimeters)	UNDERPLATE Inches (Millimeters)
<b>G</b>	Selective	15 $\mu$ " (0,00038) Gold	100 $\mu$ " (0,00254) Tin/Lead - Min.	50 $\mu$ " (0,00127) Nickel - Min.
<b>T</b>	Tin / Lead	100 $\mu$ " (0,00254) Tin / Lead	100 $\mu$ " (0,00254) Tin/Lead - Min.	50 $\mu$ " (0,00127) Nickel - Min.
<b>M</b>	Selective	50 $\mu$ " (0,00127) Gold	100 $\mu$ " (0,00254) Tin/Lead - Min.	50 $\mu$ " (0,00127) Nickel - Min.
<b>H</b>	Selective	30 $\mu$ " (0,00076) Gold	100 $\mu$ " (0,00254) Tin/Lead - Min.	50 $\mu$ " (0,00127) Nickel - Min.
<b>L</b>	Selective	10 $\mu$ " (0,00025) Gold	100 $\mu$ " (0,00254) Tin/Lead - Min.	50 $\mu$ " (0,00127) Nickel - Min.
<b>F</b>	Selective	3 $\mu$ " (0,00008) Gold	100 $\mu$ " (0,00254) Tin/Lead - Min.	50 $\mu$ " (0,00127) Nickel - Min.

ENGINEERING NOTE: The information presented in this catalog is accurate to the best of our knowledge. Due to ongoing efforts to advance design and material performance, the information is subject to change without notice.

ISO9001



Crane Connectors  
File No. A-3620

Registered by UL to ISO9001 under  
UL's accreditation by Raad voor de  
Certificatie (RvC), the Dutch Council  
for Certification.

**SAMPLE HOTLINE: 1-800-676-7644**