

# HDA500-1S

## Dimensional Drawing

5", WVGA(800X480) TFT, Transmissive, Color

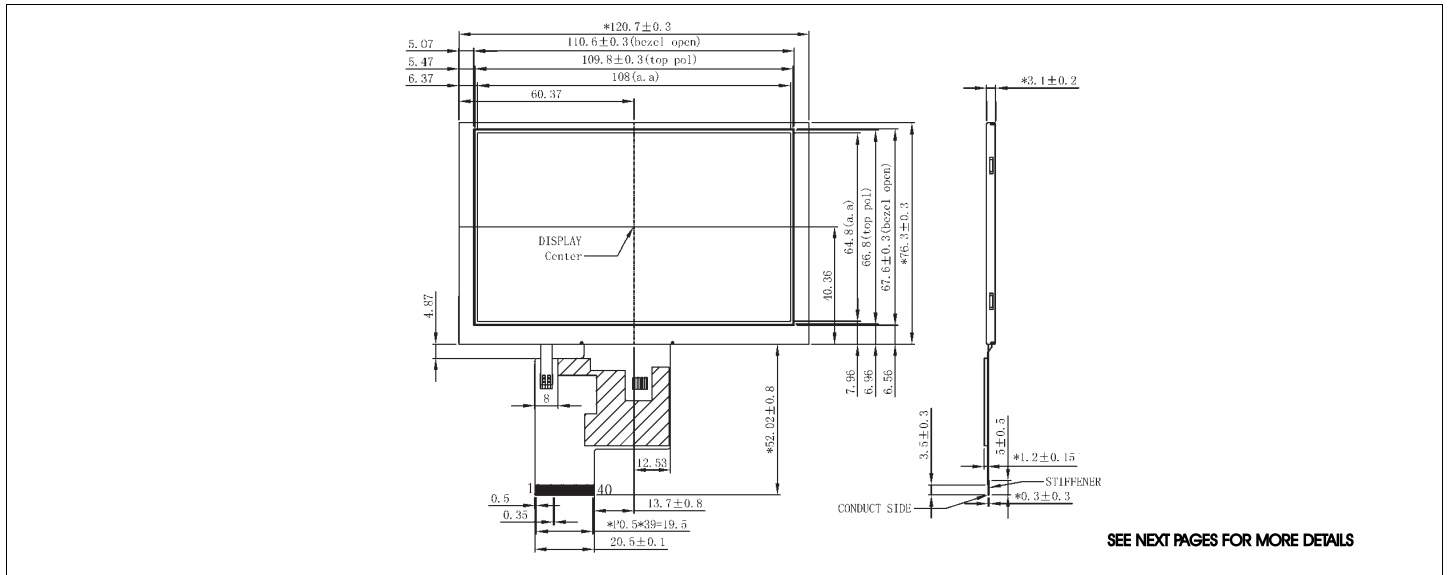

### Features

- Viewing Angle(H/V).....140/120 degrees
- High Contrast.....500.
- Fast Response Time.....25 msec
- Built-in DC-DC Converter
- Built-in Controller.....none
- Touch screen (CTP) .....optional

### Electrical Characteristics (VDD=3.3±0.1 25V 25°C)

PARAMETER	SYM	CONDITION	MIN	TYP	MAX	UNIT
OPERATING VOLTAGE	V <sub>DD</sub>	-	3.1	3.3	3.5	V
INPUT HIGH VOLTAGE	V <sub>HI</sub>	-	0.7V <sub>DD</sub>	-	V <sub>DD</sub>	V
INPUT LOW VOLTAGE	V <sub>LI</sub>	-	0	-	0.3V <sub>DD</sub>	V
OPERATING CURRENT	I <sub>DD</sub>	-	-	110	150	mA
LED OPERATING VOLTAGE	V <sub>LED</sub>	-	19.6	21.7	23.8	V
OPERATING CURRENT	I <sub>FLED</sub>	-	-	40	-	mA
POWER CONSUMPTION	P <sub>D</sub>	-	-	1230	-	mW
BRIGHTNESS	L	-	280	350	-	cd/m <sup>2</sup>

### Physical Data

- Module Size.....129.00W x85.80H x1.9 T mm
- Viewing Area Size.....109.0W x65.8 H mm
- Dot Pitch.....0.135W x 0.135H mm
- Weight.....TBD

### Pin Connections

PIN NO.	SYMBOL	FUNCTION
1	VLED -	LED Cathode
2	VLED +	LED Anode
3	GND	Ground
4	VDD	+ 3.3V Power Supply
5	R0	Red Data Bit 0
6	R1	Red Data Bit 1
7	R2	Red Data Bit 2
8	R3	Red Data Bit 3
9	R4	Red Data Bit 4
10	R5	Red Data Bit 5
11	R6	Red Data Bit 6
12	R7	Red Data Bit 7
13	G0	Green Data Bit 0
14	G1	Green Data Bit 1
15	G2	Green Data Bit 2
16	G3	Green Data Bit 3
17	G4	Green Data Bit 4
18	G5	Green Data Bit 5
19	G6	Green Data Bit 6
20	G7	Green Data Bit 7
21	B0	Blue Data Bit 0
22	B1	Blue Data Bit 1
23	B2	Blue Data Bit 2
24	B3	Blue Data Bit 3
25	B4	Blue Data Bit 4
26	B5	Blue Data Bit 5
27	B6	Blue Data Bit 6
28	B7	Blue Data Bit 7
29	GND	Ground
30	CLK	Data Clock
31	DISP	Display ON/OFF (H/L)
32	NC	No Connect
33	NC	No Connect
34	DE	Data Enable
35	NC	No Connect
36	GND	GND
37-40	NC	No Connection

### Power Supply

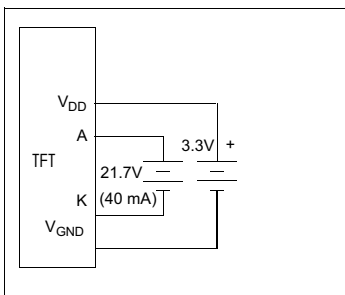

### Absolute Maximum Ratings

PARAMETER	SYMBOL	MIN	MAX	UNIT
SUPPLY VOLTAGE	V <sub>DD</sub>	-0.5	5.0	V
BACKLIGHT CURRENT (LED)	I <sub>LED</sub>	-	50	mA
INPUT VOLTAGE	V <sub>IN</sub>	-0.3	V <sub>DD</sub> +0.3	V
OPERATING TEMPERATURE	T <sub>OP</sub>	-20	70	°C
STORAGE TEMPERATURE	T <sub>STG</sub>	-30	80	°C

