

PowerLED

1W



- high luminosity
- high quality for professional application
- RoHS compliant
- reflow soldering
- with lens



Part Number	Colour	Wavelength	Intensity (lm)			Angle (deg)	Voltage (V)		Lens Colour
			min	typ	max		min	max	
PL4-NL01-G	warm white	2900-3000°K	60.0	---	80.0	125°	3.0	4.0	waterclear
PL4-SL01-E	natural white	3700-4000°K	70.0	---	90.0	125°	3.0	4.0	waterclear
PL4-WL01-C	white	4700-5000°K	91.0	---	154.0	125°	3.0	4.0	waterclear
PL4-WL01-A	white	6000-6500°K	91.0	---	154.0	125°	3.0	4.0	waterclear
PL4-BL01-00	blue	455-475 nm	---	22.0	---	125°	3.0	4.0	waterclear
PL4-GL01-00	green	520-535 nm	---	70.0	---	125°	3.0	4.0	waterclear
PL4-RL01-00	red	618-632 nm	---	48.0	---	125°	2.0	3.0	waterclear
PL4-YL01-00	yellow	585-595 nm	41.5	---	70.0	125°	2.0	3.0	waterclear

Electro-Optical-Characteristics Ta=25°C, Forward Current: IF Typical = 350mA,

1/10 Duty Cycle, 0.01ms Pulse Width: up to 1000mA, depending on colour
Storage Temp. -40 ~+100 (°C) Operating Temp. -40 ~+85 (°C)

Packaging: 500pcs./reel

Detailed data sheets are available on request

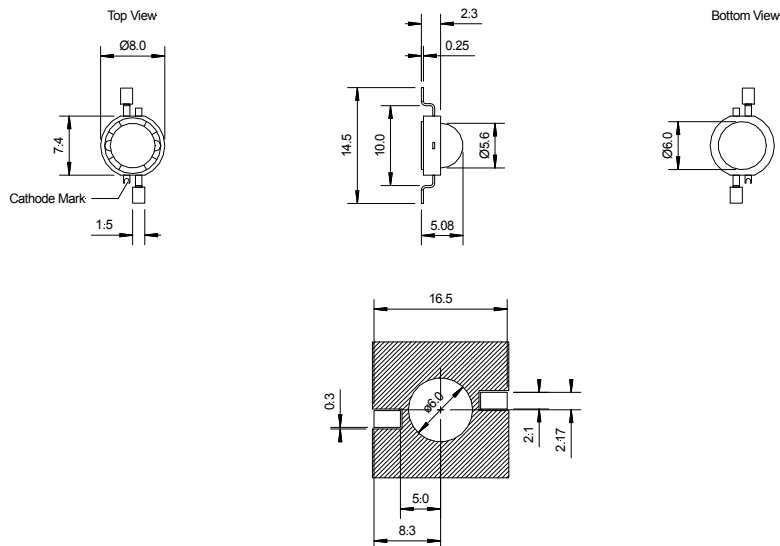

Do not drive at rated current more than 5 sec. without proper heat sink.

1. All specifications according to information from our manufacturers, without additional guarantee on our part
2. All dimensions are in millimetres
3. Tolerance is ±0.25mm unless otherwise specified
4. Specifications are subject to change without notice