

Through-hole LED

ø 3mm white



- high luminosity
- long lifetime up to 50'000 hours
- high quality for professional application
- RoHS compliant



Part Number	Colour Temp. (°K)	Intensity (mcd)			Angle (deg)	Voltage (V)		Lens Colour	Type
		min	typ	max		typ	max		
L3-W37N-BVW	5500-9000°	9480	13350	18960	20°	3.2	3.5	waterclear	1
L3-W36N-BVW	5500-9000°	4610	6510	9220	50°	3.2	3.5	waterclear	2
L3-W32N-BVW	5500-9000°	2520	3680	5040	60°	3.2	3.5	white diffused	2

Electro-Optical-Characteristics Ta=25°C, Forward Current: IF Typical = 20mA,

1/10 Duty Cycle, 10ms Pulse Width: up to 100mA, depending on type number.
Storage Temp. -40 ~+100 (°C) Operating Temp. -30 ~+85 (°C)

Detailed data sheets are available on request

Dimensions (mm)

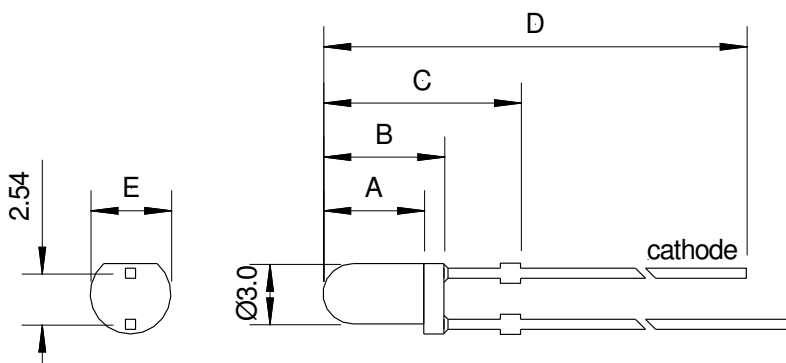

Type	A	B	C	D	E
1	5.0	6.0	11.0	27.5	3.8
2	4.4	5.4	10.4	26.9	3.8

1. All specifications according to information from our manufacturers, without additional guarantee on our part
2. All dimensions are in millimetres
3. Tolerance is ±0.25mm unless otherwise specified
4. Specifications are subject to change without notice