

## Through-hole LED

ø 3mm red



- high luminosity
- long lifetime up to 75'000 hours
- high quality for professional application
- application: TV set, Monitor, Computer, PC-Board
- RoHS compliant



Part Number	Peak Wavelength	Intensity (mcd)			Angle (deg)	Voltage (V)		Lens Colour	Type
		min	typ	max		min	typ		
L3-R33U	638 nm	2200	3200	4480	14°	2.25	2.5	waterclear	1
L3-R41Q	640 nm	1500	2500	4000	24°	1.7	2.4	waterclear	1
L3-R32U	635 nm	900	1600	2240	35°	2.0	2.5	waterclear	1
L3-R30U	635 nm	700	1000	1400	40°	2.0	2.5	waterclear	2
L3-R310-1	660 nm	40	80	110	15°	1.7	2.0	waterclear	3
L3-R301	700 nm	5	8	20	40°	2.2	2.6	red diffused	4

**Electro-Optical-Characteristics Ta=25°C, Forward Current: IF Typical = 20mA,**  
1/10-1/20 Duty Cycle, 0.1ms-10ms Pulse Width: up to 100mA, depending on type number.  
Storage Temp. -40 ~+100 (°C) Operating Temp. -40 ~+85 (°C)

Detailed data sheets are available on request

### Dimensions (mm)

Type	A	B	C	D	E
1	4.3	5.3	No stopper	29.7	3.8
2	3.4	4.4	No stopper	28.8	3.1
3	4.0	4.7	No stopper	32.0	3.8
4	4.5	5.3	No stopper	30.7	3.8

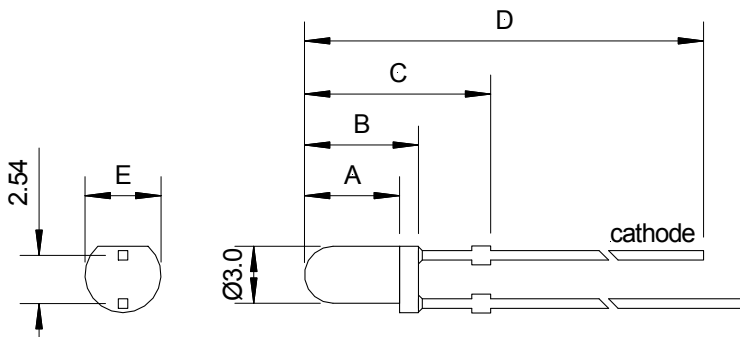

1. All specifications according to information from our manufacturers, without additional guarantee on our part
2. All dimensions are in millimetres
3. Tolerance is ±0.25mm unless otherwise specified
4. Specifications are subject to change without notice