

Through-hole LED

ø 3mm blue



- high luminosity
- long lifetime up to 75'000 hours
- high quality for professional application
- RoHS compliant



Part Number	Peak Wavelength	Intensity (mcd)			Angle (deg)	Voltage (V)		Lens Colour	Type
		min	typ	max		typ	max		
L3-B71G-WVV	● 470 nm	4400	6550	8750	15°	3.2	3.5	waterclear	1
L3-B41G-WTU	● 470 nm	1380	1920	2760	30°	3.2	3.5	waterclear	2
L3-B51G-WT	● 470 nm	820	960	1160	45°	3.6	4.0	waterclear	3

Electro-Optical-Characteristics Ta=25°C, Forward Current: IF Typical = 20mA,

1/10 Duty Cycle, 10ms Pulse Width: up to 110mA, depending on type number.

Storage Temp. -40 ~+100 (°C) Operating Temp. -30 ~+85 (°C)

Detailed data sheets are available on request

Dimensions (mm)

Type	A	B	C	D	E
1	5.0	6.0	11.0	27.5	3.8
2	4.4	5.4	10.4	26.9	3.8
3	4.0	5.0	9.7	26.2	3.8

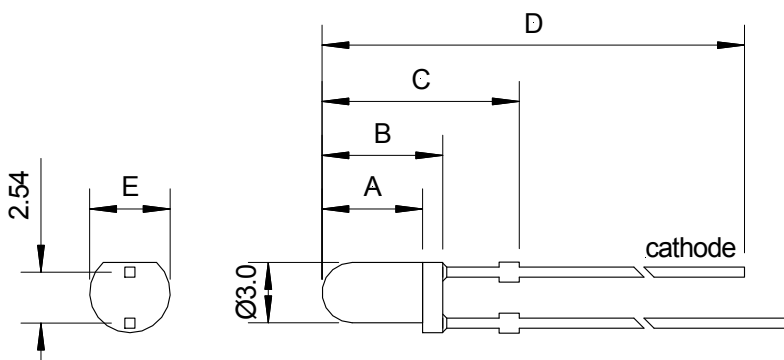

1. All specifications according to information from our manufacturers, without additional guarantee on our part
2. All dimensions are in millimetres
3. Tolerance is ±0.25mm unless otherwise specified
4. Specifications are subject to change without notice