

## Design Lamp "Quadro"

- with magnetic mounting
- 9 Power Led's for high intensity
- ultra flat execution only 12mm
- regulated current
- low generation of heat
- modern design
- non dimmable



Part-Number	Colour Temperature	Colour Rendering Index CRI	Lumen output	Luminous Efficacy
200 04 330A	typ. 3700 K	81 ± 3	(478 ± 19) lm	(73 ± 4) lm/W
200 04 331A	typ. 3100 K	86 ± 3	(398 ± 16) lm	(58 ± 3) lm/W

### Specification

Voltage:	10V – 32V DC
Performance:	7 Watt (290mA @ 24VDC)
Lightsources:	9 x 1W Power LED's warm-white
Cover:	Glass polished (6mm thickness)
Dimensions:	125 x 125 x 12 mm
Encapsulation:	IP65
Weight:	410g

### Dimensions

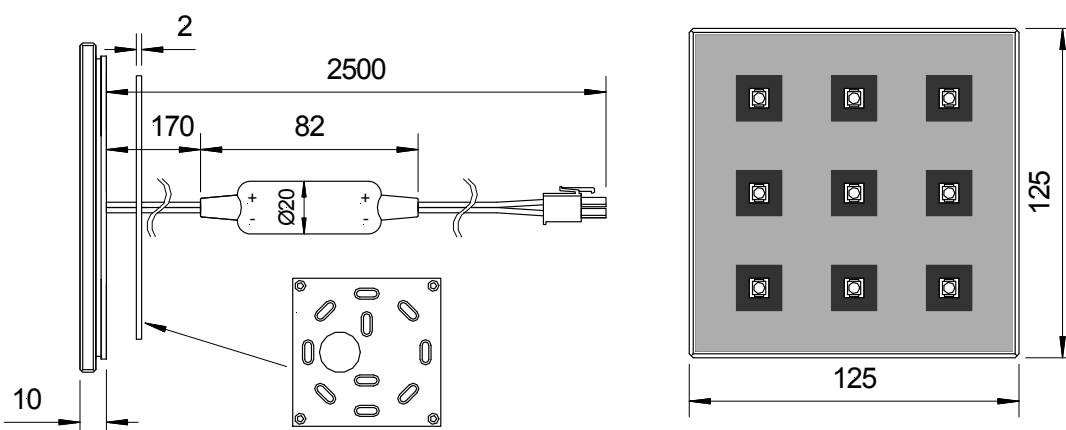

Adapter cable (enclosed):



### Polar diagram

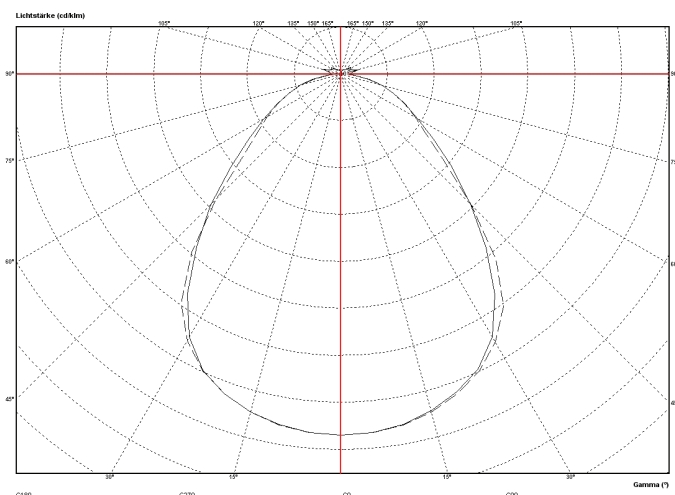

Easy installation with magnetic mount

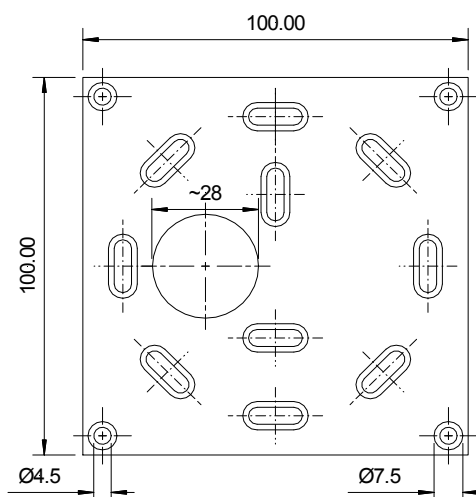

Mounting bracket

### Recommended Power Supply

117 00 007

for 1 – 3 lamps

### Dimensions

160 x 46 x 30 mm

117 00 008

for 1 – 6 lamps

182 x 62 x 35 mm



- All dimensions are in millimetres.
- Tolerance is  $\pm 0.25$ mm unless otherwise specified.
- Specifications are subject to change without notice