

# SPECIFICATION FOR APPROVAL

Product Name	MOLDED WIREWOUND CHIP INDUCTOR (LEAD FREE)	Page	1
Tai-Tech Part No.	WI322522 SERIES		

## 1. CONFIGURATION & DIMENSIONS :

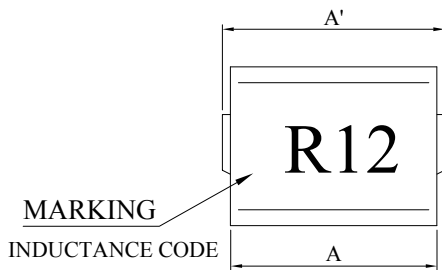

- A' : 3.2±0.4 mm
- A : 2.9±0.2 mm
- B : 2.5±0.2 mm
- C : 2.2±0.2 mm
- E : 1.0±0.3 mm
- F : 0.6±0.2 mm
- G : 1.8 REF mm
- H : 1.4 REF mm
- I : 1.0 REF mm

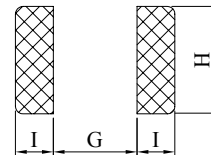
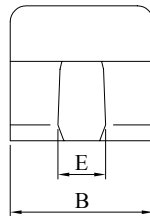
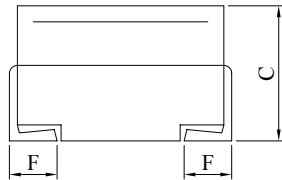

PCB PATTERN

## 2. SCHEMATIC DIAGRAM :

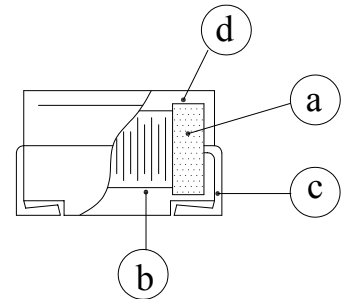
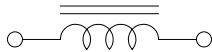

## 3. MATERIALS :

NO.	DESCRIPTION	SPECIFICATION	REMARK
a.	CORE	DR FERRITE CORE	
b.	WIRE	ENAMELLED COPPER WIRE	
c.	TERMINAL	TINNED COPPER PLATE	
d.	CAPSULATE	EPOXY NOVOLAC MOLDING COMPOUND	



**RoHS Compliant**

NOTE : Specifications subject to change without notice. Please check our website for latest information.

23.08.2007



TAI-TECH ADVANCED ELECTRONICS (S) PTE LTD

# SPECIFICATION FOR APPROVAL

Product Name	MOLDED WIREWOUND CHIP INDUCTOR (LEAD FREE)	Page	2
Tai-Tech Part No.	WI322522 SERIES		

## 4. GENERAL SPECIFICATION :

- a) TEMP. RISE : 20°C MAX
- b) AMBIENT TEMP. : 100°C MAX
- c) STORAGE TEMP. : -40°C ----- +125°C
- d) OPERATING TEMP. : -40°C ----- +125°C
- e) TERMINAL STRENGTH : 0.5 KG MIN
- f) RATED CURRENT : CURRENT CAUSE INDUCTANCE DROP WITHIN 10%
- g) RESISTANCE TO SOLDER HEAT : 260°C FOR 10 SECS.
- h) RESISTANCE TO SOLVENT : PER MIL-STD-202F

## 5. CHARACTERISTICS CURVE :

Peak Temp : 245°C max.  
Max time above 225°C : 30sec max.  
Max time above 200°C : 50sec max.

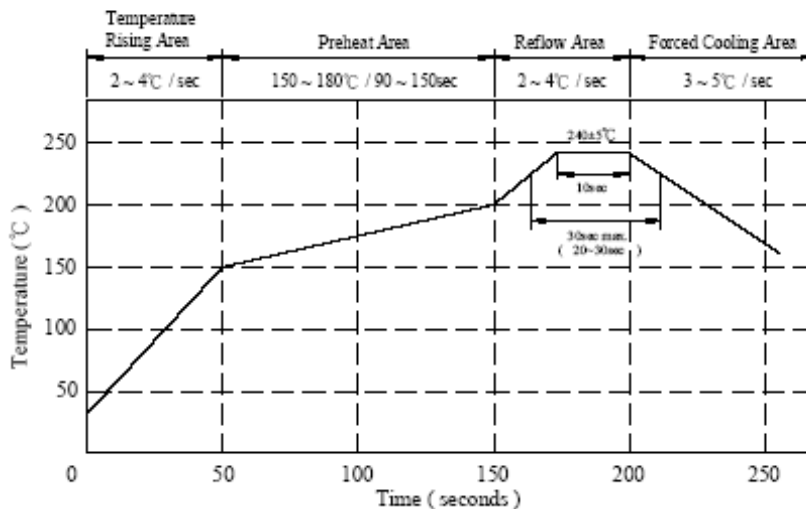

**RoHS Compliant**

NOTE : Specifications subject to change without notice. Please check our website for latest information.

23.08.2007



TAI-TECH ADVANCED ELECTRONICS (S) PTE LTD

# SPECIFICATION FOR APPROVAL

Product Name	MOLDED WIREWOUND CHIP INDUCTOR (LEAD FREE)	Page	3
Tai-Tech Part No.	WI322522 SERIES		

## 6. ELECTRICAL CHARACTERISTICS :

PART NO.	INDUCTANCE ( $\mu$ H)	Q MIN.	TEST FREQ. (MHz)	SRF (MHz) MIN	RDC ( $\Omega$ ) MAX	IDC (mA) MAX
WI322522-R10□F	0.10	28	100	700	0.440	450
WI322522-R12□F	0.12	30	25.2	500	0.220	450
WI322522-R15□F	0.15	30	25.2	450	0.250	450
WI322522-R18□F	0.18	30	25.2	400	0.280	450
WI322522-R22□F	0.22	30	25.2	350	0.320	450
WI322522-R27□F	0.27	30	25.2	320	0.360	450
WI322522-R33□F	0.33	30	25.2	300	0.400	450
WI322522-R39□F	0.39	30	25.2	250	0.450	450
WI322522-R47□F	0.47	30	25.2	220	0.500	450
WI322522-R56□F	0.56	30	25.2	180	0.550	450
WI322522-R68□F	0.68	30	25.2	160	0.600	450
WI322522-R82□F	0.82	30	25.2	140	0.650	450
WI322522-1R0□F	1.00	30	7.96	120	0.700	400
WI322522-1R2□F	1.20	30	7.96	100	0.750	390
WI322522-1R5□F	1.50	30	7.96	85	0.850	370
WI322522-1R8□F	1.80	30	7.96	80	0.900	350
WI322522-2R2□F	2.20	30	7.96	75	1.000	320
WI322522-2R7□F	2.70	30	7.96	70	1.100	290
WI322522-3R3□F	3.30	30	7.96	60	1.200	260
WI322522-3R9□F	3.90	30	7.96	55	1.300	250
WI322522-4R7□F	4.70	30	7.96	50	1.500	220
WI322522-5R6□F	5.60	30	7.96	45	1.600	200
WI322522-6R8□F	6.80	30	7.96	40	1.800	180
WI322522-8R2□F	8.20	30	7.96	35	2.000	170
WI322522-10□F	10.00	30	2.52	30	2.100	150
WI322522-12□F	12.00	30	2.52	20	2.500	140
WI322522-15□F	15.00	30	2.52	20	2.800	130
WI322522-18□F	18.00	30	2.52	20	3.300	120
WI322522-22□F	22.00	30	2.52	20	3.700	110
WI322522-27□F	27.00	30	2.52	20	5.000	80
WI322522-33□F	33.00	30	2.52	17	5.600	70
WI322522-39□F	39.00	30	2.52	16	6.400	65
WI322522-47□F	47.00	30	2.52	15	7.000	60
WI322522-56□F	56.00	30	2.52	13	8.000	55
WI322522-68□F	68.00	30	2.52	12	9.000	50
WI322522-82□F	82.00	30	2.52	11	10.000	45
WI322522-101□F	100.00	20	0.796	10	11.000	40
WI322522-121□F	120.00	20	0.796	8.0	12.000	70
WI322522-151□F	150.00	20	0.796	8.0	16.000	65
WI322522-181□F	180.00	20	0.796	6.0	17.000	60
WI322522-221□F	220.00	20	0.796	6.0	21.000	50

INDUCTANCE TOLERANCE :

- : J :  $\pm$ 5%
- K :  $\pm$ 10%
- M :  $\pm$ 20%



**RoHS Compliant**

NOTE : Specifications subject to change without notice. Please check our website for latest information.

23.08.2007



**TAI-TECH ADVANCED ELECTRONICS (S) PTE LTD**