

NOTES:

- 1. MATERIAL AND FINISH:
 CONTACT: BRASS, GOLD PLATED
 FERRULE: COPPER, GOLD PLATED
 INSULATORS: PTFE
 OTHER METAL PARTS: BRASS, GOLD PLATED

903-505J-51 S1		REVISIONS			
DRAWING NO.	REV	DESCRIPTION	DATE	ECO	APPR
THIRD ANGLE PROJ.	A	OFFICIAL ENG. RELEASE TO MFG.	1-17-95	40391	PB/
	B	REDRAWN, UPDATED	11/11/98	41234	PB/

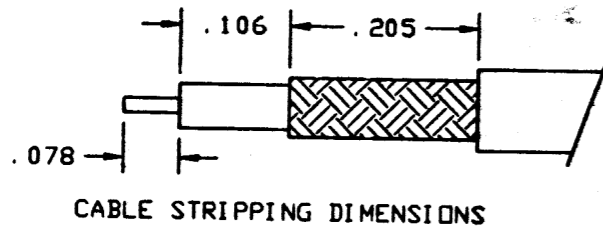
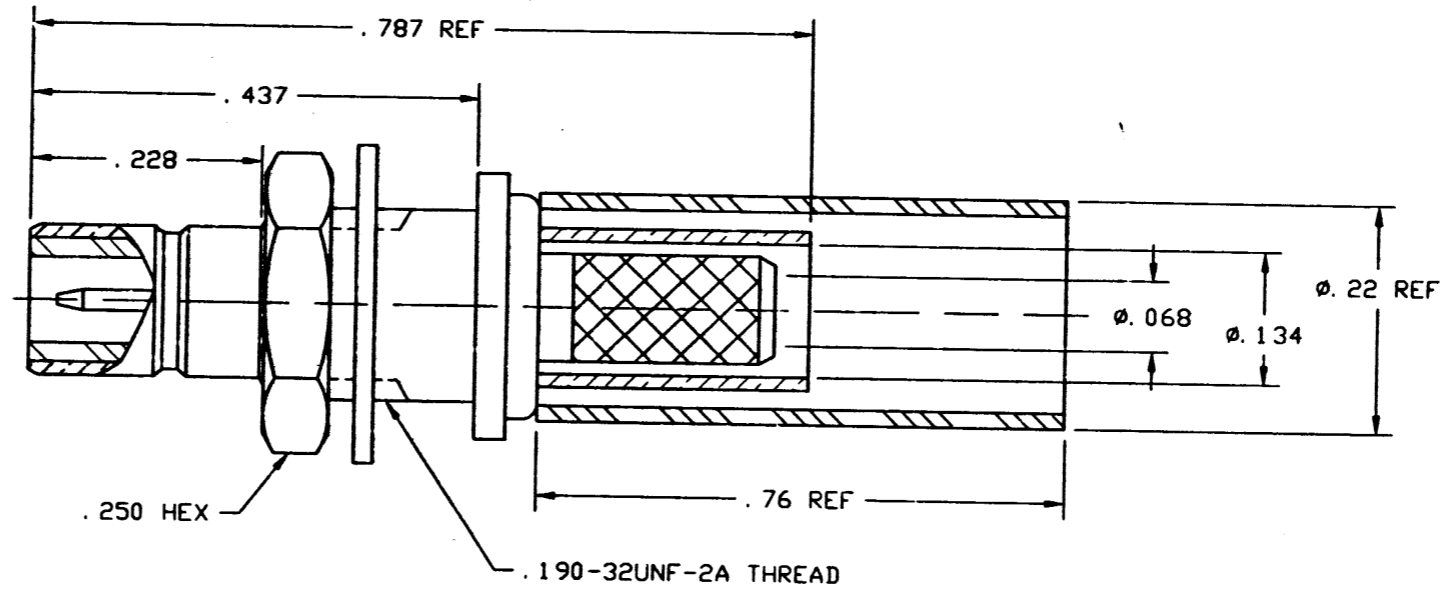
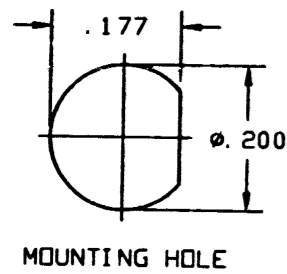

CUSTOMER DRAWING

UNLESS OTHERWISE SPECIFIED, DIMENSIONS ARE IN INCHES AND TOLERANCES ARE: 2 PLACE DECIMAL ±.015 (0,381 mm) 3 PLACE DECIMAL ±.005 (0,127 mm) ANGLES ± 1°	MATERIAL	DRAWN P. BRENZEL DATE 1-4-95 ENGINEER P. BRENZEL DATE 1-4-95 APPROVED DATE	TITLE	Amphenol Amphenol Corporation RF/Microwave Operations Danbury, Conn. U.S.A. 06810 SCALE: 6:1 SHEET 1 OF 2
	REFERENCE EAR 111-964556 EAR 107-966180	CAD FILE H: \PETE\SMB\903\ASSY\50551 S1C	CODE ID 74868 DWG SIZE B DRAWING NO. 903-505J-51 S1	