

A

A

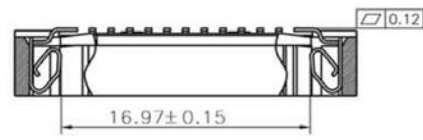

B

B

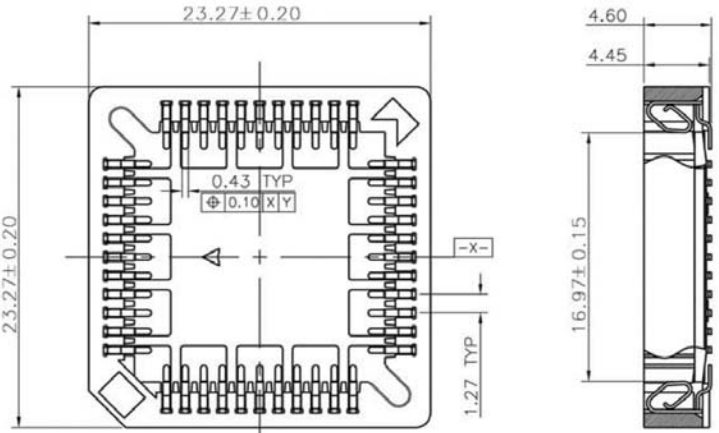

C

C

Materials:

- Insulator: PPS + 30%GF UL 94V-0
- Color: PBT Beige
- Contacts: Phosphor Bronze
- Terminal Thick: 0.17/0.20/0.25
- Contact Plating: Tin

D

D

Electrical:

- Rating Current: 1 Amp
- Rating Voltage: 250V AC/DC Max.
- Dielectric Withstanding: 500V AC at 1 Minute
- Contact Resistance: 30MΩ Max.
- Insulation Resistance: 1,000MΩ Min.
- Operating Temperature: -55°C ~ +105°C
- Retention Force: 0.30Kg per pin (Min.)

E

E

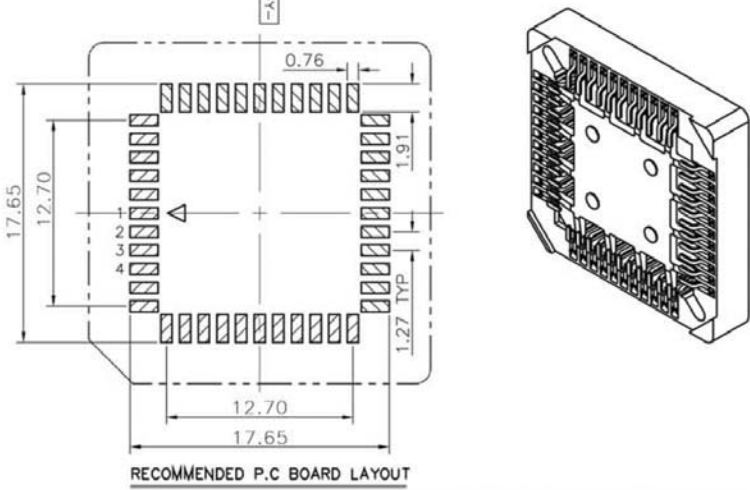

F

F

G

G

Scale	1:1						Name	Item No.
TOLERANCE						Drawn	11.08.11	A-CCS44-Z-SM-R
X.X	±0.40					Approved		
X.XX	±0.25							PLCC Socket 44 pin, Tin, SMT
X.XXX	±0.15							Drawing No.
Angle	±3°							rev00
								Replace
								Sheet
		Modification	Date	Name				



H

H