

PLC Series

HIGH CURRENT LEADED POWER LINE CHOKES

MoxiE's PLC series of radial leaded power line chokes offer a wide range of inductance values from 1.0 μ H to 5200 μ H. These coils are perfect for RFI suppression, switching regulators, filters, power supplies and power amplifiers.

Features

- RoHS Compliant.
- High Current Ratings.
- Low Cost.
- Custom Designs Available.
- Quick Turn Lead-times.

MoxiE
INDUCTOR CORPORATION



NOTES

- Inductance drop = 10% maximum at IDC.
- Inductance @ 1kHz, 1V.
- MoxiE available tolerances: K \pm 10% & M \pm 20%
- Coils finished with sleeving upon request.
- Center hole is designed for mechanical mounting.
- 100VAC RMS hi-pot.
- Spacer available at additional cost to facilitate PC board washing.
- Operating temperature: -40°C to 85°C.
- Temperature rise: 50°C maximum at IDC.
- MoxiE utilizes UL tubing on the PLC series to avoid damage during the wave soldering process.



MECHANICAL DIMENSIONS

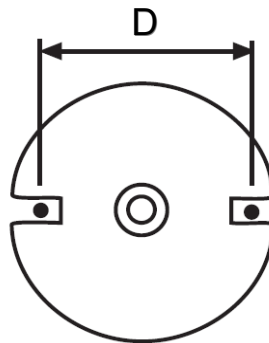
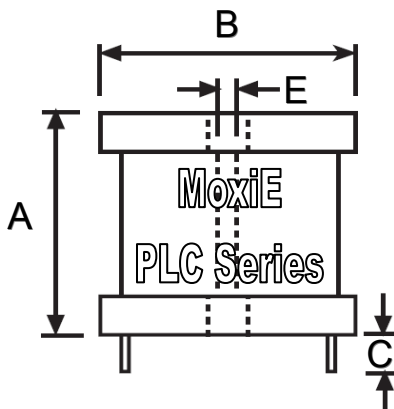

MoxiE Series	A	B	C	D Typ.	E Typ.
MOX-PLC-1722	17	22	15 \pm 2	12	3.0
MOX-PLC-2222	22	22	15 \pm 2	15	3.9
MOX-PLC-2822	28	22	15 \pm 2	22	4.8



ELECTRICAL SPECIFICATIONS

MoxiE Part Code	L (μH)	MOX-PLC-1722	MOX-PLC-1722	MOX-PLC-2222	MOX-PLC-2222	MOX-PLC-2822	MOX-PLC-2822
		DCR (Ω Max.)	IDC (A) Max.	DCR (Ω Max.)	IDC (A) Max.	DCR (Ω Max.)	IDC (A) Max.
1R0M	1.0	0.003	9.0	0.003	11.4	0.003	21
1R2M	1.2	0.003	9.0	0.003	11.4	0.003	21
1R5M	1.5	0.004	9.0	0.003	11.4	0.003	21
1R8M	1.8	0.004	9.0	0.003	11.4	0.003	21
2R2M	2.2	0.005	9.0	0.004	11.4	0.003	21
2R7M	2.7	0.005	9.0	0.005	11.4	0.003	21
3R3M	3.3	0.005	9.0	0.005	11.4	0.003	21
3R9M	3.9	0.006	9.0	0.005	11.4	0.003	21
4R7M	4.7	0.007	9.0	0.005	11.4	0.003	21
5R6M	5.6	0.007	9.0	0.006	11.4	0.003	21
6R8M	6.8	0.008	9.0	0.007	11.4	0.004	21
8R2M	8.2	0.009	9.0	0.007	11.4	0.004	21
100M	10	0.010	9.0	0.009	11.4	0.006	17
120K	12	0.011	9.0	0.009	11.4	0.008	13.5
150K	15	0.015	7.2	0.013	9.0	0.009	13.5
180K	18	0.016	7.2	0.018	7.2	0.010	13.5
220K	22	0.025	5.5	0.019	7.2	0.011	13.5
270K	27	0.030	4.5	0.026	5.5	0.012	13.5
330K	33	0.040	4.0	0.029	5.5	0.017	13.5
390K	39	0.046	4.0	0.030	5.5	0.022	11.4
470K	47	0.062	2.8	0.035	5.5	0.024	9.0
560K	56	0.069	2.8	0.039	5.5	0.026	9.0
680K	68	0.077	2.8	0.053	4.8	0.029	9.0
820K	82	0.083	2.8	0.060	4.8	0.032	9.0
101K	100	0.095	2.8	0.080	4.0	0.034	9.0
121K	120	0.127	2.0	0.090	4.0	0.046	7.2
151K	150	0.181	1.6	0.098	4.0	0.064	5.5
181K	180	0.217	1.6	0.110	4.0	0.072	5.5
221K	220	0.240	1.6	0.150	2.8	0.080	5.5
271K	270	0.300	1.6	0.213	2.0	0.110	4.5
331K	330	0.336	1.3	0.305	1.6	0.122	4.5
391K	390	0.460	1.0	0.320	1.6	0.169	4.0
471K	470	0.636	0.8	0.355	1.6	0.187	4.0
561K	560	0.696	0.8	0.388	1.6	0.205	4.0
681K	680			0.430	1.6	0.256	2.8
821K	820			0.590	1.3	0.288	2.8
102K	1000			0.818	1.0	0.426	2.0
122K	1200			1.140	0.8	0.462	2.0
152K	1500			1.260	0.8	0.518	2.0
182K	1800			1.390	0.8	0.705	1.6
222K	2200			1.540	0.8	1.020	1.3
272K	2700					1.140	1.3
332K	3300					1.270	1.3
392K	3900					1.670	1.0
472K	4700					1.860	1.0



ENGINEERING DATA

- RoHS Compliant.
- MoxiE Inductor Corporation specifications are subject to change without notice.