

MOX-SPIL-1306

MoxiE[®]
INDUCTOR CORPORATION

Surface Mount Shielded Power Inductors

MoxiE's SPIL-1306 series of surface mount shielded power inductors are widely used in PDA's, notebooks, LCD televisions and digital cameras.

Features:

- Low cost.
- Flat top for pick & place machines.
- Available tolerances: $\pm 20\%$.
- RoHS compliant.
- Magnetically shielded applications.
- MoxiE Inductor Corporation custom designs available.



NOTES



MECHANICAL DIMENSIONS

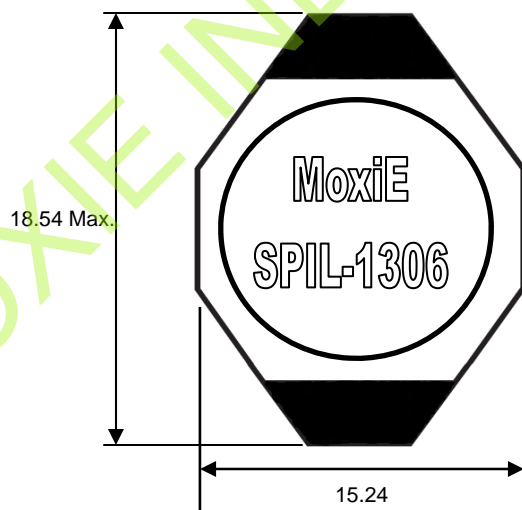

All dimensions in mm.

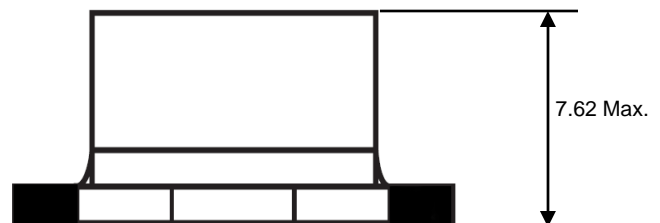

MoxiE Marking: Inductance & Tolerance



LANDING PATTERN

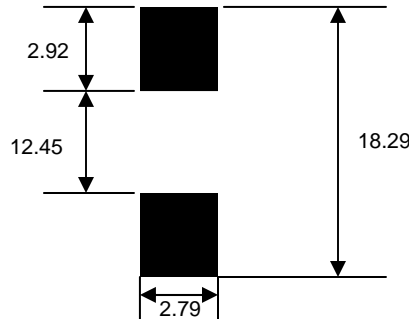

ELECTRICAL SPECIFICATIONS

MoxiE Part Number	Inductance (μH)	Tolerance (\pm)	DCR (Ω) Max.	SRF (MHz) Typ.	Isat (A)	Irms (A)
MOX-SPIL-1306-1R0M	1.0	20%	0.016	130.0	19.0	6.8
MOX-SPIL-1306-2R0M	2.2	20%	0.023	70.0	15.0	5.5
MOX-SPIL-1306-3R3M	3.3	20%	0.026	60.0	13.0	4.9
MOX-SPIL-1306-4R7M	4.7	20%	0.028	40.0	12.0	4.6
MOX-SPIL-1306-5R6M	5.6	20%	0.030	33.0	11.0	4.5
MOX-SPIL-1306-100M	10.0	20%	0.040	30.0	8.5	4.2
MOX-SPIL-1306-150M	15.0	20%	0.048	20.0	7.5	3.7
MOX-SPIL-1306-220M	22.0	20%	0.059	18.0	6.5	3.2
MOX-SPIL-1306-330M	33.0	20%	0.075	14.0	5.5	2.9
MOX-SPIL-1306-470M	47.0	20%	0.097	10.0	4.5	2.7
MOX-SPIL-1306-680M	68.0	20%	0.138	9.0	3.5	2.4
MOX-SPIL-1306-101M	100.0	20%	0.207	7.0	2.7	1.9
MOX-SPIL-1306-151M	150.0	20%	0.293	6.0	2.4	1.5
MOX-SPIL-1306-221M	220.0	20%	0.47	5.0	2.1	1.4
MOX-SPIL-1306-271M	270.0	20%	0.64	4.5	1.5	0.98
MOX-SPIL-1306-331M	330.0	20%	0.78	4.0	1.2	0.88
MOX-SPIL-1306-471M	470.0	20%	1.08	3.00	1.15	0.76
MOX-SPIL-1306-681M	680.0	20%	1.40	2.5	0.98	0.67
MOX-SPIL-1306-821M	820.0	20%	1.70	2.2	0.90	0.59
MOX-SPIL-1306-102M	1000.0	20%	2.01	2.0	0.85	0.56



MOX-SPIL-1306 ENGINEERING NOTES

- Measuring Frequency (L) 100 kHz
- Available Tolerances: M= $\pm 20\%$
- RoHS Compliant.
- Operating Temperature: -40°C to $+85^\circ\text{C}$.
- Magnetically shielded to prevent noise radiation.
- MoxiE Inductor Corporation specifications are subject to change without notice.