

MOX-SPIL-0402

MoxiE
INDUCTOR CORPORATION

Surface Mount Shielded Power Inductors

MoxiE's SPIL-0402 series of surface mount shielded power inductors are widely used in PDA's, notebooks, LCD televisions and digital cameras.

Features :

- Low cost.
- Flat top for pick & place machines.
- Available Tolerances: $\pm 10\%$ & $\pm 20\%$.
- RoHS compliant.
- Magnetically shielded applications.



NOTES



MECHANICAL DIMENSIONS

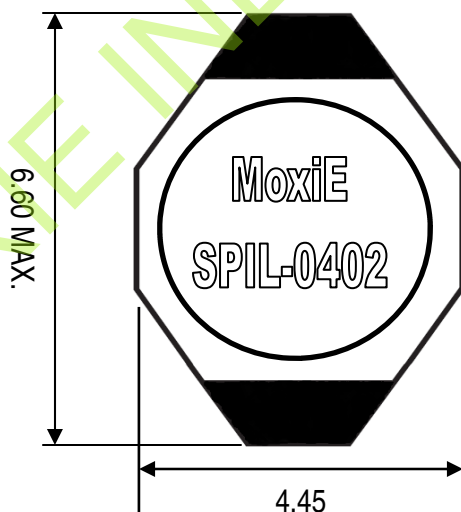

All dimensions in mm.

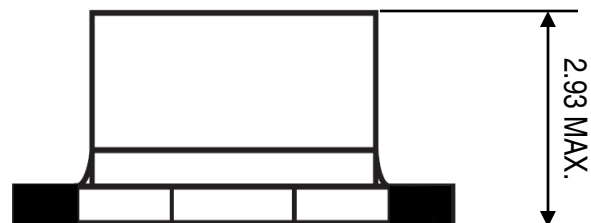

Marking: Inductance & Tolerance



LANDING PATTERN

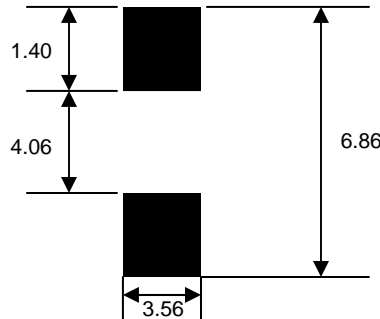

ELECTRICAL SPECIFICATIONS

MoxiE Part Number	Inductance (μH)	Tolerance (%)	DCR (Ω) Maximum	I _{rms} Max. (A)	L Test Frequency
MOX-SPIL-0402-1R0M	1.0	20% (M)	0.040	3.00	100 kHz
MOX-SPIL-0402-1R5M	1.5	20% (M)	0.045	2.80	100 kHz
MOX-SPIL-0402-2R2M	2.2	20% (M)	0.050	1.80	100 kHz
MOX-SPIL-0402-3R3M	3.3	20% (M)	0.055	1.60	100 kHz
MOX-SPIL-0402-4R7M	4.7	20% (M)	0.065	1.40	100 kHz
MOX-SPIL-0402-6R8M	6.8	20% (M)	0.070	1.20	100 kHz
MOX-SPIL-0402-100M	10	20% (M)	0.075	1.00	100 kHz
MOX-SPIL-0402-150M	15	20% (M)	0.090	0.80	100 kHz
MOX-SPIL-0402-220M	22	20% (M)	0.11	0.70	100 kHz
MOX-SPIL-0402-330M	33	20% (M)	0.19	0.60	100 kHz
MOX-SPIL-0402-470M	47	20% (M)	0.23	0.50	100 kHz
MOX-SPIL-0402-680M	68	20% (M)	0.29	0.40	100 kHz
MOX-SPIL-0402-101M	100	20% (M)	0.48	0.30	100 kHz
MOX-SPIL-0402-151M	150	20% (M)	0.59	0.26	100 kHz
MOX-SPIL-0402-221M	220	20% (M)	0.90	0.22	100 kHz
MOX-SPIL-0402-331M	330	20% (M)	1.40	0.20	100 kHz
MOX-SPIL-0402-471M	470	20% (M)	1.80	0.19	100 kHz
MOX-SPIL-0402-681M	680	20% (M)	2.20	0.18	100 kHz
MOX-SPIL-0402-102M	1000	20% (M)	4.20	0.15	100 kHz
MOX-SPIL-0402-152M	1500	20% (M)	4.20	0.12	100 kHz
MOX-SPIL-0402-222M	2200	20% (M)	8.50	0.10	100 kHz
MOX-SPIL-0402-332M	3300	20% (M)	11.00	0.08	100 kHz
MOX-SPIL-0402-472M	4700	20% (M)	13.90	0.06	100 kHz
MOX-SPIL-0402-682M	6800	20% (M)	25.00	0.04	100 kHz
MOX-SPIL-0402-103M	10000	20% (M)	32.80	0.02	100 kHz



MOX-SPIL-0402 ENGINEERING NOTES

- Measuring Frequency (L) 100 Khz, 0.1 Vrms.
- Packaging: Tape & Reel
- RoHS Compliant.
- Operating Temperature: -40°C to +85°C.
- Magnetically shielded to prevent noise radiation.
- MoxiE Inductor Corporation specifications are subject to change without notice.