

# MOX-SPI-0502



## Surface Mount Shielded Power Inductors

MoxiE's SPI-0502 series of surface mount shielded power inductors are widely used in PDA's, notebooks, LCD televisions and digital cameras. MoxiE offers a ultra low profile magnetically shielded package that offer high inductance & high power.

### Features:

- Low cost.
- Operating temperature: -40°C to +105°C.
- Available Tolerances:  $\pm 20\%$ .
- RoHS Compliant.
- Magnetically shielded applications.



## NOTES

---

---

---

---

---

---

---

---

---

---



## MECHANICAL DIMENSIONS

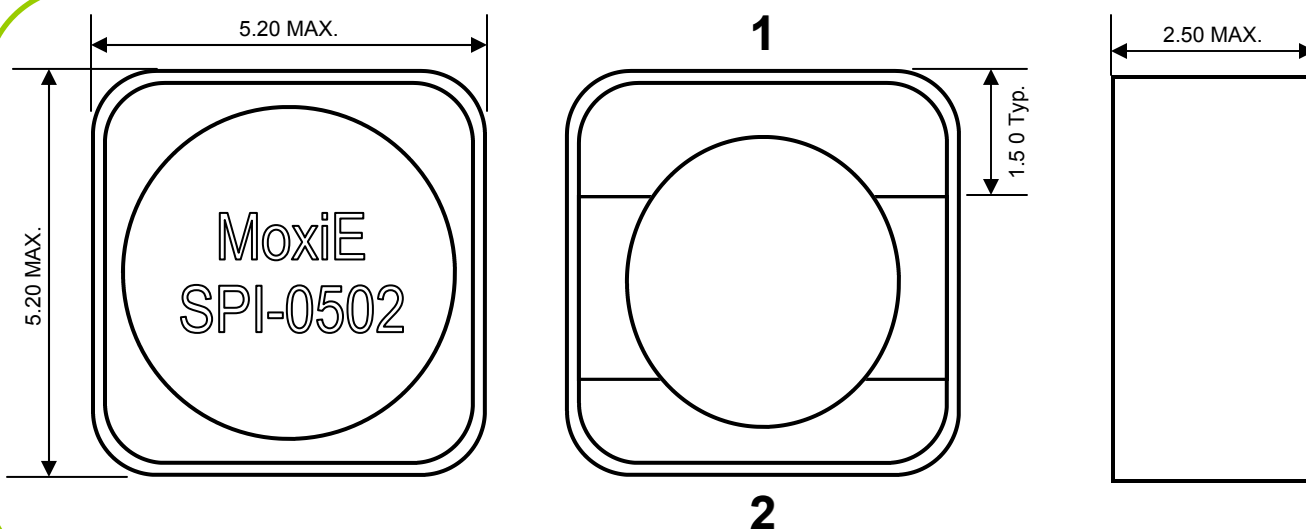



## LANDING PATTERN & SCHEMATIC

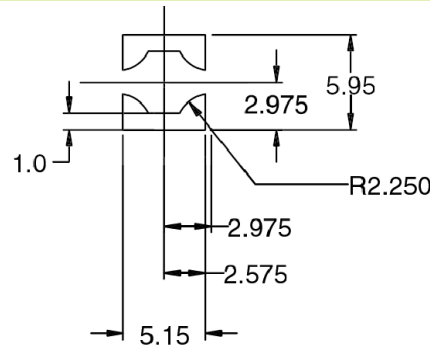
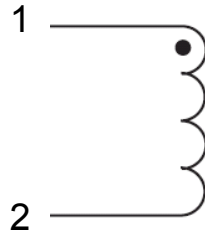

## ELECTRICAL SPECIFICATIONS

Part Number	Inductance (µH)	Tolerance (%)	IRMS (A) <sup>1</sup>	ISAT (A) <sup>2</sup>	DCR (Ω)* Typ.	L Test Frequency
MOX-SPI-0502-R47M	0.47	20% (M)	3.88	6.00	0.017	100 KHz
MOX-SPI-0502-R82M	0.82	20% (M)	3.59	4.67	0.021	100 KHz
MOX-SPI-0502-1R2M	1.20	20% (M)	3.34	3.82	0.024	100 KHz
MOX-SPI-0502-1R5M	1.50	20% (M)	3.15	3.24	0.027	100 KHz
MOX-SPI-0502-2R2M	2.20	20% (M)	2.95	2.81	0.031	100 KHz
MOX-SPI-0502-3R3M	3.30	20% (M)	2.65	2.23	0.038	100 KHz
MOX-SPI-0502-4R7M	4.70	20% (M)	2.40	1.85	0.047	100 KHz
MOX-SPI-0502-6R8M	6.80	20% (M)	2.20	1.57	0.055	100 KHz
MOX-SPI-0502-8R2M	8.20	20% (M)	1.93	1.46	0.072	100 KHz
MOX-SPI-0502-100M	10.0	20% (M)	1.82	1.28	0.082	100 KHz
MOX-SPI-0502-150M	15.0	20% (M)	1.68	1.09	0.096	100 KHz
MOX-SPI-0502-220M	22.0	20% (M)	1.35	0.86	0.147	100 KHz
MOX-SPI-0502-330M	33.0	20% (M)	1.13	0.71	0.215	100 KHz
MOX-SPI-0502-470M	47.0	20% (M)	0.92	0.59	0.316	100 KHz
MOX-SPI-0502-680M	68.0	20% (M)	0.75	0.48	0.485	100 KHz
MOX-SPI-0502-820M	82.0	20% (M)	0.72	0.44	0.525	100 KHz
MOX-SPI-0502-101M	100.0	20% (M)	0.67	0.40	0.593	100 KHz
MOX-SPI-0502-151M	150.0	20% (M)	0.56	0.33	0.872	100 KHz
MOX-SPI-0502-221M	220.0	20% (M)	0.45	0.27	1.34	100 KHz
MOX-SPI-0502-331M	330.0	20% (M)	0.36	0.22	2.08	100 KHz
MOX-SPI-0502-471M	470.0	20% (M)	0.29	0.18	3.11	100 KHz
MOX-SPI-0502-681M	680.0	20% (M)	0.26	0.15	3.89	100 KHz
MOX-SPI-0502-821M	820.0	20% (M)	0.23	0.14	5.05	100 KHz
MOX-SPI-0502-102M	1000.0	20% (M)	0.22	0.13	5.72	100 KHz



## MOX-SPI-0502 ENGINEERING NOTES

- <sup>1</sup>RMS current for an approximate  $\Delta T$  of 40°C without core loss. Not to exceed 125°C.
- <sup>2</sup>Peak current for approximate 30% roll off at 20°C
- Electrical specifications are at 25°C.
- DCR limits at 20°C.
- Packaging: Tape & Reel.