

MOX-SLI-5012

MoxiE[®]
INDUCTOR CORPORATION

Surface Mount Ultra Low Profile Shielded Inductors

MoxiE's MOX-SLI-5012 of surface mount shielded inductors are engineered for high current power line applications.

- Low cost.
- Magnetically shielded construction.
- Ultra low profile package.
- Operating temperature: -40°C to +105°C.
- Excellent solderability & resistance to soldering heat.
- RoHS compliant.



PART NUMBERS

MOXIE PART NUMBER	A	B	C (MAX.)	D (TYP.)	E (TYP.)
MOX-SLI-5012	5.00 ± 0.2	5.00 ± 0.3	1.20	2.70	1.10



MECHANICAL DIMENSIONS

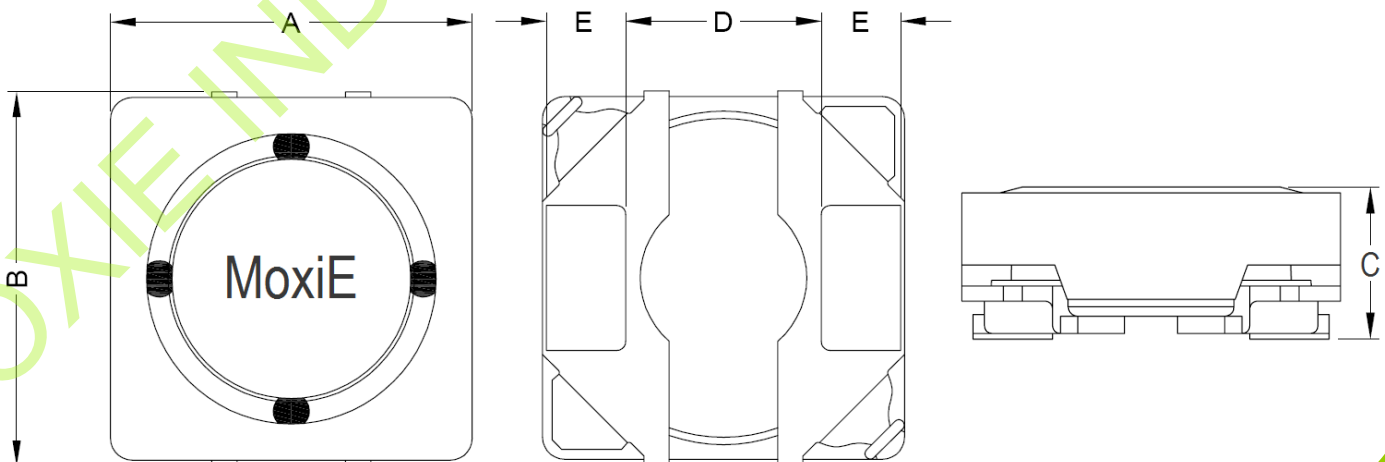



ELECTRICAL SPECIFICATIONS

MoxiE Part Number	Inductance (uH)	Test Frequency	RDC (mΩ) ±20%	IDC1 (A)	IDC2 (A)
MOX-SLI-5012-1R0N	1.0±30%	0.1V/100KHz	42.0	2.70	2.40
MOX-SLI-5012-1R5N	1.5±30%	0.1V/100KHz	50.0	2.20	2.10
MOX-SLI-5012-2R2N	2.2±30%	0.1V/100KHz	70.0	1.80	1.75
MOX-SLI-5012-3R3N	3.3±30%	0.1V/100KHz	79.0	1.60	1.55
MOX-SLI-5012-4R7M	4.7±20%	0.1V/100KHz	118.0	1.40	1.35
MOX-SLI-5012-6R8M	6.8±20%	0.1V/100KHz	145.0	1.10	1.20
MOX-SLI-5012-100M	10±20%	0.1V/100KHz	215.0	0.85	1.10
MOX-SLI-5012-150M	15±20%	0.1V/100KHz	315.0	0.75	0.95
MOX-SLI-5012-220M	22±20%	0.1V/100KHz	420.0	0.58	0.75
MOX-SLI-5012-330M	33±20%	0.1V/100KHz	660.0	0.47	0.55
MOX-SLI-5012-470M	47±20%	0.1V/100KHz	1020.0	0.35	0.45

MOXIE ENGINEERING NOTES:

- IDC1: BASED ON INDUCTANCE CHANGE (AL/Lo: <30%) @ AMBIENT TEMPERATURE OF +25°C.
- IDC2: BASED ON TEMPERATURE RISE (ΔT: +40°C TYPICAL)
- MOXIE INDUCTOR CORPORATION CUSTOM INDUCTANCE VALUES AVAILABLE.—CONTACT MOXIE FOR SPECIAL REQUESTS.
- OPERATING TEMPERATURE: -40°C TO +105°C. (INCLUDING SELF TEMPERATURE RISE.)
- RoHS COMPLIANT.
- MOXIE INDUCTOR CORPORATION SPECIFICATIONS ARE SUBJECT TO CHANGE WITHOUT NOTICE.
- MOXIE INDUCTOR CORPORATION CUSTOM DESIGNED PRODUCT(S) ARE SUBJECT TO UNITED STATES PATENT AND OR COPYRIGHT PROTECTION(S).



LANDING PATTERNS

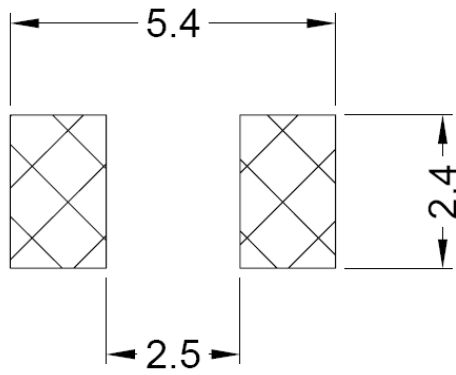

PCB PATTERN 1

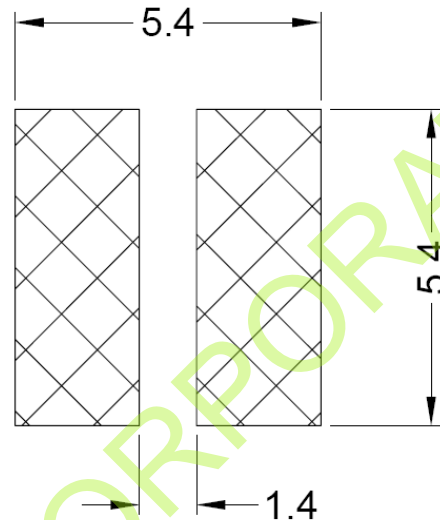

PCB PATTERN 2



MATERIALS

WIRE	CORE	TERMINAL CLIP	ADHESIVE	INK MARKING
POLYURETHANE ENAMELLED COPPER WIRE	FERRITE	C5191	RoHS EPOXY	70000-00101

MOXIE ENGINEERING NOTES:

- IDC1: BASED ON INDUCTANCE CHANGE (AL/L₀: <30%) @ AMBIENT TEMPERATURE OF +25°C.
- IDC2: BASED ON TEMPERATURE RISE (ΔT: +40°C TYPICAL)
- MOXIE INDUCTOR CORPORATION CUSTOM INDUCTANCE VALUES AVAILABLE.—CONTACT MOXIE FOR SPECIAL REQUESTS.
- OPERATING TEMPERATURE: -40°C TO +105°C. (INCLUDING SELF TEMPERATURE RISE.)
- RoHS COMPLIANT.
- MOXIE INDUCTOR CORPORATION SPECIFICATIONS ARE SUBJECT TO CHANGE WITHOUT NOTICE.
- MOXIE INDUCTOR CORPORATION CUSTOM DESIGNED PRODUCT(S) ARE SUBJECT TO UNITED STATES PATENT AND OR COPYRIGHT PROTECTION(S).