

YYWW = date code

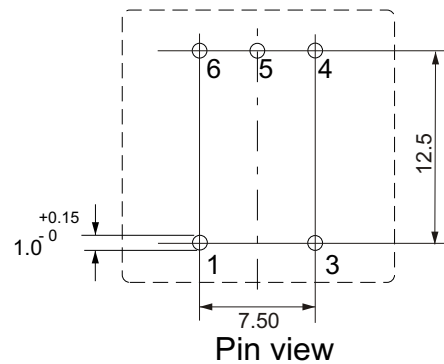

Pin view

Pin diameter = 0.6mm

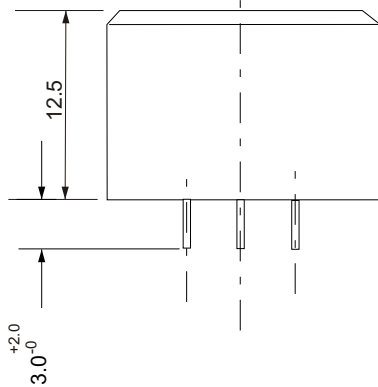
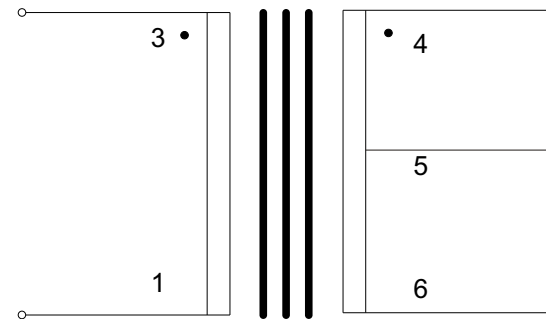

Tolerance on all dimensions +/-0.2mm unless stated otherwise

Specification:

Primary DC resistance: $658\Omega \pm 15\%$
 Secondary DC resistance: $837\Omega \pm 15\%$
 Impedance ratio (10k to 10k): 1 to 1 C.T. (centre tap)

Power handling:

100Hz - 25kHz 2mW/10k Ω for <1% THD at 100Hz
 Frequency response at 2mW: 100Hz - 25kHz +/- 0.7dB
 Frequency response at 0.2mW: 80Hz - 25kHz +/- 0.9dB
 THD at levels below saturation typically <0.02%

Primary inductance (100mVrms, 100Hz series) pins 3 - 1: 100H nom.

Turns ratio (@ 6kHz, 0.1Vrms) pins 3 - 1 & 4 - 6: 1 to 1 (+/- 1%)
 Hi-pot, primary to secondary: 500VAC, 1mA for 1 minute

Note: Do not pass DC current through windings.
 Operating temperature range: 0 to + 70°C
 Storage temperature range: -40°C to +125°C

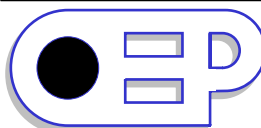

Unit 5, Oxonian Park, Langford Locks,
 Kidlington, Oxfordshire. OX5 1FP
 Tel: (01865) 855085 Fax: (01865) 855075
 Website: www.oep.co.uk

DESCRIPTION	ISSUE	DATE	DRAWN	CHECKED	DRAWING NUMBER
Specification for Z1643E	1	02/07/08	CS		Z1643E
	2	03/07/08	CS		
	3	05/03/12	CS		
	4	28/01/13	CS		

Scale: 2:1

All dimensions in mm unless stated otherwise