

## CHARACTERISTICS

- Glass length of 12 mm and diameter of 2.0 mm
- Normally open 1 Form A contact
- Excellent for low level applications

## DIMENSIONS

All dimensions in mm [inches]

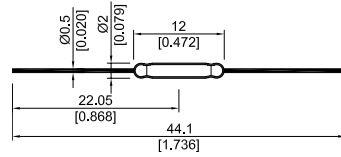

## CONTACT DATA

All Data at 20 °C	Switch Model → Contact Form →	KSK-1A46-... Form A			
Contact Ratings	Conditions	Min.	Typ.	Max.	Units
Switching Power*	Any DC combination of V and A not to exceed their individual max.'s			10	W
Switching Voltage	DC or peak AC			200	V
Switching Current	DC or peak AC			0.5	A
Carry Current	DC or peak AC			1.0	A
Static Contact Resistance	at 0.5 V & 10 mA			150	mΩ
Dynamic Contact Resistance	measured w/ 0.5 V & 50 mA, 1.5 ms after closure			200	mΩ
Insulation Resistance cross Contacts	100 Volts applied	10 <sup>12</sup>			Ω
Breakdown Voltage	> 60 sec.	225			VDC
Operate Time incl. Bounce	100 % overdrive			0.7	ms
Release Time	measured with/ no coil suppression			0.1	ms
Capacitance	at 10 kHz across contact		0.2		pF
Test Coil		KMS-01			
Standard AT range		10		40	AT
<b>Environmental Data</b>					
Shock Resistance	1/2 sine wave for 11 ms			50	g
Vibration Resistance	10 - 2000 Hz			20	g
Ambient Temperature	max. 10 °C / minute allowance	-20		130	°C
Stock Temperature	max. 10 °C / minute allowance	-55		130	°C
Soldering Temperature	5 sec. dwell			260	°C
Note: The indicated electric data are maximum values can vary downwards when using a more sensitive switch. * For life expectancy, please see the "Life Requirements" section.					

## ORDER INFORMATION

**Part Number Example** - KSK - 1A46 - 1015

**1015** is the AT range (Any AT can be ordered between 10 & 40 in a minimum range of 2 AT)

Series	Contact Form	Switch Model	AT Range (between)
KSK -	1A	46 -	xxxx
Options			10 -40