

Part Number HSR-102R Contact Form A Switch Configuration SPST Rev. E

Industry Standard Form A Switch

Features	Advantages
<ul style="list-style-type: none"> • Hermetically sealed contacts • Optimal glass size to wire ratio • AC rating: 120 VAC • Switch materials are Lead free and RoHS compliant 	<ul style="list-style-type: none"> • Extended operations in extreme environments • Not ESD Sensitive • Outstanding durability • Highly shock/vibration resistant • Available in RF version • Ideal for proximity sensors

Electrical Specifications

Power		Watts - maximum	10
Voltage	Switching	VDC - maximum	200
	Breakdown	VDC - minimum	300
Current	Switching		0.5
	Carry		1.8
Resistance	Initial Contact Resistance	Ohm - maximum	0.10
	Insulation Resistance	Ohm - minimum	1 E10
Capacitance	Contact	pF - typical	0.4
Temperature	Operating	°C	-40 to +125
	Storage	°C	-40 to +200

Magnetic Specifications

Pull - In Range		Ampere Turns	10-45
Test Coil		NARM RS-421-A	Coil II

Physical/Operational Specifications

Capsule Volume	Excluding Leads	CC - nominal	0.15
Contact Material			Rhodium
Operate Time	Including Bounce	mSeconds - maximum	0.70
Release Time		mSeconds - maximum	0.40

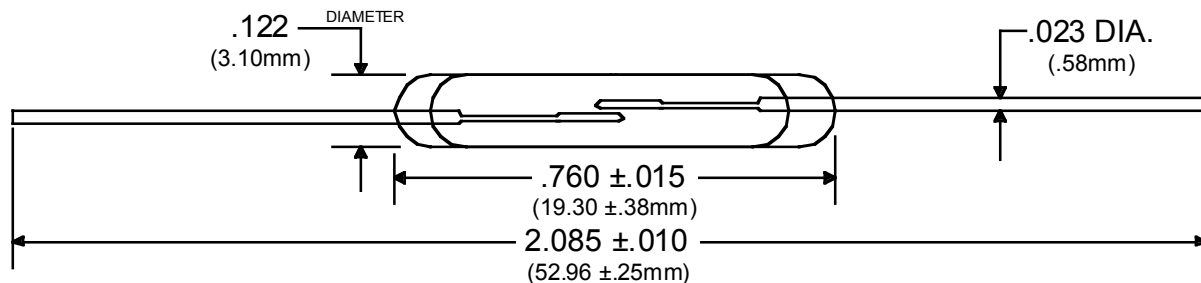

Notes:

- (1) Specifications are not constant across entire magnetic range.
- (2) Customer must exercise care in handling, mounting, lead forming, and cutting to prevent damage to glass capsule and/or switch sensitivity.
- (3) For information or custom configurations about performance, mounting options or packaging, contact our Sales (4) department.

Information contained hereon is for informational purposes only and should not be deemed as accurate for a specific application. Consult factory for specific application information and/or latest revision.