

Part Number HSR-900R Contact Form A Switch Configuration SPST Rev. G

Excellent Voltage Holdoff in a Small Capsule

Features	Advantages
<ul style="list-style-type: none"> Hermetically sealed contacts Rhodium contacts in vacuum environment Leaded glass currently exempted from RoHS requirements 	<ul style="list-style-type: none"> Not ESD sensitive Voltage holdoff increases at upper end of pull-in range High voltage holdoff and switching ability Extended operations in extreme environments Available in RF version

Electrical Specifications

Power		Watts - maximum	25
Voltage	Switching	VDC - maximum	500
	Breakdown	VDC - minimum	1500
Current	Switching		1
	Carry		2.2
Resistance	Initial Contact Resistance	Ohm - maximum	0.15
	Insulation Resistance	Ohm - minimum	1 E11
Capacitance	Contact	pF - typical	0.6
Temperature	Operating	°C	-60 to +125
	Storage	°C	-100 to +200

Magnetic Specifications

Pull - In Range		Ampere Turns	15-40
Test Coil		NARM RS-421-A	Coil II

Physical/Operational Specifications

Capsule Volume	Excluding Leads	CC - nominal	0.12
Contact Material			Rhodium
Operate Time	Including Bounce	mSeconds - maximum	1.10
Release Time		mSeconds - maximum	0.90

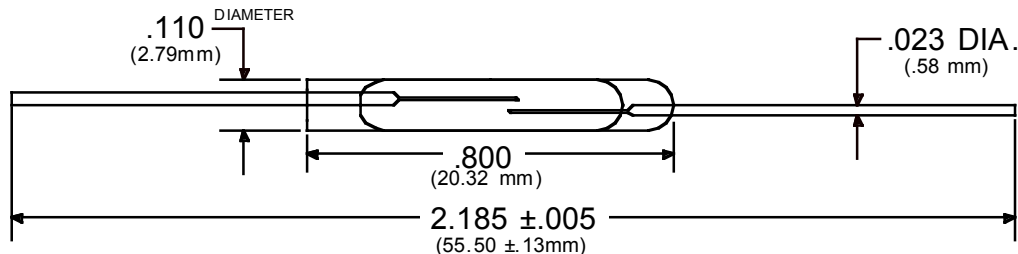

Notes:

- (1) Specifications are not constant across entire magnetic range.
- (2) Customer must exercise care in handling, mounting, lead forming, and cutting to prevent damage to glass capsule and/or switch sensitivity.
- (3) For information or custom configurations about performance, mounting options or packaging, contact our Sales (4) department.

Information contained hereon is for informational purposes only and should not be deemed as accurate for a specific application. Consult factory for specific application information and/or latest revision.