

Part Number HSR-790W Contact Form A witch Configuration SPST Rev. G

50W Power Rated Switch

Features	Advantages
<ul style="list-style-type: none"> Hermetically sealed contacts Switch materials are Lead free and RoHS compliant Tungsten contacts in pressurized internal environment Drop Out will not exceed 55% of Pull In 	<ul style="list-style-type: none"> Not ESD sensitive Suitable for high/inductive current loads Extended operations in extreme environments Arc extinguishing atmosphere

Electrical Specifications

Power		Watts - maximum	50
Voltage	Switching	VDC - maximum	1000
	Breakdown	VDC - minimum	2500
Current	Switching		2.5
	Carry		6.1
Resistance	Initial Contact Resistance	Ohm - maximum	0.10
	Insulation Resistance	Ohm - minimum	1 E8
Capacitance	Contact	pF - typical	1.1
Temperature	Operating	°C	0 to +125
	Storage	°C	-40 to +200

Magnetic Specifications

Pull - In Range		Ampere Turns	60-100
Test Coil		NARM RS-421-A	Coil IV

Physical/Operational Specifications

Capsule Volume	Excluding Leads	CC - nominal	1.09
Contact Material			Tungsten
Operate Time	Including Bounce	mSeconds - maximum	3.00
Release Time		mSeconds - maximum	1.60

Glass contents under pressure. Eye protection required when handling.

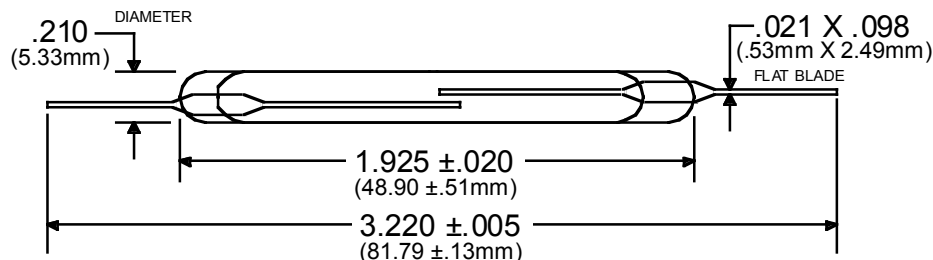

Notes:

- (1) Specifications are not constant across entire magnetic range.
- (2) Customer must exercise care in handling, mounting, lead forming, and cutting to prevent damage to glass capsule and/or switch sensitivity.
- (3) For information or custom configurations about performance, mounting options or packaging, contact our Sales (4) department.

Information contained hereon is for informational purposes only and should not be deemed as accurate for a specific application. Consult factory for specific application information and/or latest revision.