

## Data sheet

### Rotary knob switches

### Serie 419



#### Type 419

Basic design: width 19,4 mm, plastic moduled spindle diameter 6 mm

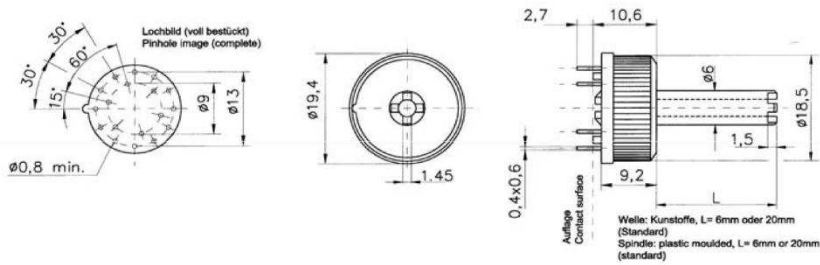

#### Technical Data

Switch resistance initial value	$\leq 25 \text{ m } \Omega$	Switching mode	non shorting (white bottom plate) shorting (black bottom plate)
Switch resistance after 15 000 cycles	$\leq 50 \text{ m } \Omega$	Number of wafers	1 / single wafer
Insulation resistance	$1 \times 10^9 \Omega$	Indexing angle	$30^\circ$
Test voltage	1 kV- / 1kV DC	Stops	fixed or without stop
Switching voltage	max. 150 V DC / AC	Operating torque	2 – 4,5 Ncm
Switching current	max. 130 mA, Ag plated	Solder terminals	for printed circuit
Switching power	max. 5 VA, Ag plated	Contact material	silver plated copper alloy
Steady current at 20°C ambient temperature	3 A	Insulation material	plastic
Operating life at maximum power	$\geq 15 \text{ 000 cycles}$	Spindle	plastic, L = 6 or 20 mm (Standard)
Operating life no load	$\geq 20 \text{ 000 cycles}$	Switching combinations (see page 2)	1 x 2 to 1 x 12; 2 x 2 to 2 x 6 3 x 2 to 3 x 4; 4 x 2 to 4 x 3; 6 x 2
Capacity between two contacts	$\leq 3 \text{ p F}$		

This catalogue gives no information on product availability. The information is only for product description and is not legally binding. Any technical item is subject to change.