



Solid State Devices, Inc.

14701 Firestone Blvd * La Mirada, Ca 90638
Phone: (562) 404-4474 * Fax: (562) 404-1773
ssdi@ssdi-power.com * www.ssdi-power.com

Designer's Data Sheet

Part Number/Ordering Information ^{1/}

SDAD10 2

Screening ^{2/}

— = Not Screened
TX = TX Level
TXV = TXV Level
S = S Level

Reverse Recovery Time

UF = Ultra Fast Recovery Time

Voltage 2.5 = 2.5kV, 5 = 5kV,
7.5 = 7.5kV, 10 = 10kV, and 15 =
15kV

Power Rating (See Below)

Package Size = 2 Inches Diameter

SDAD102 UF Series

2,500 to 15,000 VOLTS ULTRA FAST RECOVERY STACKABLE HIGH VOLTAGE RECTIFIER

FEATURES:

- Stackable to 600 kV+
- PIV 2.5kV to 15kV
- High Current Ratings
- Ultra Fast Reverse Recovery Time
- Only Hermetically Sealed Rectifiers Used
- Controlled Avalanche Rated
- Modular Design for Easy Stacking
- Storage and Operating Temps -65°C to +150°C
- Available in Standard, Fast and Hyper Fast Versions
- TX, TXV, and S-Level Screening Available ^{2/}

ELECTRICAL CHARACTERISTICS ^{3/}

Part Number	Peak Inverse Voltage	Reverse Recovery Time ^{5/}	Average DC Output Current ^{4/} Tc = Case Temperature			Surge Non-repetitive	Maximum Forward Voltage Drop		Maximum Leakage Current @ PIV
	PIV (KV)	Max (ns)	If(avg)			Ifsm	Vf (V)	If (A)	Ir (uA)
	25 °C	25 °C	75 °C	50 °C	60 °C	100 °C	25 °C		25 °C
SDAD102 H 2.5 UF	2.5	70	9.00	10.6	10.0	200	4.35	6.3	30
SDAD102 H 5.0 UF	5.0	70	6.60	8.80	8.00	200	7.92	4.5	30
SDAD102 H 7.5 UF	7.5	70	2.00	3.00	2.50	125	10.9	1.5	15
SDAD102 H 10 UF	10	70	1.50	2.00	1.80	100	13.6	1.2	15
SDAD102 H 15 UF	15	70	1.00	1.40	1.20	100	18.9	0.7	15

SDAD102 Package:

NOTES:

- ^{1/} For Ordering Information, Price, Curves, and Availability- Contact Factory.
- ^{2/} Screening based on MIL-PRF-19500. Screening flows available on request.
- ^{3/} Unless Otherwise Specified, All Electrical Characteristics @25°C.
- ^{4/} Tc = 50 °C typical operation in oil.
Tc = 75 °C is typical ambient Ta = 25 °C unheatsunk.
Tc = 60 °C typical operation with extender plates in air.
- ^{5/} Recovery Conditions: If = 0.5 Amp, Ir = 1.0 Amp rec. to .25 Amp.

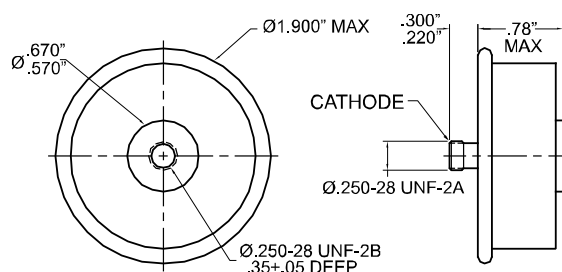

NOTE: All specifications are subject to change without notification.
SCD's for these devices should be reviewed by SSDI prior to release.

DATA SHEET #: RA0087B

DOC