

CUSTOMER DRAWING

P/N: 3800S 57A/-1L REV B

PART NUMBER	MATERIAL	FINISH
3800S 57A-1L	.016 THICK BRASS	PRETINNED
3800S 57AB-1L	.016 THICK BRASS	NONE

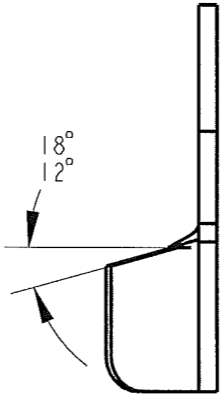
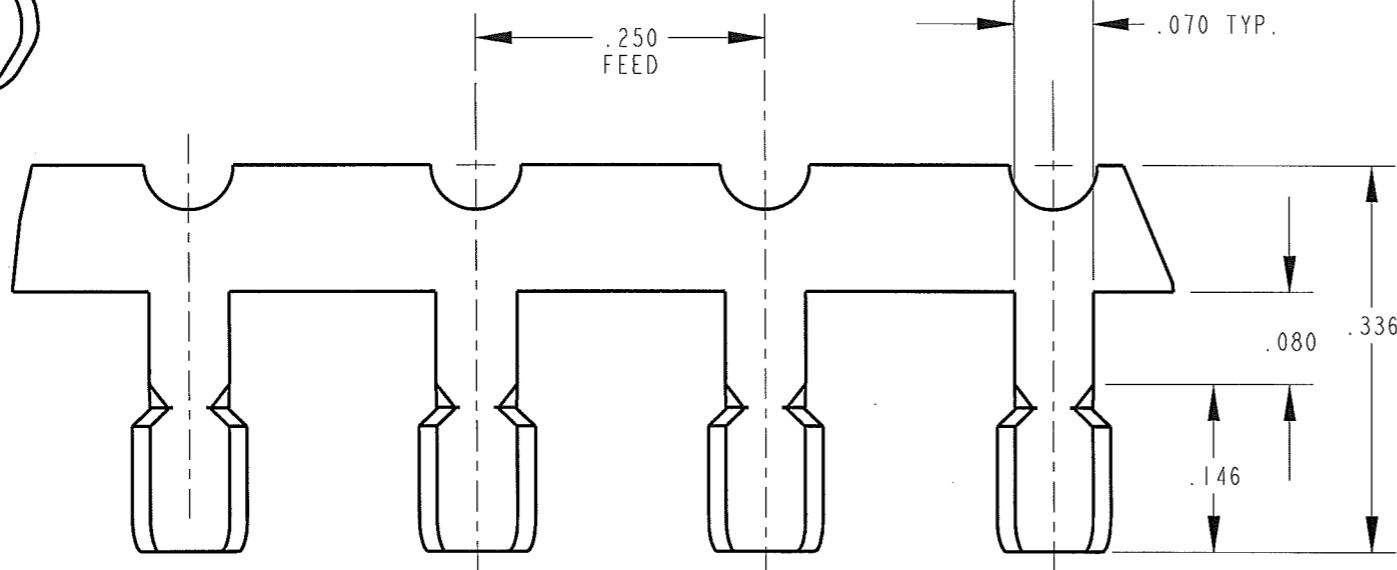
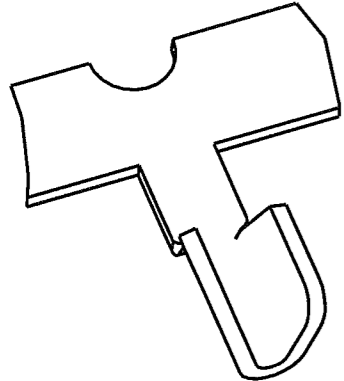

- NOTES:
1. CMA RANGE: 400-1030
 2. FOR PIGTAIL SPLICE USED IN BENCH APPLICATOR ADD SUFFIX "PP" TO PART NUMBER (I.E. 3800S 57A-1LPP), SEE FIGURE 1 FOR REELING.
 3. FOR THROUGH SPLICES USED IN A BENCH APPLICATOR SEE FIGURE 2 FOR REELING.
 4. FOR PIGTAIL AND THROUGH SPLICES USED IN A SLIM-LINE AIR PRESS, SEE FIGURE 2 FOR REELING.
 5. SPLICES TO BE INTERLEAVED WITH .007 THICK KRAFT PAPER.

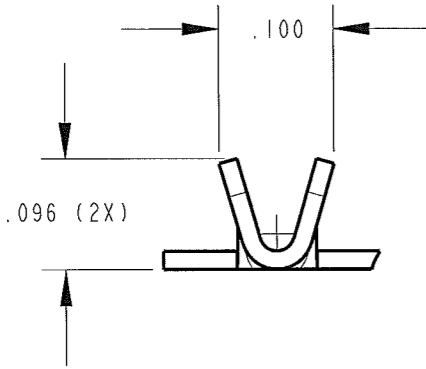

ARK-LES UNCONTROLLED

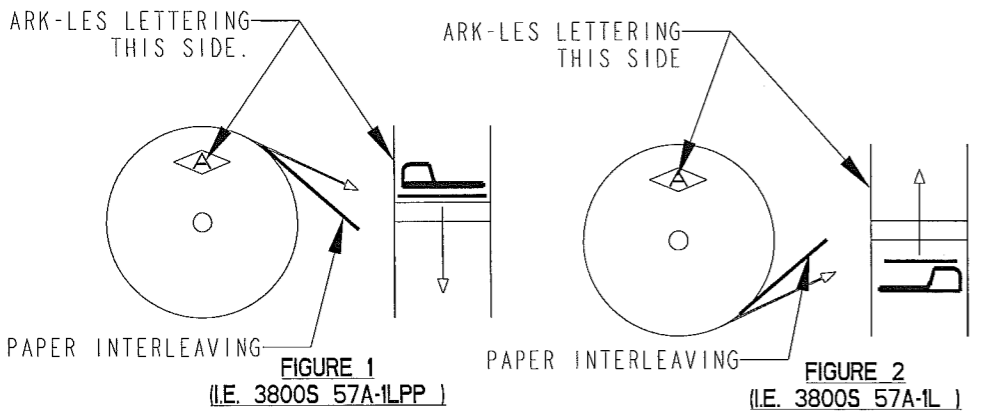

PROD. REL.	ECR#11966	2/4/00	CHK'D	TOLERANCES UNLESS OTHERWISE SPECIFIED	 CORPORATION STOUGHTON, MA
QUOTE REL.			20/1/00	DECIMALS ±.010	
DEPT #			DRAWN BY D.O'NEILL 8/16/05	APP.	ORIGINAL IF RED
ENG X			SUPERSEDES DWG. DATED: 2/4/00	ET 11-17-00	PART NAME CUSTOMER DRAWING SPLICE TERMINAL
SALES			SCALE 6:1	DO NOT SCALE PRINT	CAD#: 3800S_57A-1L-REVB_CUST
STO X			MATERIAL: SEE TABLE		P/N: 3800S 57A/-1L
REV B	REV/REDRWN ECR# S000127	11/02/06	DON	FINISH: SEE TABLE	REV B
DESCRIPTION		DATE	DR.	3RD ANGLE PROJECTION DWG SIZE B	