

## Diffuse sensors with intensity difference

## OZDK 10P5150/S35A

### dimension drawing

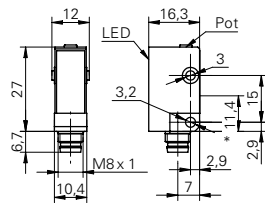

\* emitter axis

### general data

type	intensity difference
version	line beam
light source	pulsed red laser diode
sensing distance Tw	3 ... 150 mm
optimum operating distance	35 ... 45 mm
repeat accuracy	< 0,2 mm at laser focus
power on indication	LED green
light indicator	LED yellow
sensitivity adjustment	potentiometer, 5 turn
laser class	1
distance to focus	40 mm
wave length	650 nm

### electrical data

response time / release time	< 0,05 ms
voltage supply range +Vs	10 ... 30 VDC
current consumption max. (no load)	50 mA
current consumption typ.	40 mA
voltage drop Vd	< 1,8 VDC
output function	light / dark operate
output circuit	PNP
output current	< 100 mA
short circuit protection	yes
reverse polarity protection	yes

### mechanical data

width / diameter	10,4 mm
height / length	27 mm
depth	16,3 mm
type	rectangular
housing material	plastic (ASA)
front (optics)	PMMA
connection types	connector M8 4 pin

### ambient conditions

operating temperature	-10 ... +50 °C
protection class	IP 67

### photo



### connection diagram

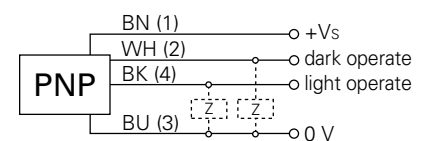

### laser warning

**CLASS 1 LASER  
PRODUCT**

Complies with 21 CFR 1040.10 and 1040.11  
except for deviations pursuant to laser  
notice No. 50, dated June 24, 2007

