

10.2
INSERTION DEPTH

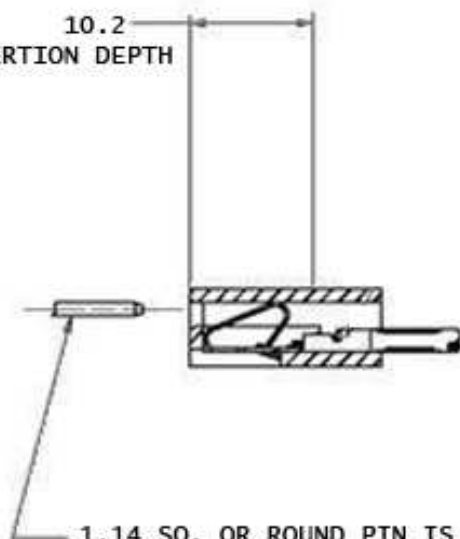

1.14 SO. OR ROUND PIN IS STANDARD.
HOUSING WILL ACCEPT PIN SIZES FROM
.511 TO 1.57.

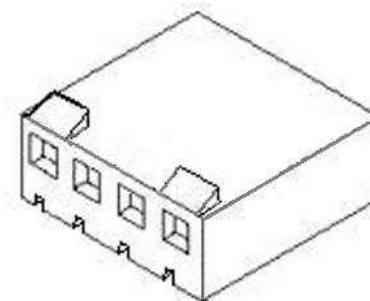
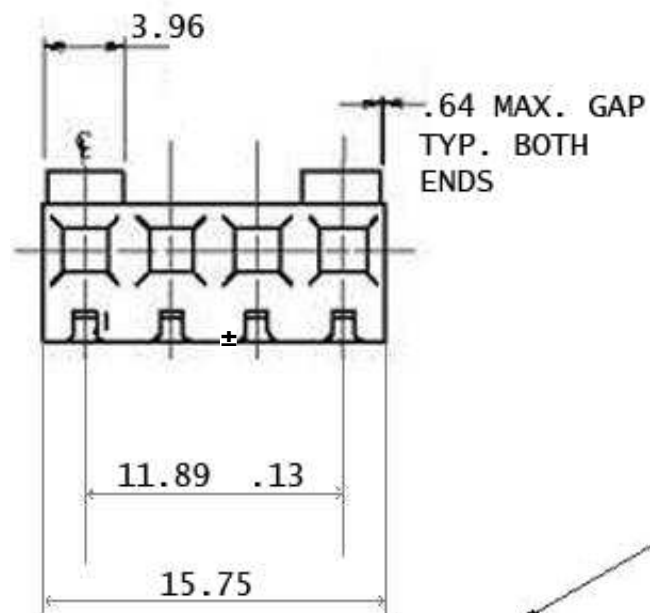

REV	DESCRIPTION	DATE	BY
A			
B			

PART NO.	MOL: 09-50-3041
DATE	02.14.12
APPROVAL	EB
UNIT	mm
REV	0

PART TITLE	4 Pin Molex W/ Locking Ramp, .156" Center
---------------	--



CONDOR ELECTRONICS, INC.
T: 408-745-7141 F: 408-745-0439
780 Montague Expy. Ste. 406
San Jose, CA 95131 USA
sales@condorelectronics.net