

ARP300

- ✓ Heat sink for insulated modules
- ✓ Weight : 28,4 Kg/m
- ✓ Application : natural cooling
- ✓ Plating : contact us
- ✓ Available length on stock : 3000 mm
- ✓ Machining and assemblies on request

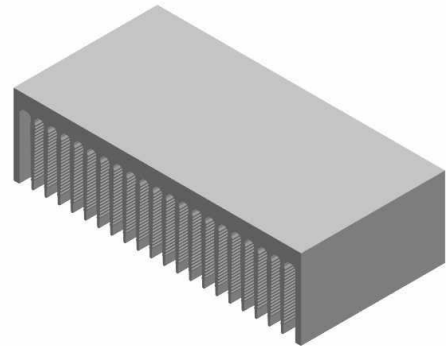

Dimensions

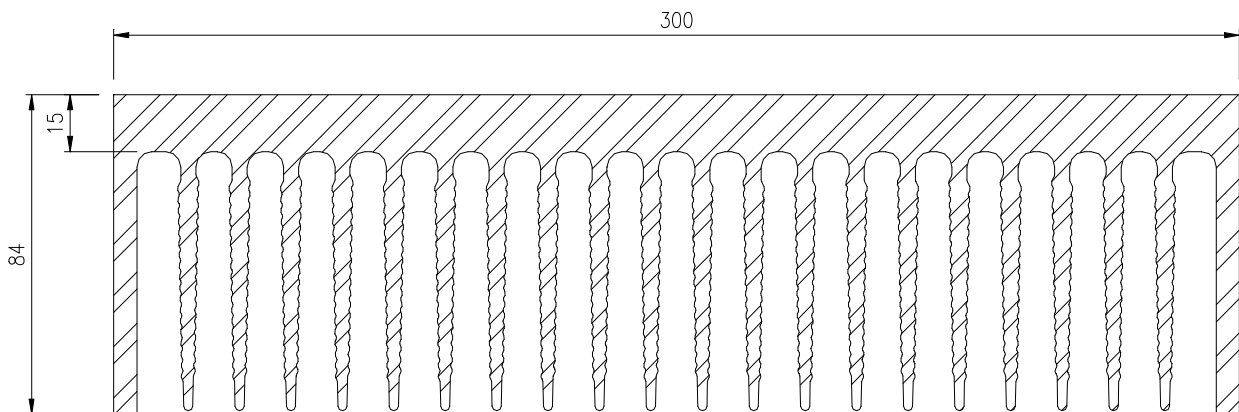

Approximate scale : 1/2.

NATURAL CONVECTION

Thermal Resistance

RTH ARP300 NATURAL CONVECTION

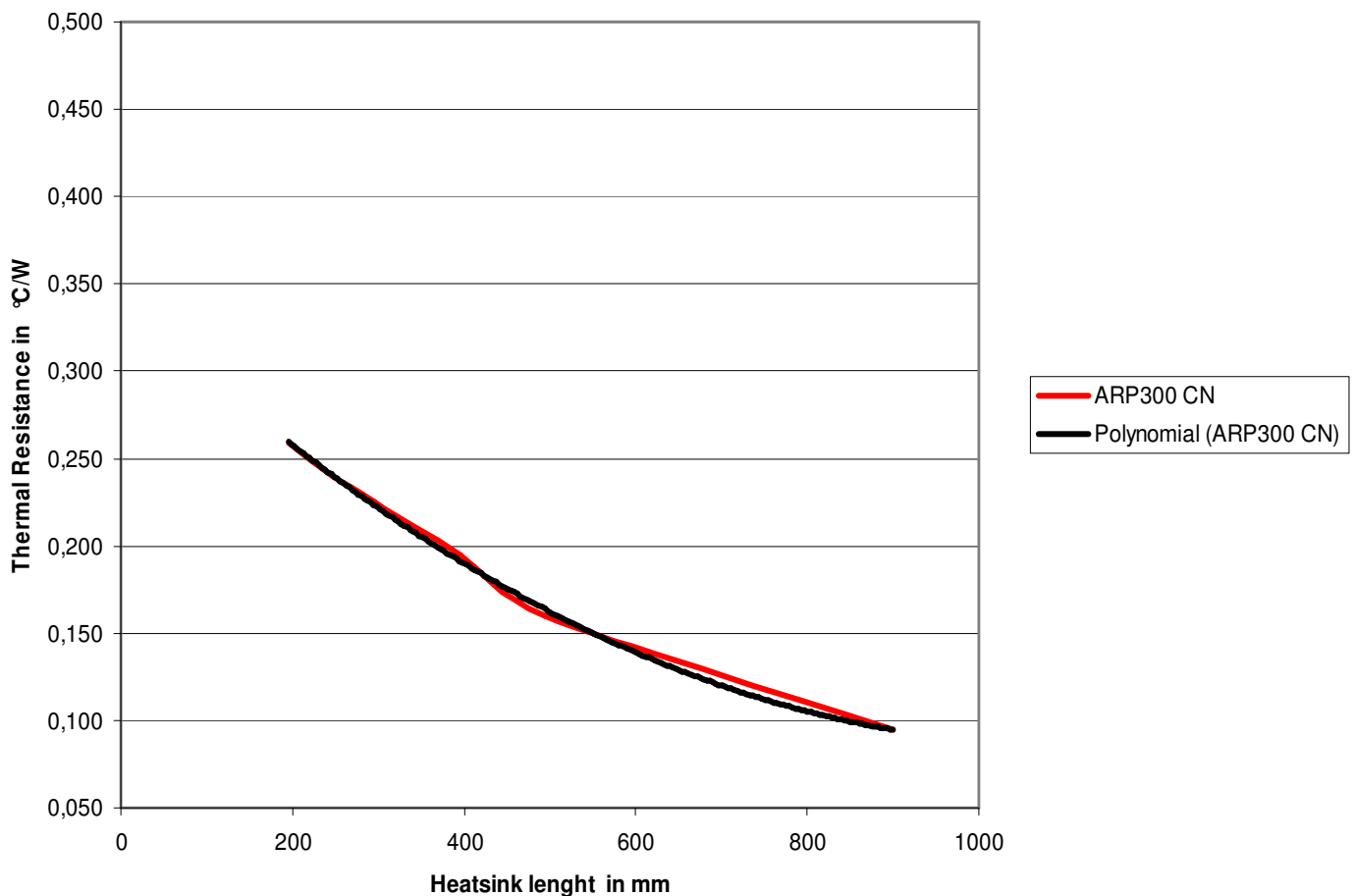

Standardized Thermal Impédance

ARP300 (mm)	195	245	295	395	495	900
Rth (°C/W)	0.259	0.24	0.225	0.195	0.16	0.095
A (s)	300	400	500	600	700	750
B (s)	1650	1800	1900	2000	2100	2200
τ_1	0.1	0.1	0.1	0.1	0.1	0.1

FORCED AIR

Screw Fan 250mm

ARP300 FA

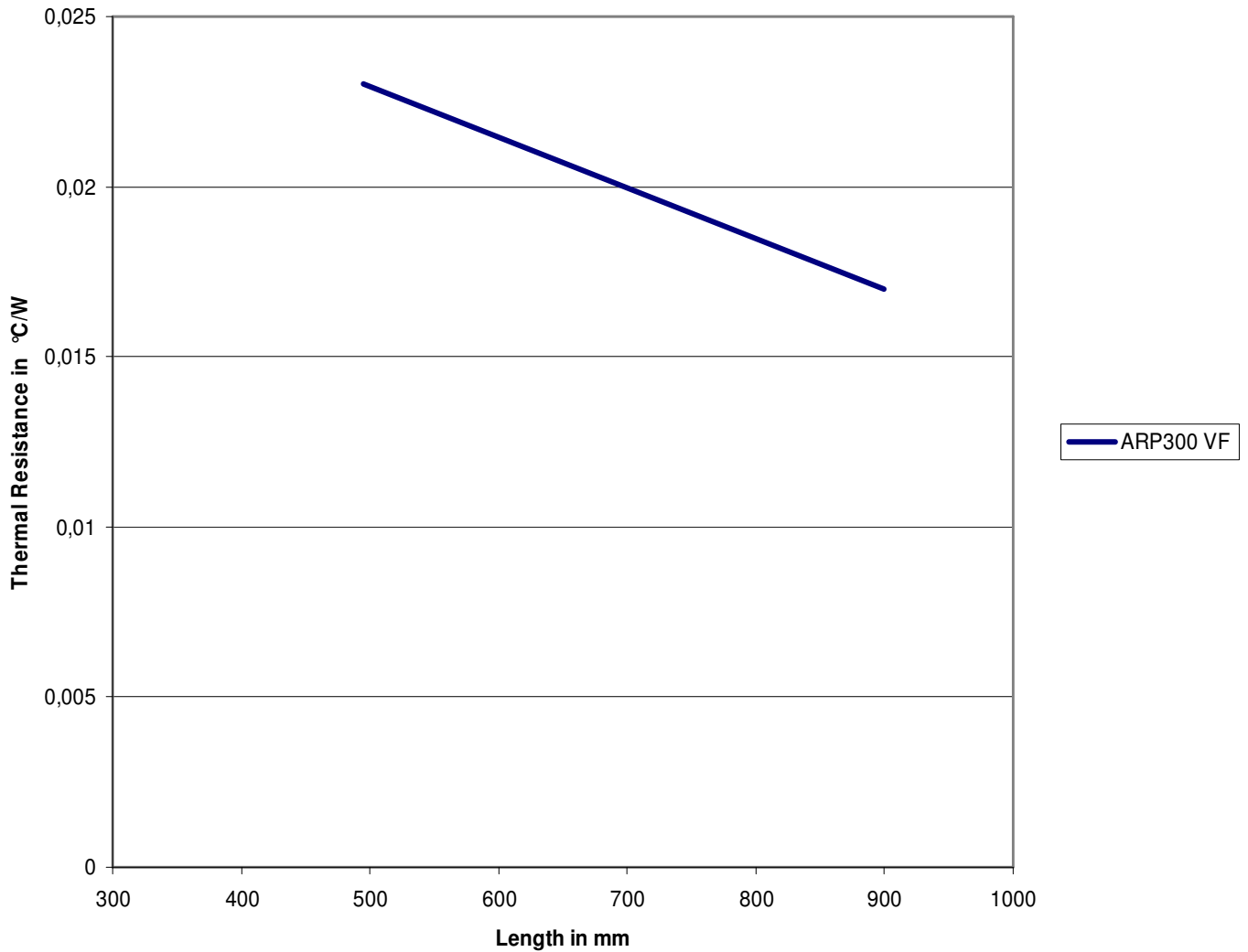

Cross-flow fan 50l/min

ARP300 VF

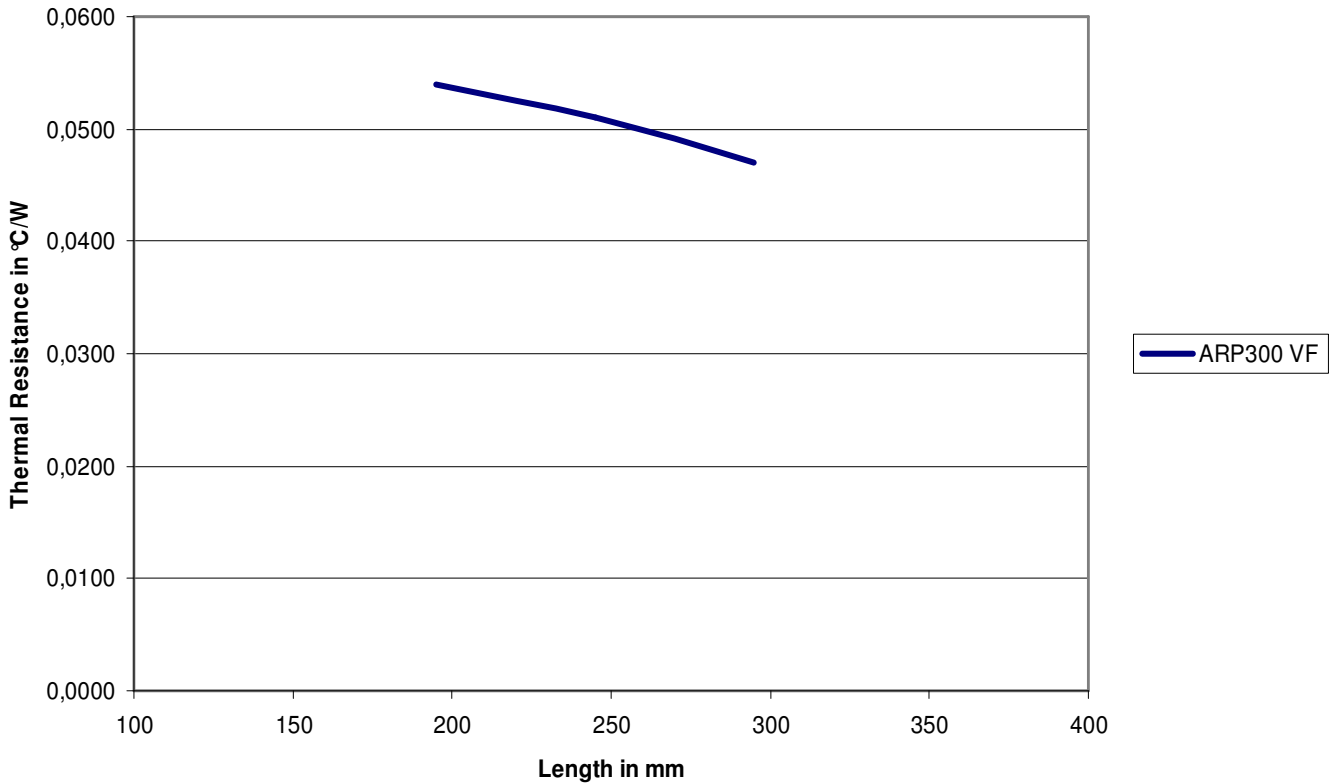

ARP300 (mm)	195	245	295
Rth (°C/W)	0.054	0.051	0.047
A (s)	25	25	
B (s)	270	270	
$\tau 1$	0.2	0.2	0.2
$\tau 2$	0.8	0.8	0.8

CAUTION :

ARCEL reserves the right to make modifications to its technical data and product specifications at any time without prior notice. Thermal resistances are given as information. Thermal resistance depend on several parameters, thus exact value of thermal resistance can only be determined by direct measurement for the given configuration.

For more information :

ARCEL
2, rue des Aulnes
Z.I. du Tronchon
F-69410 Champagne-au-Mont-d'Or

☎ +33 478 350 221
Fax : +33 478 356 954
Email : info@arcel.fr