

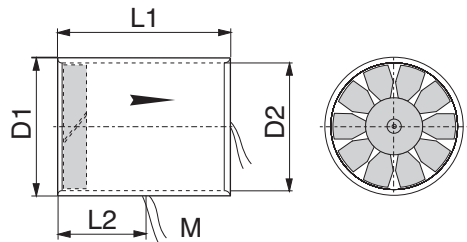

Axiallüfter
Axial Fans
Ventilateur axial

D241L/Q



D243L/Q

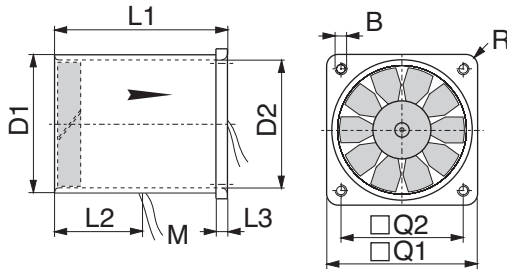

D244L/Q

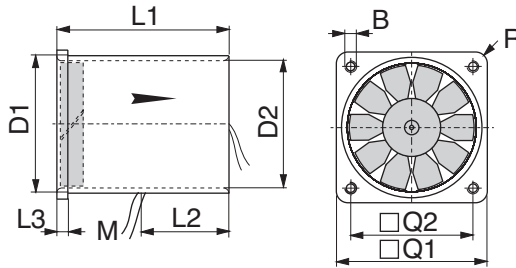

D244Q

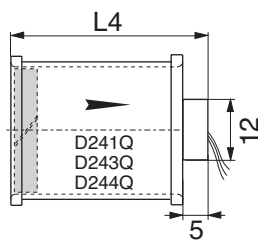

Q-Version mit vorstehendem Motor
Q-Version with extended motor
Q-version avec moteur saillant

D241L, D243L, D244L 6 V DC

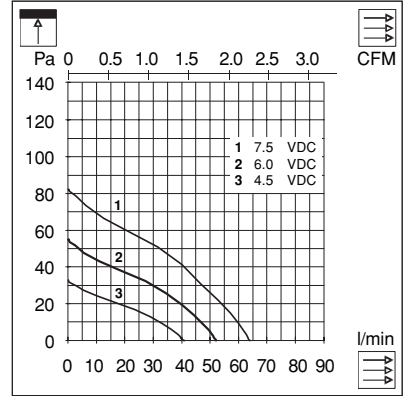

D241L, D243L, D244L 12 V DC

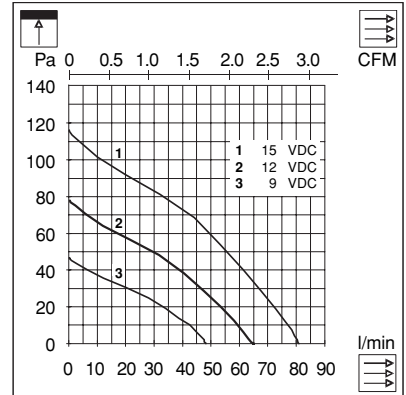

D241Q, D243Q, D244Q 12 V DC

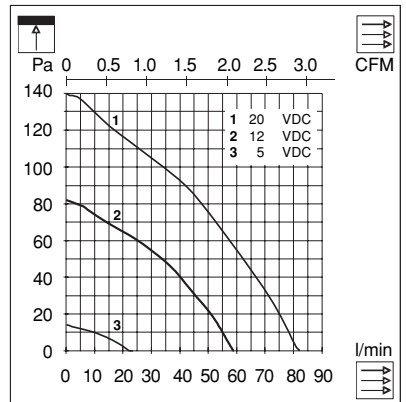

| D240 | mm | inch |
|------|-----|-------|
| D1 | 24 | 0.945 |
| D2 | 22 | 0.866 |
| L1 | 30 | 1.181 |
| L2 | 15 | 0.590 |
| L3 | 3 | 0.118 |
| L4 | 35 | 1.380 |
| B | 2.6 | 0.102 |
| Q1 | 28 | 1.102 |
| Q2 | 22 | 0.866 |
| R | 2 | 0.079 |



Technische Daten

Technical data

Caractéristiques techniques

Die D240Q-Baureihe ist mit einem bürstenlosen Motor und einem externen Elektronikmodul (3 Litzenversion; + Vcc, Gnd, Tachosignal) ausgerüstet

- sehr lange Laufzeit
- Spannungsbereich 5 – 24 V DC
- Tachosignal
- Strombegrenzung

Option: 10 Litzen Ausgang mit weiteren Funktionen

The serie D240Q ist equipped with a brushless motor, and an external electronic modul (3 leadsversion; + Vcc, Gnd, tachosignal)

- Long life
- voltage range 5 – 24 V DC
- tacho signal
- current limitation

Option: 10 leads-version with further functions

La série D240Q est équipée d'un moteur "brushless" avec module électronique externe, (3 filsversion; + Vcc, Gnd, tachosignal)

- Usage longue vie
- gamme de tension 5 – 24 V DC
- signal tacho
- limite de courant

Option: version 10 fils avec fonctions supplémentaires

| Types | | | D241L/D243L/D244L | | D241Q/D243Q/D244Q | |
|-------------|-----------------------|-------------------|-----------------------|-----------|-----------------------|--|
| U | U _N | V | 6 | 12 | 12 | |
| | U | V | 4.5...7.5 | 9...15 | 5...24 | |
| I | I _N | mA | 32 | 22 | 48 | |
| | I _{max} | mA | 40 | 28 | 60 | |
| O | I _{block} | A | 0.22 | 0.14 | 0.98 | |
| P | P _N | W | 0.19 | 0.26 | 0.58 | |
| | n | min ⁻¹ | 12'100 | 14'400 | 14'600 | |
| | ∇ | l/min; CFM | 50/1.77 | 60/2.12 | 61/2.15 | |
| | p | Pa | 52 | 75 | 84 | |
| | LpA | dB(A) | 33 | 38 | 40 | |
| MTTF | MTTF | hr | 4'000 | | 25'000 | |
| | T | °C/F | -20...+65 / -5...+150 | | -20...+65 / -5...+150 | |
| | m | g/oz. | 15/0.53 | | 23/0.81 | |
| | Lead Length | mm/inch | 200/7.87 (AWG 26) | | 220/8.66 (AWG 26) | |
| | Housing Material | | PPO UL-94V-1 | | PPO UL-94V-1 | |
| | Sleeve Bearing | | • | | - | |
| | Ball Bearing | | - | | • | |
| | Brushless Motor | | - | | • | |
| | Flat Finger Guard | | - | | - | |
| | Circular Finger Guard | | - | | - | |

Zusätzliche Funktionen 10 Litzen Version (R-Version)

- Analog Ausgang (variable Drehzahl)
- PLL (konstante Drehzahl)
- Stop-Funktion
- Richtungswechsel
- NOS
- Tachosignal

Additional Functions 10 Lead Version (R-Version)

- Analog output (variable speed)
- PLL (constant speed)
- Brake function
- Direction
- NOS
- Tacho signal

Fonctions supplémentaires version à 10 fils (R-version)

- PWM (vitesse variable)
- PLL (vitesse constant)
- Function stop
- Changer de direction
- NOS
- Signal tacho

Q-Version: bürstenloser Motor mit externer Elektronik
Q-Version: brushless motor with external electronics
Q-version: moteur sans brosse avec électronique extérieure

Connector
for 10 lead version

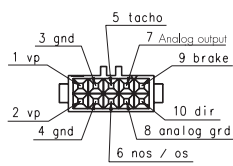

Typ: Tyco 23535-A3280-101

