

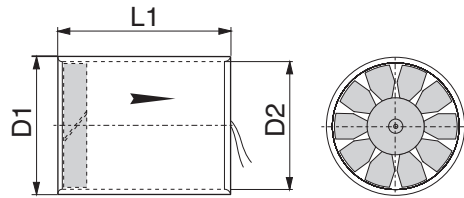

**Axiall fter**  
**Axial Fans**  
**Ventilateurs Axial**

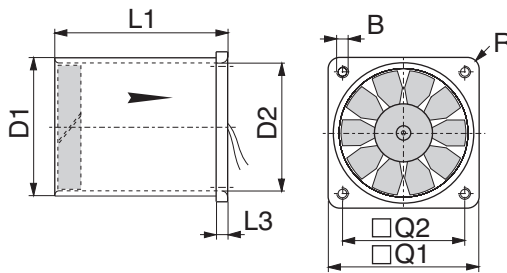

**D601T/Q**



**D603T/Q**

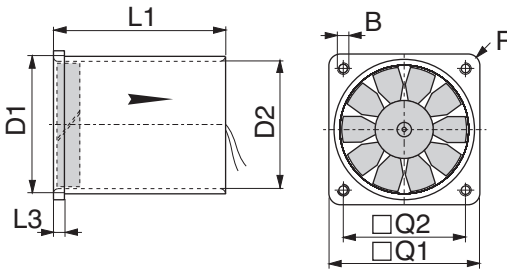

**D604T/Q**

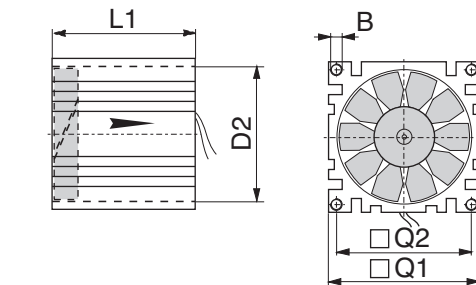

**D591T/Q**

**D591T, 601T, 603T, 604T 12 VDC**

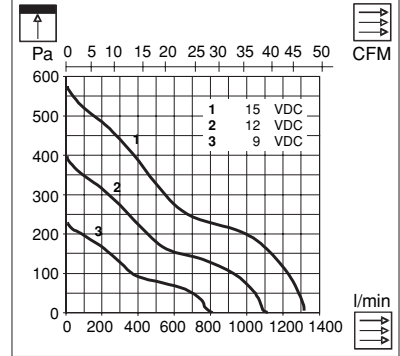

**D591T, 601T, 603T, 604T 24 VDC**

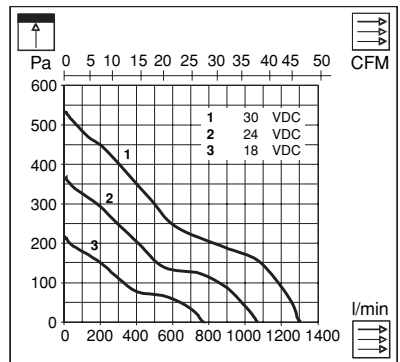

**D591Q, 601Q, 603Q, 604Q 12 VDC**

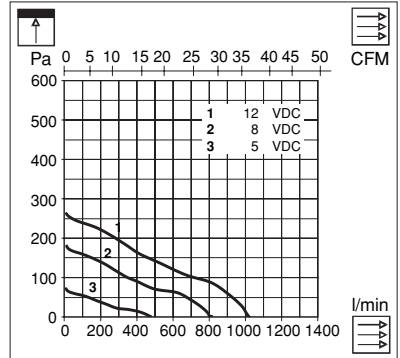

**D591Q, 601Q, 603Q, 604Q 24 VDC**

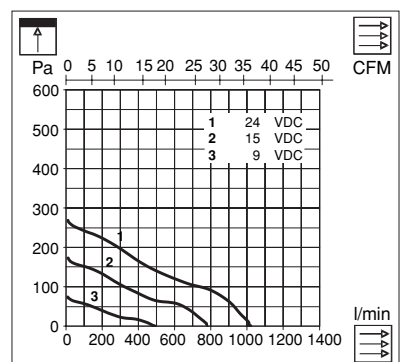

D591	mm	inch
D1		
D2	56.5	2.224
L1	60	2.362
L3		
B	M3	
Q1	62	2.441
Q2	50	1.968
R	0.3	0.012

D600	mm	inch
D1	60	2.362
D2	56.5	2.224
L1	60	2.362
L3	4	0.157
B	M3	
Q1	64	2.520
Q2	50	1.968
R	4	0.157

## Technische Daten

## Technical data

## Caractéristiques techniques

Die D600Q-Baureihe ist mit einem bürstenlosen Motor, mit integrierter Elektronik (3 Litzenversion; + Vcc, Gnd, Tachosignal) ausgerüstet

- sehr lange Laufzeit
- Spannungsbereich 5-15 VDC/9-30 VDC
- Tachosignal
- Strombegrenzung

Option: 10 Litzen Ausgang mit weiteren Funktionen

The serie D600Q is equipped with a brushless motor, with integrated electronic (3 leads version; + Vcc, Gnd, tachosignal)

- Long life
- voltage range 5-15 VDC/9-30 VDC
- tacho signal
- current limitation

Option: 10 leads-version with further functions

La série D600Q est équipée d'un moteur "brushless" avec électronique intégrée, (3 fils version; + Vcc, Gnd, tachosignal)

- Usage longue vie
- gamme de tension 5-15 VDC/9-30 VDC
- signal tacho
- limite de courant

Option: version 10 fils avec fonctions supplémentaires

Types			D591T/D601T/D603T/D604T		D591Q/D601Q/D603Q/D604Q	
<b>U</b>	U <sub>N</sub>	V	<b>12</b>	<b>24</b>	<b>12</b>	<b>24</b>
	U	V	9...15	18...30	5...15	9...30
<b>I</b>	I <sub>N</sub>	mA	557	231	635	315
	I <sub>max</sub>	mA	668	277	794	394
	I <sub>block</sub>	A	5.6	4.3	2.4	1.5
<b>P</b>	P <sub>N</sub>	W	6.68	5.54	7.62	7.56
	n	min <sup>-1</sup>	10'650	10'200	9'550	9'450
	∇	l/min; CFM	1'192/42.1	1'143/40.4	11'00/38.9	1'080/38.7
	p	Pa	395	366	266	268
	LpA	dB(A)	57	56	55	56
<b>MTTF</b>	MTTF	hr	10'000		40'000	
	T	°C/F	-20...+65 / -5...+150		-20...+65 / -5...+150	
	m	g/oz.	179/6.17		165/5.81	
	Lead Length	mm/inch	220/8.66 (AWG 24)		220/8.66 (AWG 26)	
	Housing Material		Aluminium		Aluminium	
	Sleeve Bearing		-		-	
	Ball Bearing		•		•	
	Brushless Motor		-		•	
	Flat Finger Guard		•		•	
	Circular Finger Guard		•		•	
	Explosion Protection		-		<b>i</b>	

### Zusätzliche Funktionen 10 Litzen Version (R-Version)

- Analog Ausgang (variable Drehzahl)
- PLL (konstante Drehzahl)
- Stop-Funktion
- Richtungswechsel
- NOS
- Tachosignal

### Additional Functions 10 Lead Version (R-Version)

- Analog output (variable speed)
- PWM (variable speed)
- PLL (constant speed)
- Brake function
- Direction
- NOS
- Tacho signal

### Fonctions supplémentaires version à 10 fils (R-version)

- PWM (vitesse variable)
- PLL (vitesse constant)
- Function stop
- Changer de direction
- NOS
- Signal tacho

Connector  
for 10 lead version

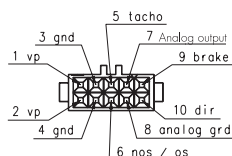

Typ: Tyco V23535-A3280-101